

Ground Floor
Floor area 33.2 m² (358 sq.ft.)

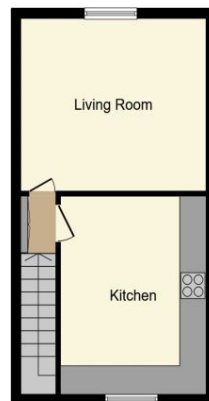

First Floor
Floor area 33.2 m² (358 sq.ft.)

TOTAL: 66.4 m² (715 sq.ft.)

This floor plan is for illustrative purposes only. It is not drawn to scale. Any measurements, floor areas (including any total floor area), openings and orientations are approximate. No details are guaranteed, they cannot be relied upon for any purpose and do not form any part of any agreement. No liability is taken for any error, omission or misstatement. A party must rely upon its own inspection(s). Powered by www.Propertybox.io



Harcourt Road
Redland, Bristol, BS6 7RQ

Rental £1,250 Monthly
2 Bedroom Maisonette
Available 26 April 2024

Clifton, 4a Waterloo St, Clifton, Bristol, BS8 4BT
Email: info@bradleyandco.agency | Tel: 0117 329 1400

Opening Times: Mon 09.00 - 17.30 | Tue 09.00 - 17.30 | Wed 09.00 - 17.30 | Thurs 09.00 - 17.30 | Fri 09.00 - 17.30 | Sat 09.00 - 12.30 | Sun 09.00 - 12.30

- * Unfurnished
- * Unfurnished
- * Suitable for single person
- * Electric Heating

- * Lovely Redland location
- * Split level

*

Situation

Great split level flat which allows for good access to both Whiteladies, Gloucester Roads & Henleaze. This 1st and 2nd/top floor maisonette is housed in a period building & situated in a quiet location within Redland/Westbury Park borders with some lovely independant shops locally. Offering one double and one single bedroom/home office, lounge with large window ensuring it is light & airy, modern kitchen with appliances, bathroom with shower over, suitable for professional single person or couple due to size of 2nd bedroom. Sorry no Sharers due to size of second bedroom. Council Tax Band B. EPC Band E. This property has all standard utilities provided to the property to include water and electric. No gas to the building. Holding fee £288 Available 26th April

Directions

Further Information

The deposit required is £1,442

Accommodation

All measurements are approximate.

