



**WHITLOCKS**  
ESTATE AGENTS

77 Hewarts Lane, Bognor Regis  
In Excess of £300,000



- Spacious Mid-Terraced House
- Three Generous Size Bedrooms
- Modern Fitted Kitchen
- Spacious Lounge / Dining Room
- Modern Fitted Bathroom and Cloakroom
- UPVC Double Glazing and Gas Central Heating Throughout
- Well Maintained Garden
- Garage Located in a Nearby Compound
- Close to Local Amenities
- Located in a Highly Sought-After Location

Council Tax band: C

Tenure: Freehold

EPC Energy Efficiency Rating: E

EPC Environmental Impact Rating: E







Whitlocks Estate Agents are delighted to present this deceptively spacious Mid-Terrace House offered to the market in a modern condition throughout and is located in a much sought-after area of Aldwick.

The property is arranged over two floors, on the ground floor there is a spacious Lounge / Dining Room, a modern fitted Kitchen with some integrated appliances that also has access to the rear Garden, and a Cloakroom.

On the first floor, three generous Bedrooms can be found as well as a modern fitted Bathroom.

Further benefits include UPVC Double Glazing and Gas Fired Central Heating throughout.

Outside to the rear, the mainly laid to lawn Garden offers easy maintenance and there is also a decking area proving the perfect space for outdoor dining.

To the front, the property has its own private Garden that is mainly laid to lawn and a path leading to the property.

Parking is available on a first-come-first-serve basis and there is a Garage located in a nearby compound.









Aldwick is an attractive, tranquil Village with royal connections and a stunning coastline. Aldwick offers many prestigious Privates Estates and Roads such Aldwick Bay Estate, Craigweil Private Estate, Aldwick Place, Aldwick Avenue and many others. Bognor's famous promenade starts at Aldwick Beach Huts and stretches all the way over to Felpham. Marine Park Gardens is also a point of interest and consist of a waterfront Park with a stunning array of well maintained flower displays, a fountain and a seasonal 18 hole putting green. The area also benefits from many notable waterfront Pubs and Restaurants. Within easy access to the popular Village of Rose Green as well as Aldwick Shopping Parade where a comprehensive variety of amenities can be found.

Whitlock Estate Agents Limited trading as Whitlocks Estate Agents for themselves and for the vendor or lessors of this property whose agents they are, give notice that (i) these particulars do not constitute any part of an offer or contract, (ii) all statements contained within these particulars are made without responsibility on the part of Whitlocks Estate Agents or the vendor, (iii) whilst made in good faith, none of the statements contained within these particulars are to be relied upon as a statement or representation of fact, (iv) any intending purchasers must satisfy themselves by inspection or otherwise as to the correctness of each of the statements contained within these particulars, (v) the vendor does not make or give either Whitlocks Estate Agents or any person in their employment any authority to make or give representation or warranty whatsoever in relation to this property. Wide angle lenses may be used.

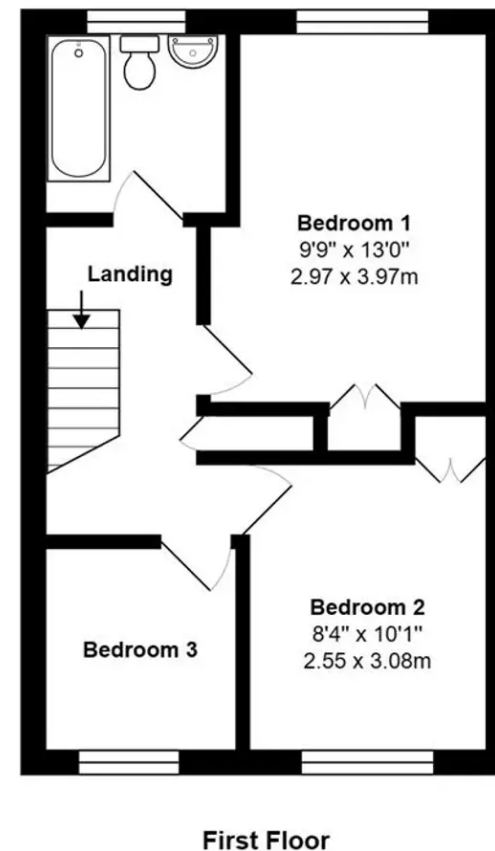
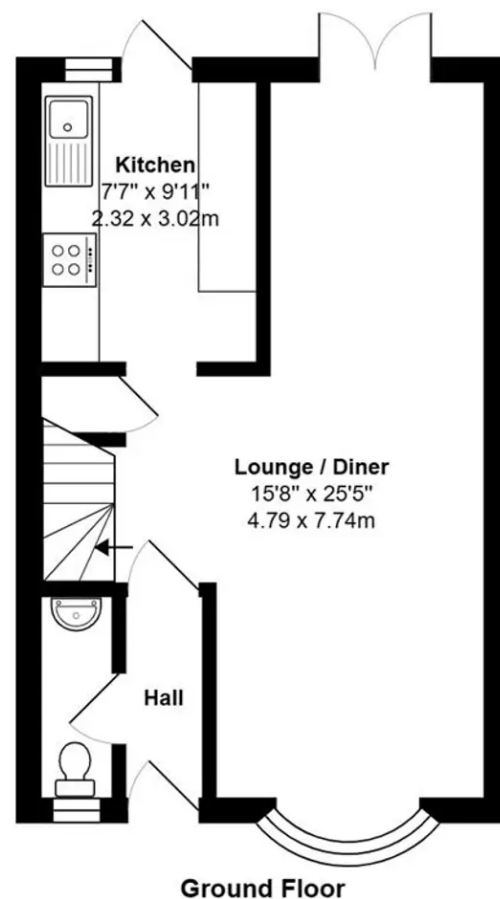

Total Area: 826 ft<sup>2</sup> ... 76.8 m<sup>2</sup>

Whilst every attempt has been made to ensure the accuracy of the floor plan contained here, measurements are approximate and no responsibility is taken for error, omission or mis-statement.

This plan is for illustrative purposes only and should be used as such by any prospective purchaser.

Created by Jtm 2023





## Whitlocks Estate Agents - Bognor Regis & Pagham

Whitlocks Estate Agents, 229 Pagham Road - PO21 3QD

01243 262747 • [sales@whitlocksestateagents.co.uk](mailto:sales@whitlocksestateagents.co.uk) • [whitlocksestateagents.co.uk/](http://whitlocksestateagents.co.uk/)