



High Street North | Stewkley | Leighton Buzzard | LU7 0EX  
Asking Price £1,075,000

High Street North | Stewkley  
Leighton Buzzard | LU7 0EX  
Asking Price £1,075,000

Fine Homes Property are excited to present a superb opportunity to move to a 2500 square foot detached home in the heart of Stewkley enjoying a half acre plot. The principal house is home to five bedrooms, two bathrooms and a wealth of sociable living space, while across the driveway you have an entirely self-contained beautiful annexe with another bedroom, bathroom and kitchen/diner with vaulted ceiling and log burner. Approximately half an acre of mature garden to the rear completes the property, backing onto nothing but Buckinghamshire countryside.

- Beautifully presented 5 bedroom detached period home.
- Extensive south facing mature gardens of about 1/2 an acre.
- 33ft kitchen/diner.
- Main house dates from 19th century with later additions.
- Outstanding detached one bedroom self-contained annexe.
- Backs onto and overlooks farmland.
- 21ft sitting room and separate reception room.
- Approx. 2500 square feet.
- 13 minute drive to Leighton Buzzard train station.
- In midst of popular Bucks village with access to grammar schools.



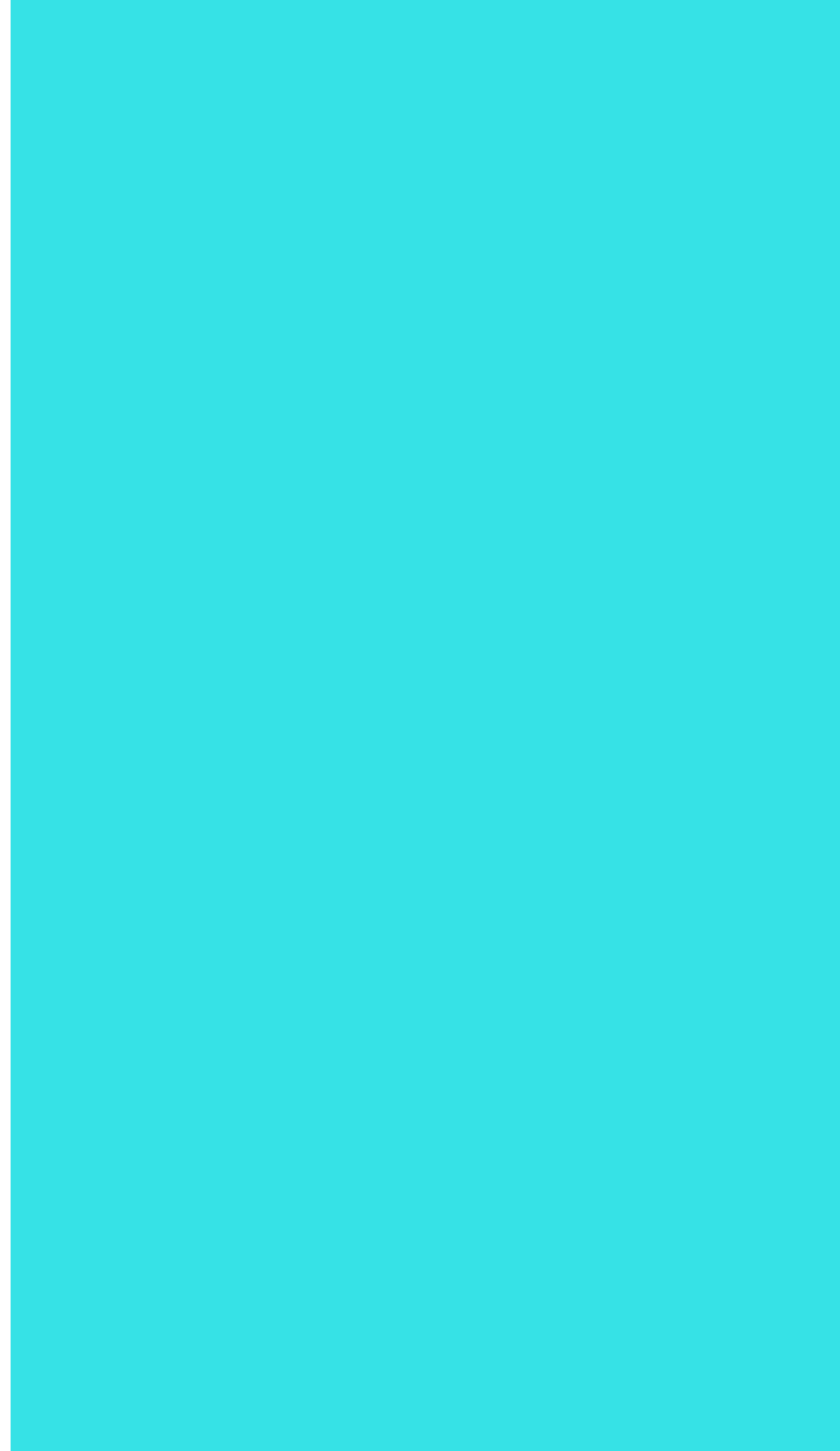

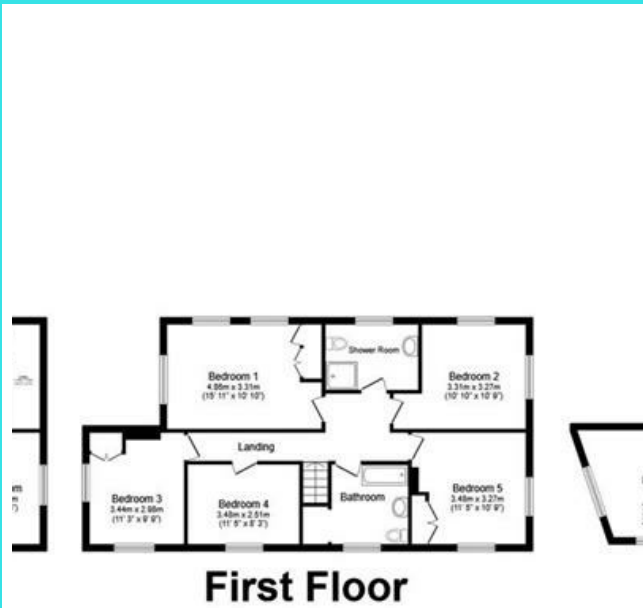
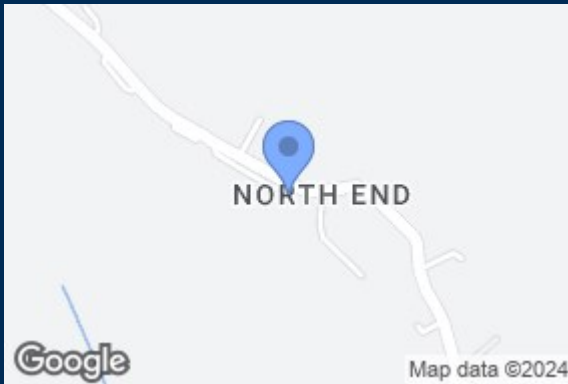
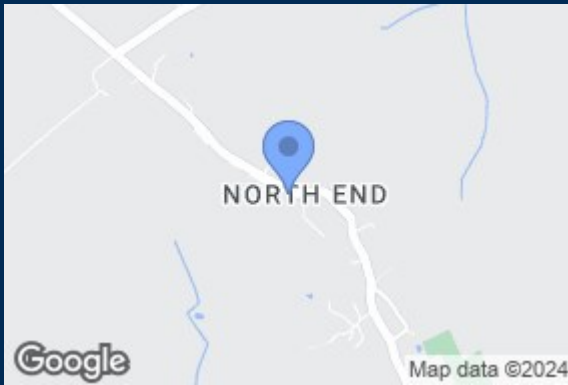

pprox  
 s only. It is not drawn to scale. Any measurements, floor ar  
 te. No details are guaranteed, they cannot be relied upon  
 en for any error, omission or misstatement. A party must r

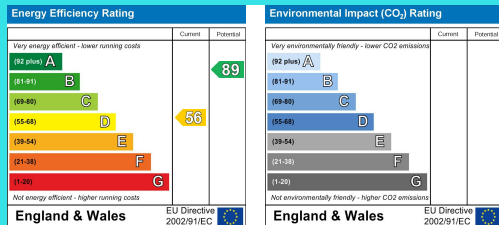

Duck End  
 Great Brickhill  
 Buckinghamshire  
 MK17 9AP  
 01525 261100  
 enquiries@finehomesnroperty.co.uk