



Chiltern Gardens | | Leighton Buzzard | LU7 3BL

Offers In Excess Of
£180,000

Chiltern Gardens | Leighton Buzzard | LU7 3BL Offers In Excess Of £480,000

A four bedroom detached home off of Heath Road within walking distance of Stockgrove country park and enjoying a south facing rear garden, garage and carport as well as no upper chain. Inside, you have three reception rooms, a well fitted kitchen and cloakroom. Upstairs there are four generous bedrooms and the family bathroom. With excellent schools nearby and in Leighton Buzzard, there is a great range of shops, cafes, restaurants and fast rail links to London Euston.

- Four bedroom detached family home.
- Large south facing rear garden.
- Sitting room, dining room and conservatory.
- Four generous bedrooms.
- 10 min walk to Leighton Buzzard Golf Club.
- Sought after position off of Heath Road.
- Walking distance of Stockgrove country park.
- Single garage and carport.
- 5 minute drive to Leighton Buzzard and 10 min drive to the train station.
- No upper chain.





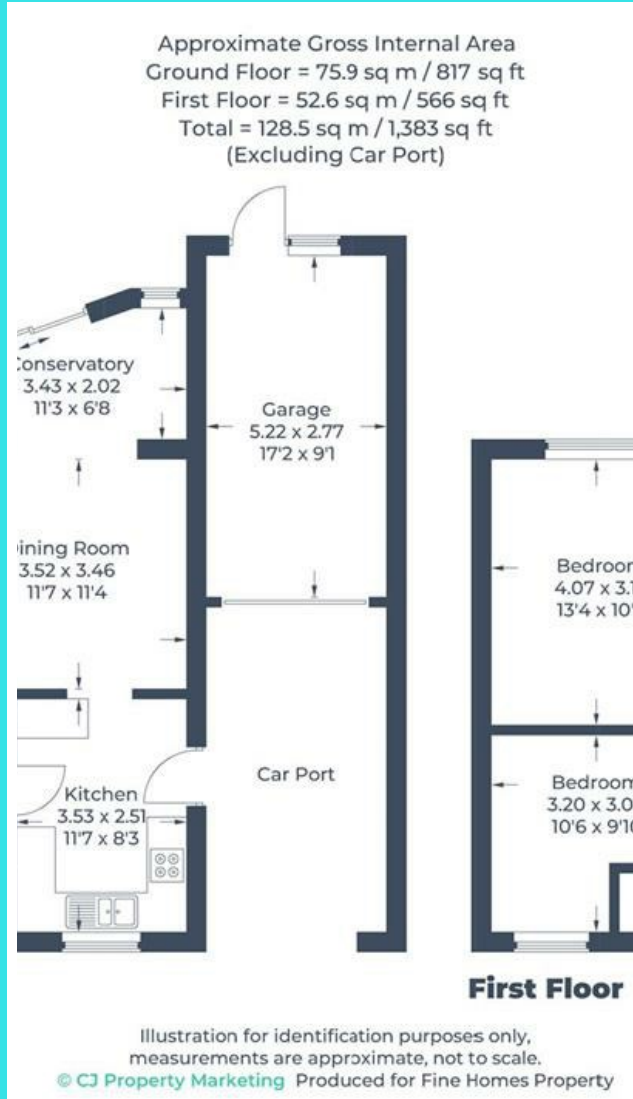
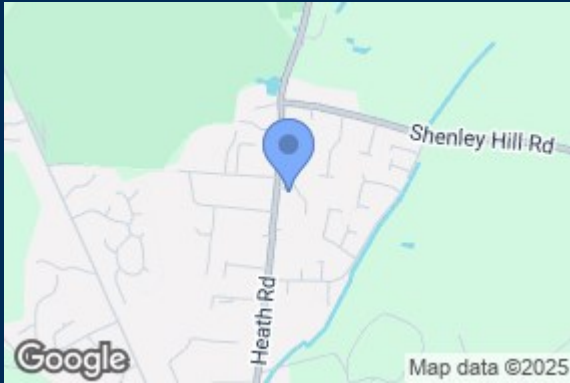

Energy Efficiency Rating		Environmental Impact (CO ₂) Rating	
Current	Potential	Current	Potential
Very energy efficient - lower running costs (92-100) A (81-91) B (69-80) C (55-68) D (39-54) E (21-38) F (1-20) G Not energy efficient - higher running costs		Very environmentally friendly - lower CO ₂ emissions (92-100) A (81-91) B (69-80) C (55-68) D (39-54) E (21-38) F (1-20) G Not environmentally friendly - higher CO ₂ emissions	
	74		85
England & Wales		England & Wales	
EU Directive 2002/91/EC		EU Directive 2002/91/EC	

Duck End
 Great Brickhill
 Buckinghamshire
 MK17 9AP
 01525 261100
enquiries@finehomesproperty.co.uk