

£1,300 pcm

Maylands Drive, Sidcup, Kent, DA14 4BF



- **MODERN 1 BEDROOM 1ST FLOOR APARTMENT**
- **GAS CENTRAL HEATING & DOUBLE GLAZED WINDOWS**
- **SPACIOUS LIVING ROOM WITH JULIETTE BALCONY**
- **MODERN KITCHEN WITH APPLIANCES**
- **DOUBLE SIZE BEDROOM WITH WARDROBE**
- **MODERN BATHROOM WITH OVERBATH SHOWER**
- **1 X ALLOCATED PARKING SPACE**
- **AVAILABLE END OF JULY**

To view all our homes: www.drewery.co.uk





MODERN 1 BEDROOM 1ST FLOOR APARTMENT: UNFURNISHED

A modern 1 bedroom 1st floor apartment. Situated in a residential location and close to all local amenities including: shops, schools, bus routes and within easy access of Albany Park mainline railway station.

The property benefits from gas central heating (new boiler installed June 2025), double glazed windows, video entry phone and allocated parking.

The accommodation comprises: Entrance hallway. Spacious living room with wood laminate flooring and windows to front opening to a Juliette balcony. Modern kitchen with a range of wall and base units, work surfaces, stainless steel sink with drainer, electric oven, gas hob, extractor, microwave, washing machine, dishwasher and fridge / freezer. Double size bedroom with carpet, wardrobe and window to front. Modern bathroom with hand basin, bath with overbath shower, heated towel rail and W.C. Externally there is 1 x allocated parking space.

Available end July.

Restrictions: no pets, smokers, children or students.

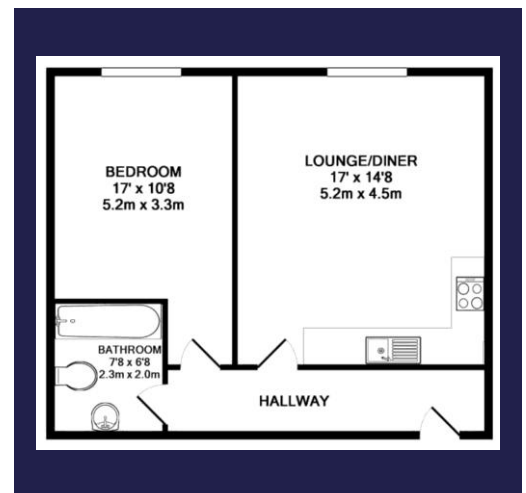

Energy Efficiency Rating B.
(84/84) EIR 0/0

If you would like to view please contact Drewery Property Consultants on **020 8269 6600**

These particulars are intended to give a fair description of the property but their accuracy cannot be guaranteed. Intending tenants should not rely on them as statements of representation of fact, but must satisfy themselves by inspection or otherwise as to their accuracy. All measurements quoted are approximate. None of the appliances/services have been tested by ourselves.

*Important - Admin fees apply per applicant. Please visit our website www.drewery.co.uk (information for tenants - Fees & other costs) or contact our staff.