



**Old Farm Road West**  
Sidcup  
DA15 8AG

**Freehold**

Offered for sale is this 3 bedroom terrace house that sits in a tree lined road just a short walk from Sidcup train station, local shops, coffee shops, restaurants and parks. Convenient for sought after schools including Burnt Oak Lane primary and Chislehurst and Sidcup Grammar School.

The house is well presented throughout and briefly comprises of: Entrance hall, downstairs w.c, front lounge, dining room with storage and doors opening onto the garden and kitchen. To the first floor there are 3 good sized bedrooms and a family bathroom.

Externally there is a lawned rear garden, and small front garden and there is a shared parking area to the rear of the property.



**Local Authority** Bexley London Borough  
Council  
**Council Tax Band D**  
**EPC Rating C**

Old Farm Road West, DA15  
Total area: Approx. 971 sq. feet (90.1 sq metres)

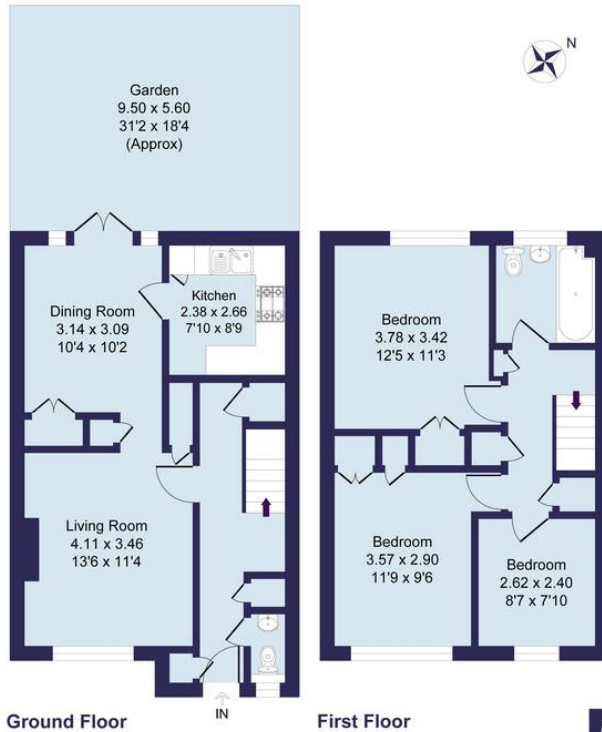

This plan is for layout guidance only. Not drawn to scale unless stated. Windows and door openings are approximate. Whilst every care is taken in the preparation of this plan, please check all dimensions, shapes and compass bearings before making any decisions reliant upon them.  
Produced By Planpix



**Drewery Property Consultants**  
128 Station Road  
Sidcup  
Kent  
DA15 7AF

**Contact**  
020 8269 6605  
info@drewery.co.uk  
www.drewery.co.uk

**Agents Note:** Whilst every care has been taken to prepare these particulars, they are for guidance purposes only. All measurements are approximate and are for general guidance purposes only and whilst every care has been taken to ensure their accuracy, they should not be relied upon and potential buyers/tenants are advised to recheck the measurements.

