



14 Kirkland Close, Sidcup, DA15 8TP
£1,100pcm



Kirkland Close

Sidcup, DA15 8TP

Recently Refurbished Studio Apartment With
Allocated Parking Close To Local Amenities

Main Features

- BRAND NEW KITCHEN
- RECENTLY REFURBISHED THROUGHOUT
- DOUBLE GLAZING
- ALLOCATED PARKING SPACE
- BRAND NEW SHOWER ROOM
- CLOSE TO LOCAL AMENITIES
- QUIET RESIDENTIAL LOCATION
- APPLIANCES INCLUDED

DESCRIPTION

Stunning studio apartment which has been recently refurbished throughout situated in a quiet residential close.

This fantastic studio is located within close proximity of Falconwood Station, motorway links, bus routes, local shops and parks. The studio itself briefly comprises of secure communal hall with entry phone system, spacious living area with new laminate flooring, brand new kitchen with appliances included and a brand new shower room. The property also benefits from an allocated parking space, double glazing, new electric heaters and new electrics.

Available Immediately. Restrictions: no pets, smokers or students. Would suit a single person on.

Council Tax Band - B (£1,676.14)
Rent - £1,110.00 Per Calendar Month
Security Deposit - £1,269.23
12 Month Tenancy

Communal entrance

Lounge

14' 8" x 10' 4" (4.47m x 3.15m)

Kitchen

8' 8" x 8' 5" (2.64m x 2.57m)

Shower room

6' 6" x 5' 9" (1.98m x 1.75m)

Outside

Allocated Parking Space

Score	Energy rating	Current	Potential
92+	A		
81-91	B		
69-80	C		
55-68	D	55 D	76 C
39-54	E		
21-38	F		
1-20	G		

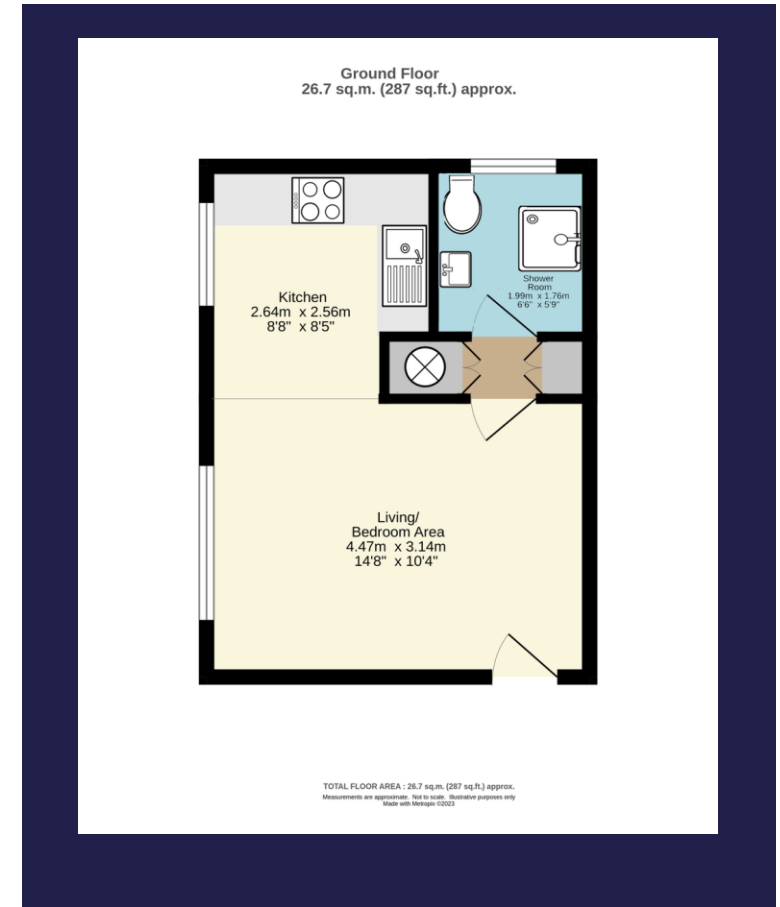

128, Station Road, Sidcup, DA15 7AF

Tel: 020 8269 6600

E: info@drewery.co.uk www.drewery.co.uk



These particulars are intended to give a fair description of the property but their accuracy cannot be guaranteed. Intending tenants should not rely on them as statements of representation of fact, but must satisfy themselves by inspection or otherwise as to their accuracy. All measurements quoted are approximate. None of the appliance/services have been tested by ourselves.

*Important – Admin fees apply per applicant. Please visit our website www.drewery.co.uk (information for tenants – Fees & other costs) or contact our staff.