



## Restons Crescent

New Eltham  
London  
SE9 2JF

### Leasehold

Offered for sale is this large, two bedroom third floor apartment with balcony that has been well presented by the current owners and is located within easy access of local shops, schools and transport links.

We feel this property could also make a good buy to let as Greenwich University Avery Hill campus is close by. The flat briefly comprises of: entrance hall, well presented lounge with access out onto a balcony, two large bedrooms, kitchen and bathroom with separate w.c. There is permit parking available close by.

**Local Authority** Greenwich London Borough  
Council  
**Council Tax Band** B  
**EPC Rating** C

**Lease** 91 years remaining  
**Service Charge** £2,191 per annum  
**Ground Rent** £10 per annum

## Thanington Court, Restons Crescent, London, SE9

Approximate Area = 959 sq ft / 89 sq m  
For identification only - Not to scale

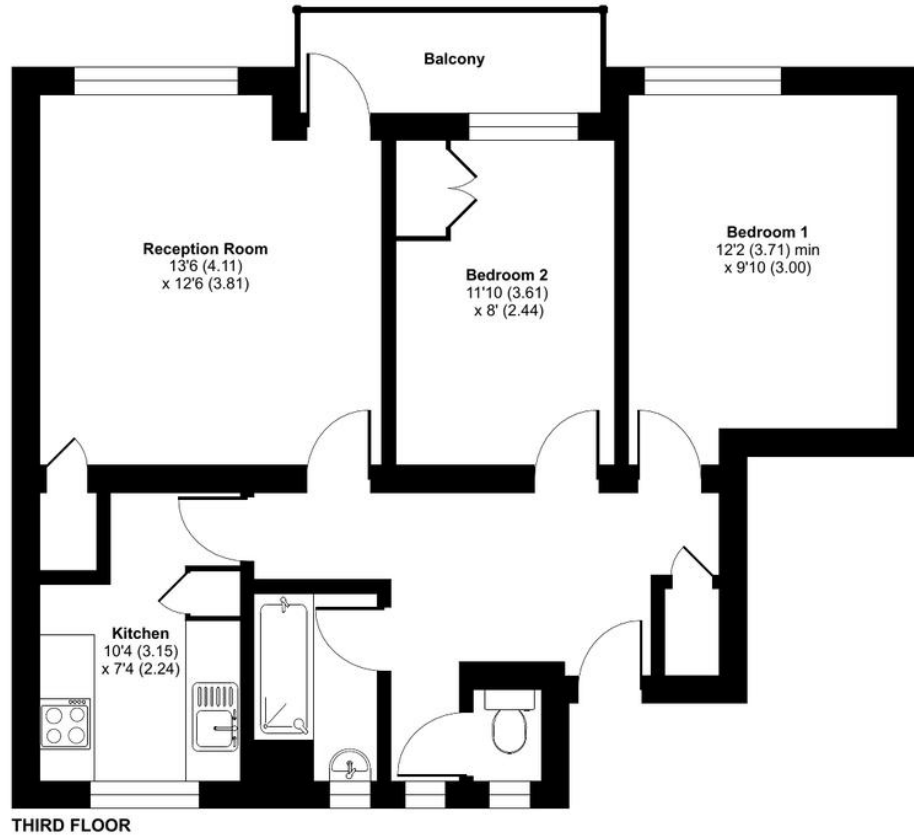

**Drewery Property Consultants**  
128 Station Road  
Sidcup  
Kent  
DA15 7AF

**Contact**  
020 8269 6605  
info@drewery.co.uk  
www.drewery.co.uk

**Agents Note:** Whilst every care has been taken to prepare these particulars, they are for guidance purposes only. All measurements are approximate and are for general guidance purposes only and whilst every care has been taken to ensure their accuracy, they should not be relied upon and potential buyers/tenants are advised to recheck the measurements.

