

£1,300 pcm

Hunters Lodge, Manor Road, Sidcup, Kent, DA15 7JT



- **SPACIOUS & WELL PRESENTED 1 BEDROOM 1ST FLOOR FLAT**
- **CLOSE TO ALL LOCAL AMENITIES**
- **ELECTRIC HEATING, DOUBLE GLAZED WINDOW & NEUTRAL DECOR**
- **SPACIOUS LOUNGE WITH WINDOW TO REAR**
- **MODERN KITCHEN WITH RANGE OF WALL & BASE UNITS**
- **DOUBLE SIZE BEDROOM WITH BUILT IN WARDROBE**
- **MODERN BATHROOM WITH OVERBATH SHOWER**
- **COMMUNAL GARDENS & ALLOCATED PARKING SPACE**

To view all our homes: www.drewery.co.uk





SPACIOUS & WELL PRESENTED 1 BEDROOM 1ST FLOOR FLAT: UNFURNISHED

A spacious and well presented 1 bedroom 1st floor flat. Situated in a popular residential location and close to all local amenities including: shops, high street, schools, local parks, bus routes and within walking distance of Sidcup mainline railway station.

The property benefits from electric heating, double glazed windows and a neutral décor throughout.

The accommodation comprises: Entrance hallway. Spacious lounge with window to rear. Modern kitchen with a range of wall and base units, work surfaces, stainless steel sink with drainer, newly installed cooker, spaces for washing machine and fridge / freezer. Double size bedroom with carpet and built in wardrobe. Modern bathroom with hand basin, bath with overbath shower and W.C. Externally there are communal gardens to the rear of the block. There is allocated parking for 1 x car.

Available immediately.

Restrictions: no pets, smokers or students.

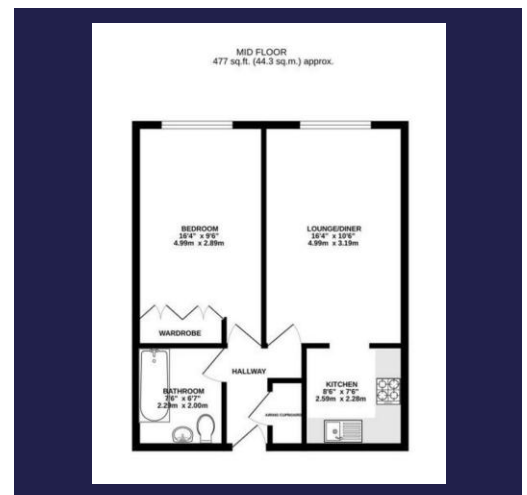

Energy Efficiency Rating C.
(71/83) EIR 0/0

If you would like to view please contact Drewery Property Consultants on **020 8269 6600**

These particulars are intended to give a fair description of the property but their accuracy cannot be guaranteed. Intending tenants should not rely on them as statements of representation of fact, but must satisfy themselves by inspection or otherwise as to their accuracy. All measurements quoted are approximate. None of the appliances/services have been tested by ourselves.

*Important - Admin fees apply per applicant. Please visit our website www.drewery.co.uk (information for tenants - Fees & other costs) or contact our staff.