



**Eaton Road**  
Sidcup  
DA14 4PE

**Freehold**

3 bedroom extended semi detached bungalow  
Garage & off street parking  
Open plan extended fitted kitchen/diner  
Conservatory  
Short walk to Albany Park station  
Convenient for shops and transport links  
Popular schools within easy reach







## FULL DESCRIPTION

This spacious and well-presented three-bedroom extended semi-detached bungalow is ideally located just a short walk from Albany Park Station, local shops, popular schools, and excellent transport links.

The property features an entrance hall leading to a bright and airy open-plan extended fitted kitchen, dining, and living area, with a separate conservatory offering additional living space. There are three well-proportioned bedrooms and a modern family bathroom.

Additional benefits include a garage and off-street parking.

## Directions

From our Sidcup office turn left into Station Road and under the railway bridge. At the traffic lights turn left into Faraday Avenue. At the end of the road turn right into Bexley Lane and immediate first left into Longmead Drive. Take the first turning on the right into Onslow Drive and take the second left into Eaton Road. Closest Stations: Albany Park (0.20 mi) Sidcup (0.86 mi) Bexley (1.14 mi) Closest Schools: Cleeve Park School (0.32 mi) Hurst Primary School (0.57 mi)





Local Authority  
Council Tax Band  
EPC Rating

Bexley London Borough Council  
E  
D

## Eaton Road, Sidcup, DA14

Approximate Area = 976 sq ft / 90.6 sq m  
For identification only - Not to scale

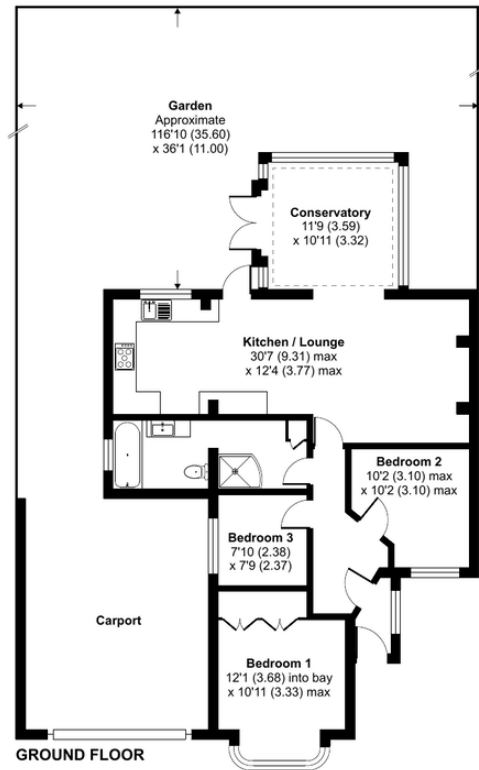

Floor plan produced in accordance with RICS Property Measurement 2nd Edition,  
Incorporating International Property Measurement Standards (IPMS2 Residential). © nitchecom 2024.  
Produced for Drewery. REF: 1317300

**Drewery Property Consultants**  
128 Station Road  
Sidcup  
Kent  
DA15 7AF

**Contact**  
020 8269 6605  
info@drewery.co.uk  
www.drewery.co.uk

**Agents Note:** Whilst every care has been taken to prepare these particulars, they are for guidance purposes only. All measurements are approximate and are for general guidance purposes only and whilst every care has been taken to ensure their accuracy, they should not be relied upon and potential buyers/tenants are advised to recheck the measurements.

