



**5 Cliff Mews Cliff Road, Paignton**

Paignton

Guide Price **£280,000**

ABSOLUTE





## 5 Cliff Mews Cliff Road

Paignton, Paignton

Immaculately presented Two/Three bedroom home in a secluded and desirable coastal location near harbour & beaches. Light & spacious accommodation over three floors with a modern kitchen and bathroom, cosy living area, level garden for al fresco dining & carport. Ideal for seaside lifestyle with potential as holiday home or rental property.

Council Tax band: C

Tenure: Freehold

EPC Energy Efficiency Rating: D

EPC Environmental Impact Rating: D

- Immaculately Presented Home Close to the Harbour and Beaches
- Two/Three Bedroom Coastal Home
- Positioned over Three Floors Providing Light & Spacious Accommodation
- Level Garden Affording a Good Degree of Privacy
- Modern Fitted Kitchen & Bathroom
- Carport Parking for 1 Vehicle
- Ideally Located for Anyone Looking to Live Close to the Best Paignton has to Offer
- Potential as a Holiday Home / Rental Property





## 5 Cliff Mews Cliff Road

Paignton, Paignton

The property is situated in a quiet location off Cliff Road, just around the corner from Roundham Common, Paignton Harbour and nearby local shops. There are a choice of lovely beaches and the fabulous coastal walk linking the nearby towns of Torquay and Paignton. There are regular bus services and a train station which links to the nearby mainline station in Newton Abbot. Paignton town centre has a good choice of shops, cafes and restaurants.

### Absolute Sales & Lettings

Absolute Sales & Lettings, 27 Hyde Road - TQ4 5BP

01803 890110

[paignton@movewithabsolute.co.uk](mailto:paignton@movewithabsolute.co.uk)

<http://www.movewithabsolute.co.uk>





## Ground Floor

Approx. 33.3 sq. metres (358.4 sq. feet)

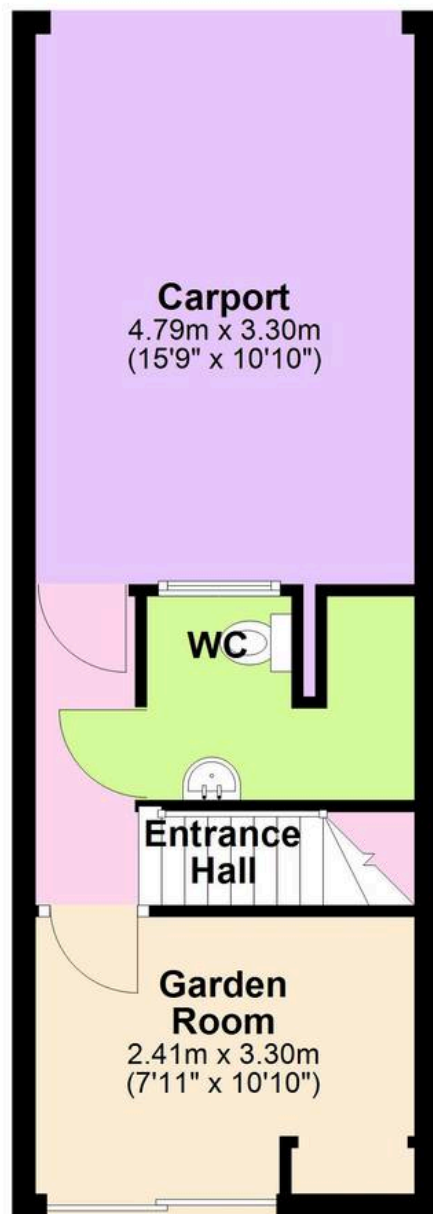

## First Floor

Approx. 33.3 sq. metres (358.4 sq. feet)

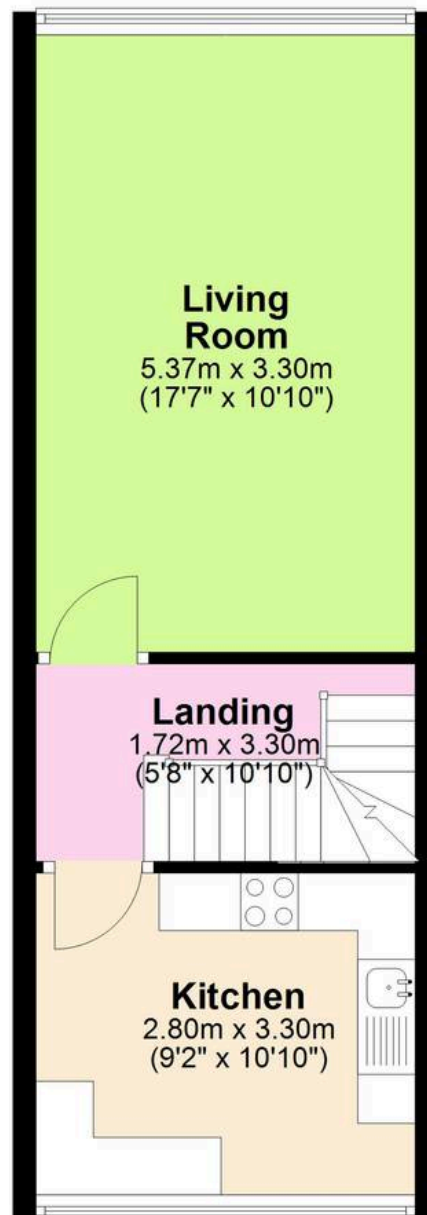

## Second Floor

Approx. 38.2 sq. metres (411

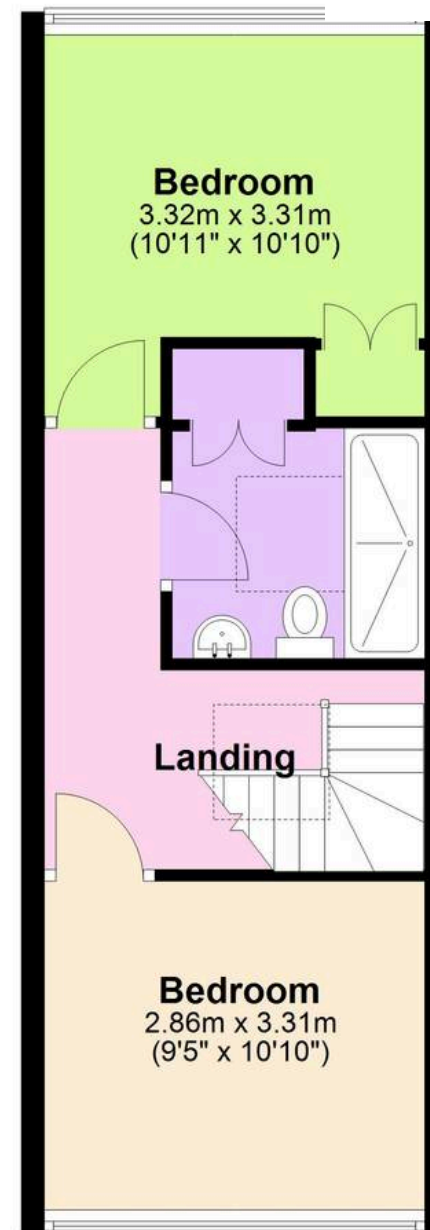

Total area: approx. 104.8 sq. metres (1128.2 sq. feet)

