



27 Barton Hill Road, Torquay – TQ2 8JF  
£260,000







## 27 Barton Hill Road

Torquay, Torquay

A recently refurbished 3/4 bedroom terraced home in a sought after position close to excellent local schools benefitting from new kitchen, roof and boiler...

Council Tax band: C

Tenure: Freehold

EPC Energy Efficiency Rating: D

EPC Environmental Impact Rating: D

- A superbly presented 3/4 bedroom terraced family home
- Very popular residential location close to local schools
- Newly installed roof and boiler
- New flooring throughout the downstairs and landing
- Two reception rooms/ground floor bedroom flexibility
- Newly fitted and extended kitchen/diner with integrated appliances
- Downstairs cloakroom/WC
- Three further first floor bedrooms
- Shower room/WC
- Front and rear gardens with useful timber built shed and single garage





## 27 Barton Hill Road

Torquay, Torquay

Barton Hill Road is conveniently positioned within easy reach of Torquay town centre, local shops, schools, and transport links. The property enjoys close proximity to everyday amenities, while also being just a short drive from Torquay's vibrant harbourside, seafront, and award-winning beaches. Families will appreciate the choice of well-regarded local schools, as well as easy access to The Willows shopping precinct and The Wren Retail Park, which benefits from a wide range of supermarkets, home furnishing stores, a pharmacy and more. Commuters benefit from easy access to Torquay railway station and the South Devon Highway, connecting to Exeter, Plymouth, and beyond. This sought-after location combines the convenience of town living with the lifestyle benefits of the English Riviera, making it an excellent choice for a wide range of buyers.

### Absolute Sales & Lettings

Absolute Sales & Lettings Ltd, 13 Ilsham Road - TQ1 2JG

01803 214214

[torquay@movewithabsolute.co.uk](mailto:torquay@movewithabsolute.co.uk)

[movewithabsolute.co.uk/](http://movewithabsolute.co.uk/)



## Ground Floor

Approx. 68.5 sq. metres (737.4 sq. feet)



## First Floor

Approx. 40.1 sq. metres (431.6 sq. feet)

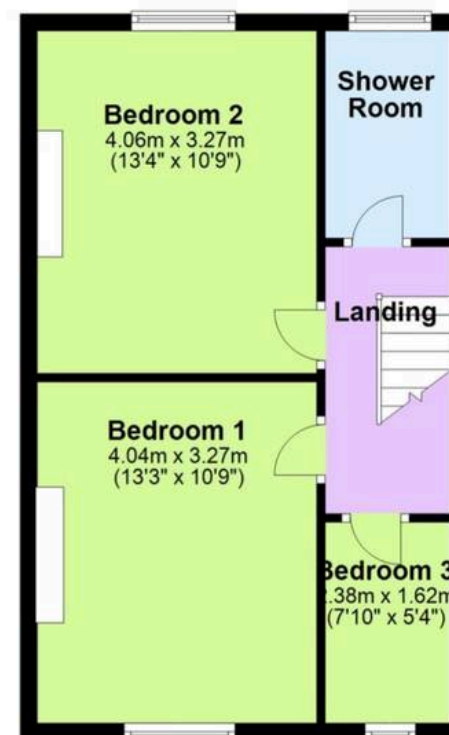

Total area: approx. 108.6 sq. metres (1169.0 sq. feet)

Approx  
Plan produced using PlanUp.

