



19 Gainsborough Close, Torquay – TQ1 2SB  
£300,000







## 19 Gainsborough Close

Torquay, Torquay

Delightful Mews House in prestigious area with panoramic views of Tor Bay. 2 bedrooms with ensembles, kitchen, lounge, dining room, paved terrace, and single garage.

Council Tax band: D

Tenure: Freehold

EPC Energy Efficiency Rating: C

EPC Environmental Impact Rating: C

- Beautifully appointed End of terrace mews house in the Lincombes
- Stunning panoramic sea views of Torbay towards Berry Head and beyond
- 2 double bedrooms with storage, 1 having splendid sea views
- 2 en-suites plus a cloakroom
- Delightful Terraced garden with pergola and stunning views
- Driveway parking in front of the single garage in a separate paddock
- Spacious lounge with extension creating a further dining space
- Fabulous location close to the south west coast path, Wellswood, Daddyhole plain and Meadfoot Beach





# 19 Gainsborough Close

Torquay,

## Absolute Sales & Lettings

Absolute Sales & Lettings Ltd, 13 Ilsham Road - TQ1 2JG

01803 214214

[torquay@movewithabsolute.co.uk](mailto:torquay@movewithabsolute.co.uk)

[movewithabsolute.co.uk/](http://movewithabsolute.co.uk/)

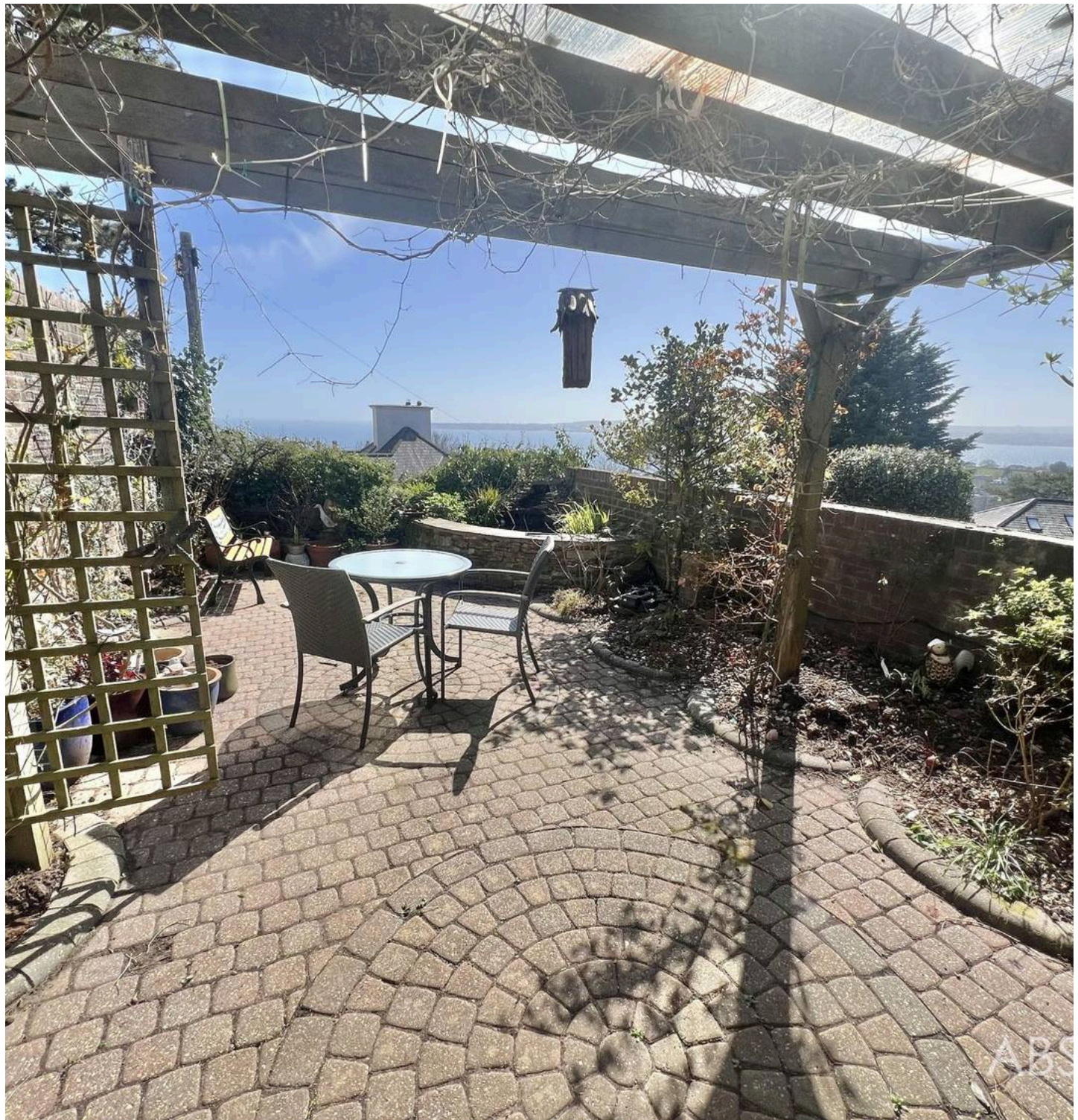



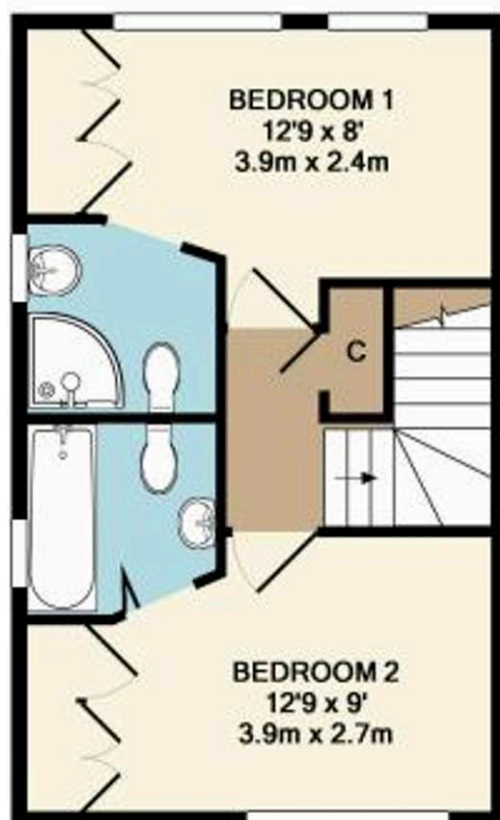

1ST FLOOR  
APPROX. FLOOR  
AREA 358 SQ.FT.  
(33.3 SQ.M.)

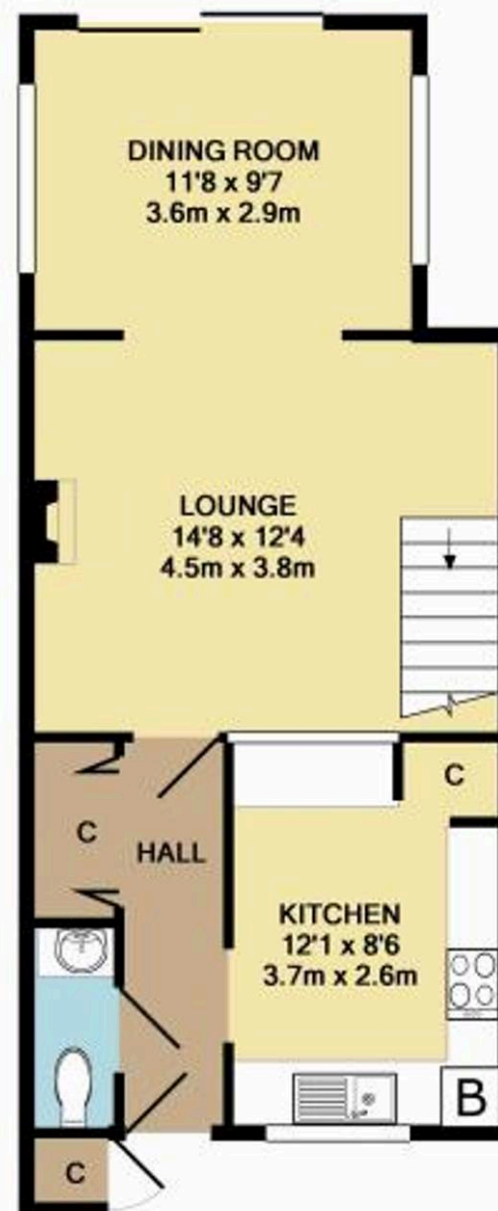

GROUND FLOOR  
APPROX. FLOOR  
AREA 479 SQ.FT.  
(44.5 SQ.M.)

TOTAL APPROX. FLOOR AREA 837 SQ.FT. (77.7 SQ.M.)

Measurements are approximate. Not to scale. Illustrative purposes only  
Made with Metropix ©2013

