



Vale Road, Kingskerswell - TQ12 5AE

Guide Price £225,000







## Vale Road

Kingskerswell, Newton Abbot

Well presented, 2 bed semi attached house with entrance hallway, cloakroom, sitting room, fitted kitchen, conservatory. 2 bedrooms, bathroom. Additional room in loft. Ample parking, 2 workshops and low maintenance rear garden.

Council Tax band: B

Tenure: Freehold

EPC Energy Efficiency Rating: C

- Popular village location
- Downstairs cloakroom/WC
- Sitting room and conservatory
- Fitted kitchen with built in appliances
- Two bedrooms and bathroom/WC
- Ample off road parking and two useful workshops
- The loft has been boarded to make a useful additional room
- Easy to maintain enclosed rear garden, open views from the front elevation
- Gas central heating and uPVC double glazing





# Vale Road

Kingskerswell, Newton Abbot

The property occupies a residential position within the popular village of Kingskerswell with its array of local shops and pubs. Within easy access to both Newton Abbot and Torquay town centre which are both approximately 3.5 miles distant. There is also good access to the bypass which connects to Exeter and beyond. An early inspection is highly recommended to appreciate the accommodation on offer.

## Absolute Sales & Lettings

Absolute Sales & Lettings Ltd, 13 Ilsham Road - TQ1 2JG

01803 214214

[torquay@movewithabsolute.co.uk](mailto:torquay@movewithabsolute.co.uk)

[movewithabsolute.co.uk/](http://movewithabsolute.co.uk/)



# Ground Floor

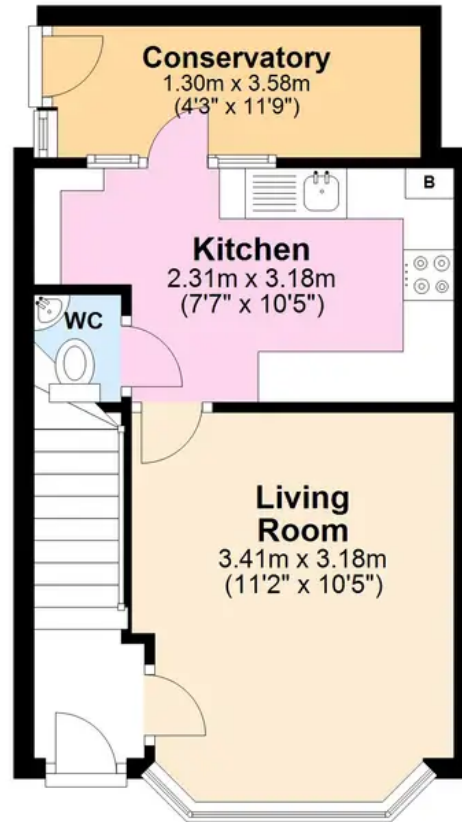
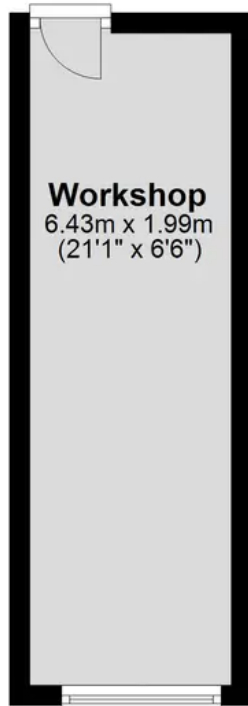
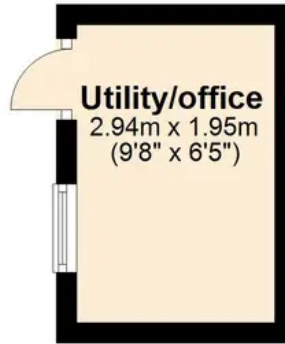

# First Floor

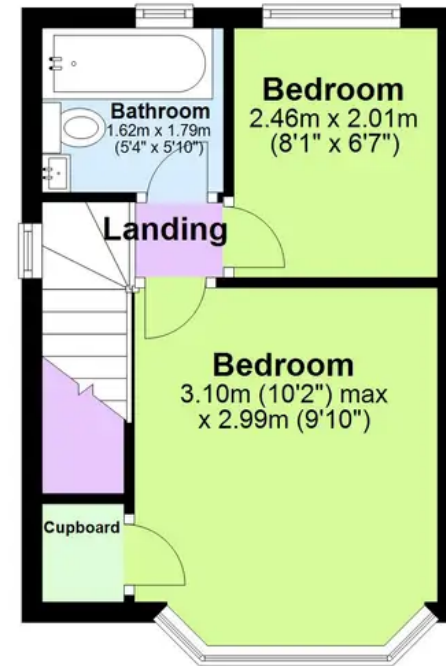

Total area: approx. 70.8 sq. metres (761.8 sq. feet)

Approx  
Plan produced using PlanUp.

