



## The Windsor

Now released for reservation.

The Windsor is a simply wonderful four bedroom executive family home. Part of the new and exciting Strawberry Fields development in Keyingham.

Reserve early to personalise your home.

### **Plot 4 - Elsanta House**

Strawberry Fields, Ottringham Road,  
Keyingham, HU12 9RX

**Asking Price £329,950**

FIND YOUR FOREVER HOME AT STRAWBERRY FIELDS, KEYINGHAM



Strawberry Fields is a stunning development of contemporary two, three and four bedroom homes constructed by the renowned and award winning local builder, MR.BUILDER LTD. Set on the edge of the extremely popular village of Keyingham, being only a short distance to the coast, the Wolds and set in the heart of the wonderful Holderness Plain.

The ground floor consists of open plan living, dining, kitchen, plus further comfortable bay fronted sitting room, utility room, and w.c.

To the first floor there are four bedrooms, two luxury en-suites and a house bathroom.

There is a comprehensive range in choice of luxury styles and designs of kitchens and bathrooms, but should you wish to add further personal upgrades and extras, these are available.

The rural village of Keyingham lies approximately eight miles to the east of the city centre of Kingston-Upon-Hull and offers a good array of local shops, public transportation and leisure facilities. The market town of Hedon lies approximately five miles to the west of the village where a wide range of amenities can be found.

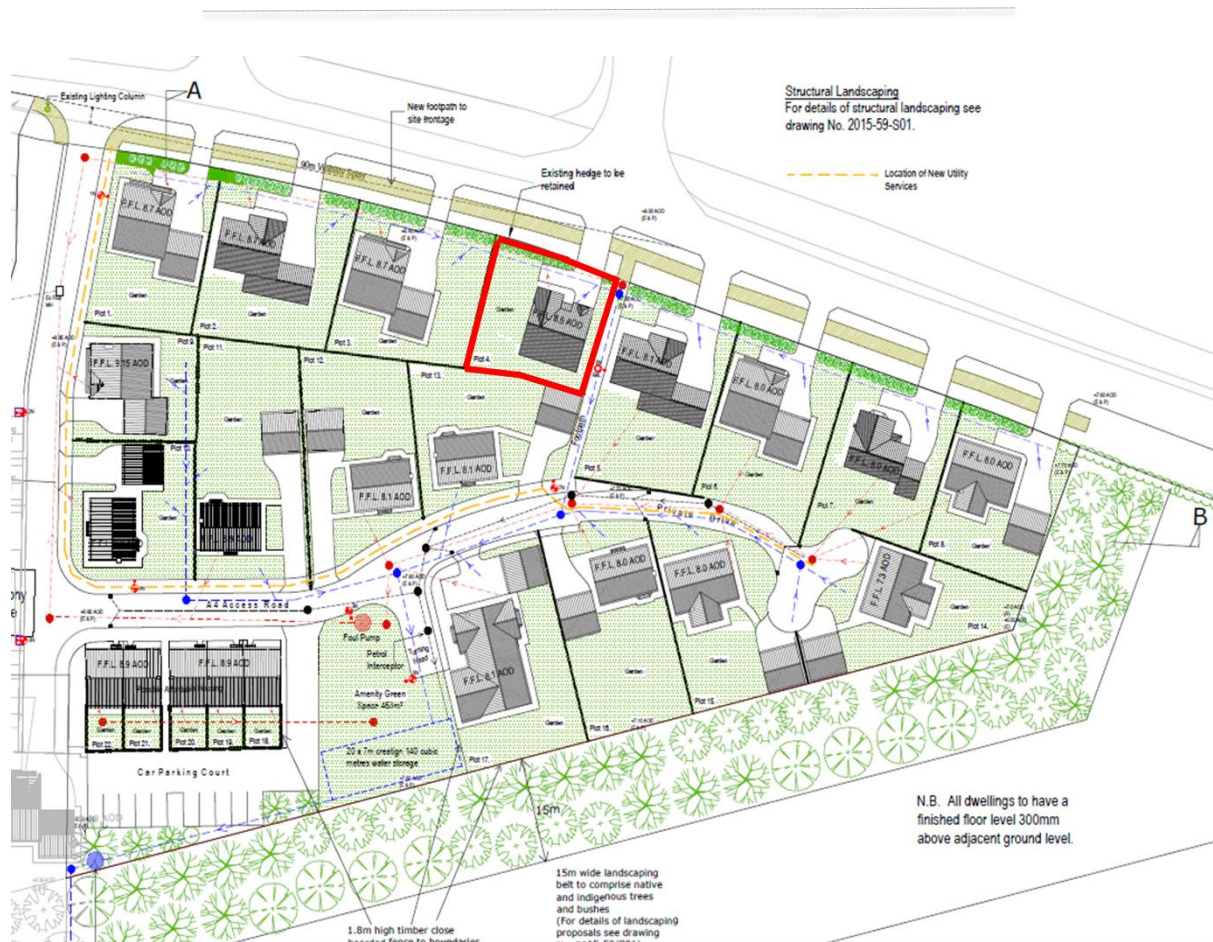

- New Build 4 bedroom Detached Family Home
- Comprehensive choice of Luxury Kitchens, complete with appliances, designed by Specialists
- Opportunity to personalise throughout the property once reserved.
- Open Plan Kitchen, Dining and Family room, with French Doors leading to Garden
- Spacious Lounge with Bay Window.
- Utility Room

- Two luxury Ensuites plus a Modern Family Bathroom. A wide range of Bathroom suites available to choose from
- Driveway with Ample Parking, Garage and Private Garden
- Security Cameras Back and Front
- UPVC Windows, Facias & Soffits
- Sky TV Points
- Mains wired Smoke Detectors
- Electric Vehicle charging point
- 10 Year LABC warranty

GROUND FLOOR  
852 sq.ft. (79.2 sq.m.) approx.



1ST FLOOR  
843 sq.ft. (78.3 sq.m.) approx.

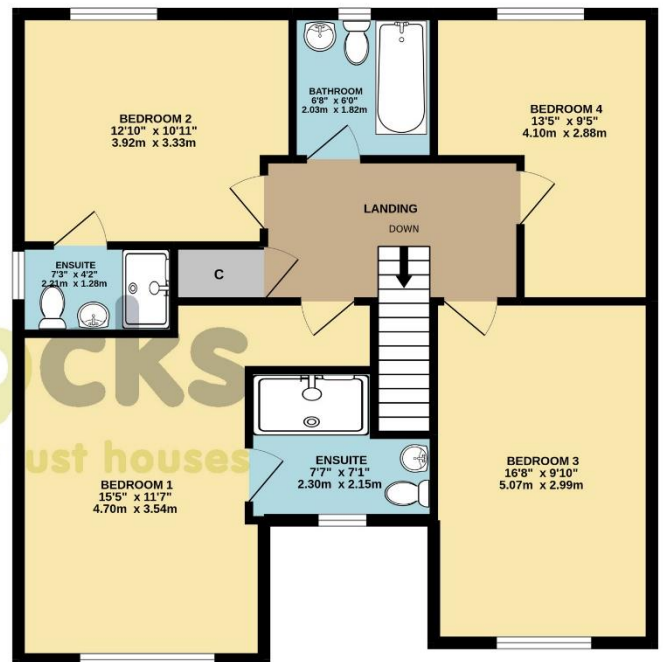

TOTAL FLOOR AREA : 1695 sq.ft. (157.5 sq.m.) approx.

Whilst every attempt has been made to ensure the accuracy of the floorplan contained here, measurements of doors, windows, rooms and any other items are approximate and no responsibility is taken for any error, omission or mis-statement. This plan is for illustrative purposes only and should be used as such by any prospective purchaser. The services, systems and appliances shown have not been tested and no guarantee as to their operability or efficiency can be given.  
Made with Metropix ©2022

## HEDON

1 ST AUGUSTINES GATE, HEDON,  
HULL, HU12 8EU

T. 01482 891234

E. HEDON@BEERCOCKS.COM

