



## 87 Price's Court Cotton Row, London, SW11 3YS

Asking Price £625,000

**Price's Court, SW11**

Gross internal area (approx) 75.06 sq m / 808 sq ft

Key :  
CH - Ceiling Height

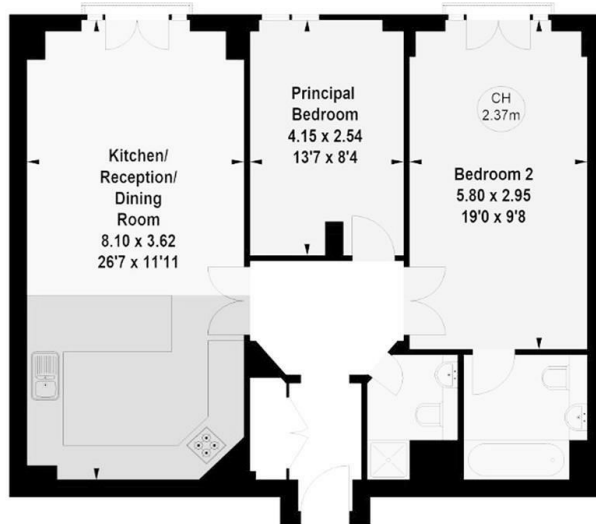

Second Floor

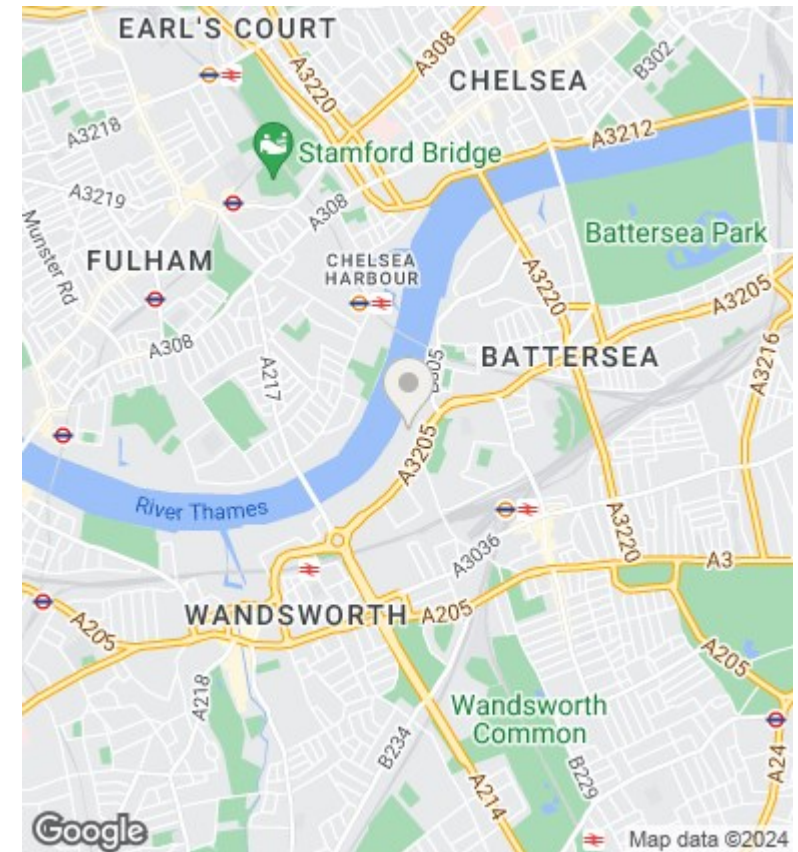

**Directions**

**Viewings**

Viewings by arrangement only. Call 02070990800 to make an appointment.

**Council Tax Band**

F

**EPC Rating:**

D

Energy Efficiency Rating		
	Current	Potential
<i>Very energy efficient - lower running costs</i>		
(92 plus) <b>A</b>		
(81-91) <b>B</b>		77
(69-80) <b>C</b>		
(55-68) <b>D</b>	57	
(39-54) <b>E</b>		
(21-38) <b>F</b>		
(1-20) <b>G</b>		
<i>Not energy efficient - higher running costs</i>		
<b>England &amp; Wales</b>	EU Directive 2002/91/EC	