

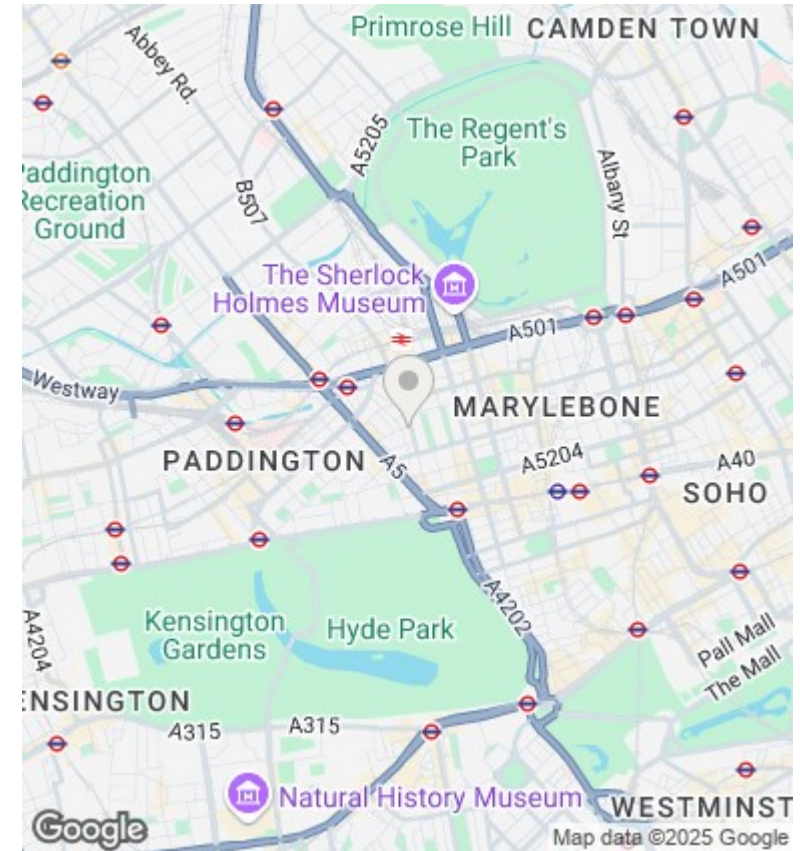

## Harrowby Court, Marylebone, London W1H

Asking Price £1,950,000

- 3 Double Bedroom / 2 Bathroom (1 ensuite)
- Lift access
- Short walk to Oxford Street
- Large reception
- Excellent Marylebone location
- Abundance of nature light
- Hyde Park and Regent Park close-by

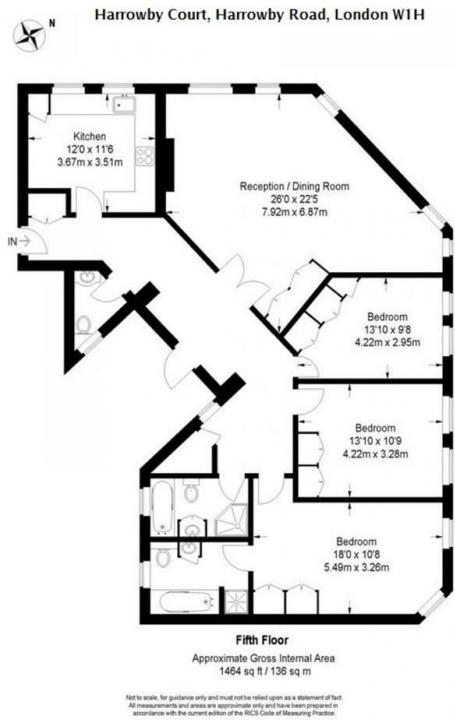

## Directions

## Viewings

Viewings by arrangement only. Call 02070990800 to make an appointment.

## Council Tax Band

F

## EPC Rating:

D

Energy Efficiency Rating		Current	Potential
<i>Very energy efficient - lower running costs</i>			
(92 plus)	A		
(81-91)	B		82
(69-80)	C		
(55-68)	D	57	
(39-54)	E		
(21-38)	F		
(1-20)	G		
<i>Not energy efficient - higher running costs</i>			
<b>England &amp; Wales</b>		EU Directive 2002/91/EC	