



Quasi Semi Detached

3 Bedrooms

Recently Refurbished

Conservatory

EPC Grade D

Large Rear Garden



19 Gloucester Avenue, Whitefield,
Manchester, Greater Manchester, M45
6BX

Monthly Rental Of £725

DESCRIPTION

****EXCELLENT LOCATION ** **UNFURNISHED** **AVAILABLE END OF AUGUST 2018****

This fantastic property has been refurbished throughout within the last 12 months and is sure to make an excellent family home. It is located not far from the metro link and motorway network making it a big plus for the city centre commute. Internally, there is no shortage of space with a large lounge, kitchen/dining room and conservatory to the ground floor while to the first floor there are 3 bedrooms and a bathroom. Externally there is a large garden to the rear. EPC grade D. A full copy of the EPC is available upon request.

****NO DSS ****

****The Landlord will consider some pets. Please telephone the office for further details.**

ABOUT THE AREA

Whitefield is an extremely vibrant & popular town with it's range of bars, restaurants, leisure facilities and transport links. Access to the M60 ring road is just 1 mile away and Whitefield Metrolink is within walking distance. The nearby Philips Park is ideal for enjoying picturesque walks.

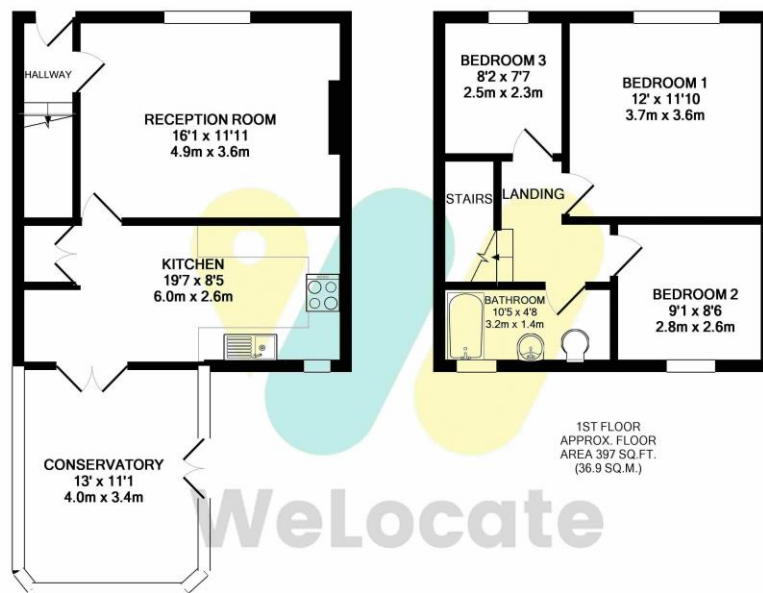

GROUND FLOOR
APPROX. FLOOR
AREA 540 SQ.FT.
(50.2 SQ.M.)

TOTAL APPROX. FLOOR AREA 937 SQ.FT. (87.1 SQ.M.)

Whilst every attempt has been made to ensure the accuracy of the floor plan contained here, measurements of doors, windows, rooms and any other items are approximate and no responsibility is taken for any error, omission, or mis-statement. This plan is for illustrative purposes only and should be used as such by any prospective purchaser. The services, systems and appliances shown have not been tested and no guarantee as to their operability or efficiency can be given.
Made with Metropix ©2017

0161 696 0777

www.we-locate.co.uk