





Haydock Road, Catterick Garrison

Your new home awaits. The perfect lock up and leave in the centre of the Garrison, close to the local shops, schools and travel links, it's the perfect spot for your first home or a downsize!

Park up on your driveway and head inside, where it's shoes and coats off before sitting down to relax.

Your living room is to the back of the house and looks over your garden, with double doors opening onto it. You can spend sunny days inside or out when friends come over to visit.

When you're feeling peckish, head to the kitchen/diner where you can cook up a well deserved meal to enjoy round your table. The neutral design means your kitchen appliances will fit right in without having to change a thing!

You also have a handy downstairs WC just off from the kitchen, which is ideal when you have visitors round so, they don't have to trail upstairs.



When you're feeling sleepy head upstairs to bed where you have two bedrooms to choose from. Your main bedroom is ideal for your double bed and wardrobes, the pretty green panelling frames your bed perfectly, making it your favourite place to wrap up and rest at night.

Bedroom two is another double room and is ideal for any children or guests stopping over. If you don't need the space you could convert it into your home office!

The bathroom completes this floor, you can enjoy evening soaks in the bath, with a few candles lit to relax after a long day, or jump in the shower for a quick freshen up before heading out for the day.

Your back garden is the perfect little sun trap, imagine summer days spent here with friends, whilst the BBQ heats up, and you enjoy a few drinks!

Finer Details:

Postcode: DL9 4BN

Freehold

Council Tax Band: B

EPC rating: B

Gas central heating

Guide price £170,000



Haydock Road Colburn

Total area: approx. 59.7 sq. metres (642.2 sq. feet)

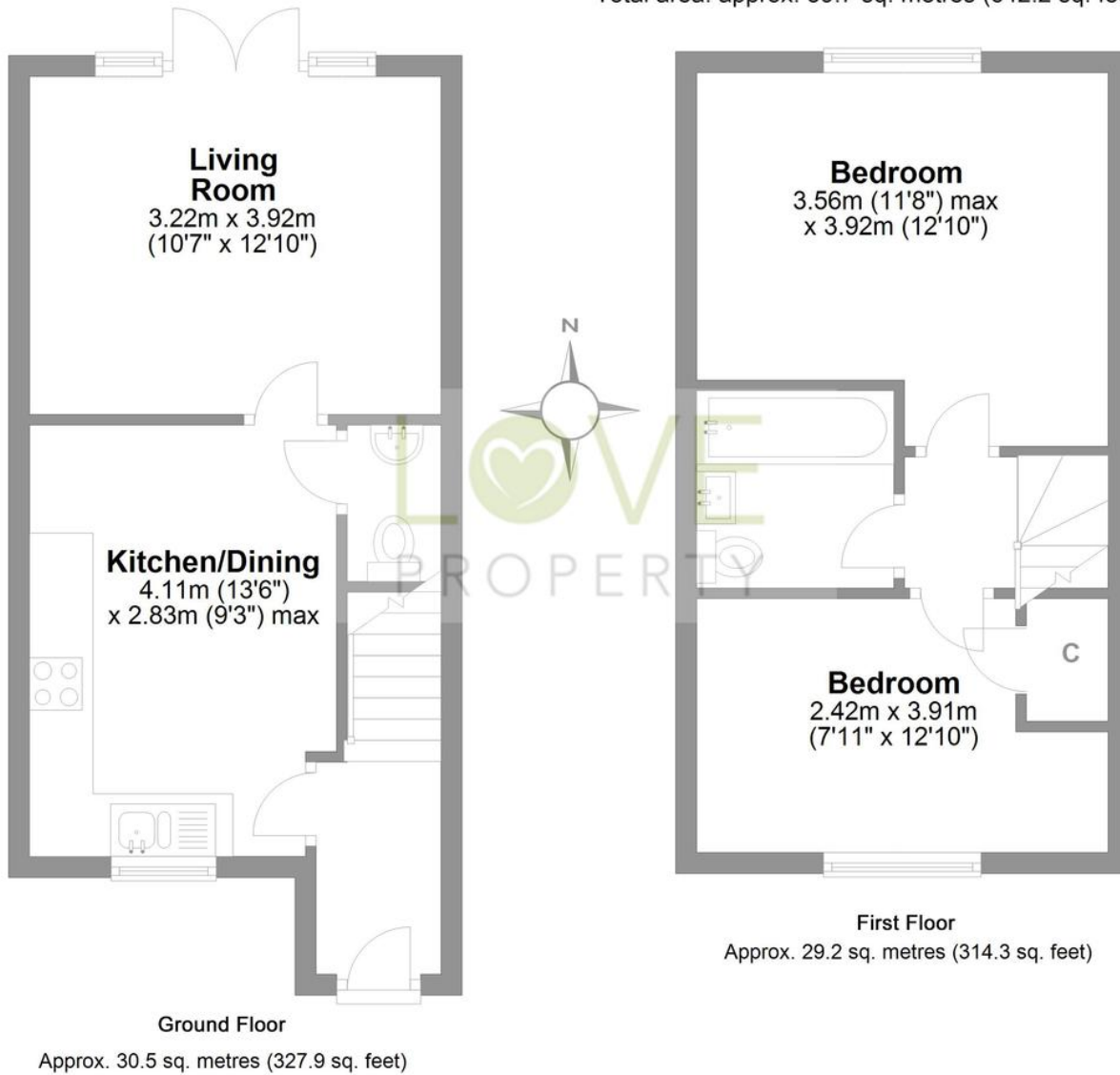

Whilst every attempt has been made to ensure the accuracy of the floorplans contained here, measurements of doors, windows, rooms and any other items are approximate and no responsibility is taken for any error, omission or mis-statement. This plan is not drawn to scale and is for illustrative purposes only & should be used as such by any prospective purchaser. Created especially for Love Property by Vue3sixty Ltd

Love Property UK Ltd

Company Registration No. 6779915

www.lovepropertyuk.co.uk