





WHAT'S THE PROPERTY LIKE?

Fir Lodge Court is located near the ever popular South Parade in Northallerton. The property is on the ground floor and benefits from permit parking. There are two bedrooms and a lovely bright living room. The kitchen has plenty of units and space for a small table and chairs. There is a bathroom.

The property is within walking distance of the train station and the town centre making it the perfect location for living and commuting.

WHERE IS IT?

Northallerton offers a range of facilities including a very well served High Street including: Marks and Spencer Food, Betty's Tea Rooms, Barker's Department Store circa 1882, three supermarkets, several independent and chain restaurants, a twice weekly market including a monthly farmers market, primary and secondary schooling, a hospital and a library. Northallerton is located close to the North York Moors and Yorkshire Dales, offering a full range of outdoor pursuits and sporting activities. Northallerton is situated on the East Coast mainline providing regular train services to London, Edinburgh, Leeds and York. The recently extended A1M is 6 miles to the West, the A19 is 6 miles to the North East, both offering easy access to Leeds, York, Middlesborough, Tees Valley and Leeds Bradford Airport.



THINGS YOU NEED TO KNOW

Postcode: DL7 8TZ

Council Tax Band: B - Hambleton District Council

Bond: The bond for this property is £692. This will be refunded at the end of the tenancy subject to terms and conditions.

Pets: Unfortunately pets can not be considered for this property due to the lack of outside space and terms of the head lease.

Heating: Electric heating.

Parking: Permit parking is available.

EPC Rating: D.

Available: Immediately.

LOVE IT? HOW TO APPLY....

Things to be aware of before applying:

Affordability: As per our referencing companies requirements you will need a combined income of £18,000.

Holding Deposit: You will need to pay a holding deposit that is equivalent to 1 weeks rent (£138.00) and provide some personal and financial information (3 months bank statements) in order for us to commence with the referencing process. Your holding deposit will be deducted from your first months rent or refunded to you after 15 calendar days, whichever you are agreeable to.

Call now to register your interest on 01748 834373.



Fir Tree Lodge Northallerton

Total area: approx. 58.6 sq. metres (631.0 sq. feet)

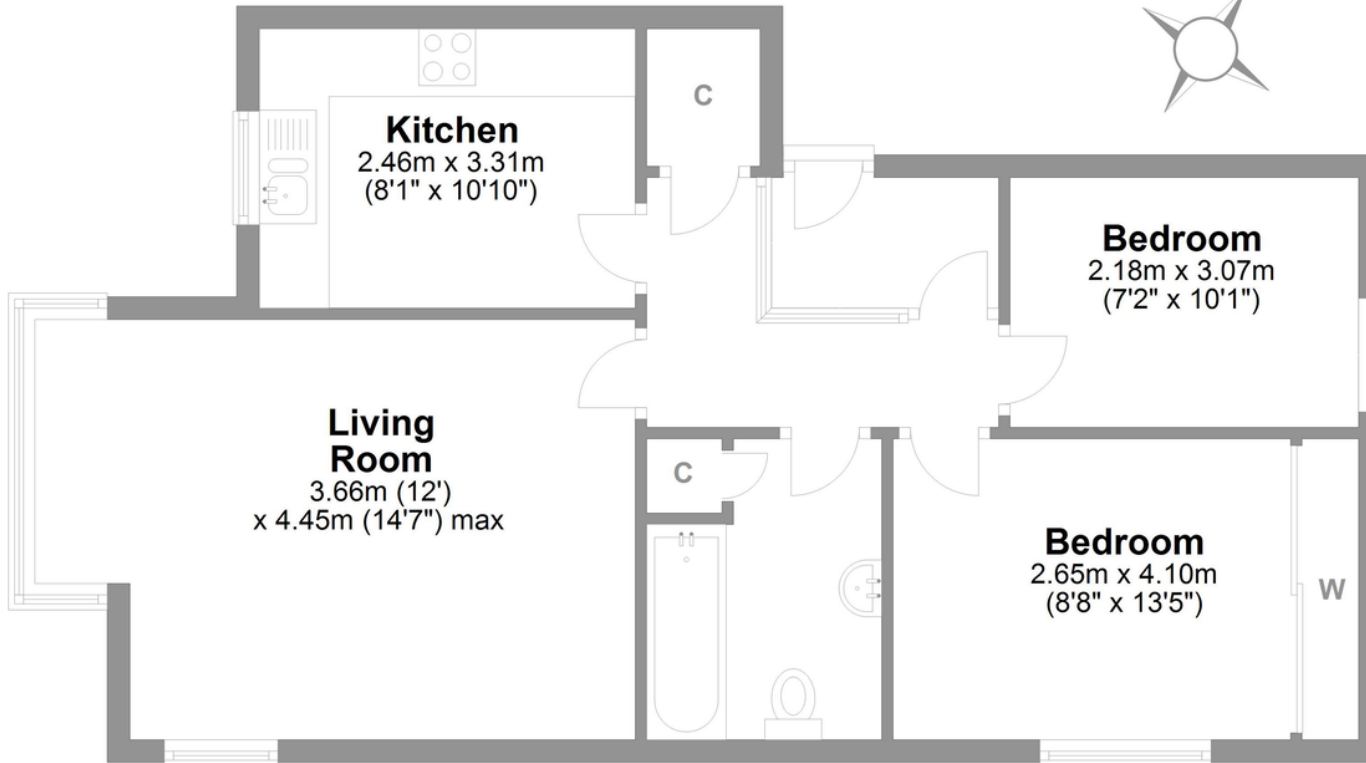

LOVE PROPERTY

Whilst every attempt has been made to ensure the accuracy of the floorplans contained here, measurements of doors, windows, rooms and any other items are approximate and no responsibility is taken for any error, omission or mis-statement. This plan is not drawn to scale and is for illustrative purposes only & should be used as such by any prospective purchaser. Created especially for Love Property by Vue3sixty Ltd

01748 834 373

hello@lovepropertyuk.co.uk

find us on Facebook

@lovingproperty

Catterick Garrison

18 Richmond Road, Catterick

Love Property UK Ltd

Company Registration No. 6779915

www.lovepropertyuk.co.uk