





WHAT'S THE PROPERTY LIKE?

A delightful end terrace cottage with accommodation set over three floors. To the ground floor there is a living room, small but perfectly equipped kitchen with a utility store housing plumbing for washing machine. To the first floor there is a double bedroom and bathroom, the main bedroom is on the top floor. Situated in Catterick Village, this is an ideal starter home or perfect for someone who is downsizing and wants to be close to amenities. A lovely property which is available immediately.

WHERE IS IT?

The picturesque Catterick Village, just a few miles from the historic market town of Richmond. A very popular and active village with a Co-op, garage, doctors, pharmacy, hairdressers, takeaways, pubs and a school. Also providing convenient links within 1/4 mile to the A1 north and south motorway junctions to Darlington, Newcastle, York and Leeds making this the ideal base for travelling throughout the region.

THINGS YOU NEED TO KNOW....

Postcode: DL10 7LP.

Council Tax Band: A - Richmondshire District Council.

Deposit: The deposit for this property is £663. This is payable prior to move in and will be refunded at the end of the tenancy subject to terms and conditions.

Pets: Pets will be considered on a case by case basis.

Heating: Electric heating.

Glazing: The property is double glazed.

EPC Rating: C

Available from: Immediately



LOVE IT? HOW TO APPLY....

Things to be aware of before applying:

Affordability: As per our referencing companies requirements you will need a combined income of £17,250.

Holding Deposit: You will need to pay a holding deposit that is equivalent to 1 weeks rent (£132.00) and provide some personal and financial information (3 months payslips and 3 months bank statements) in order for us to commence with the referencing process. Your holding deposit will be deducted from your first months rent or refunded to you after 15 calendar days, whichever you are agreeable to.

Call now to register your interest on 01748 834373.



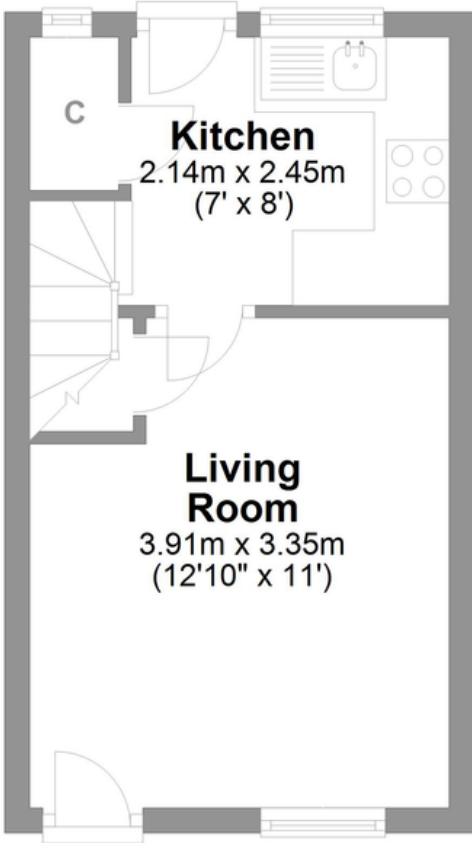

Ground Floor

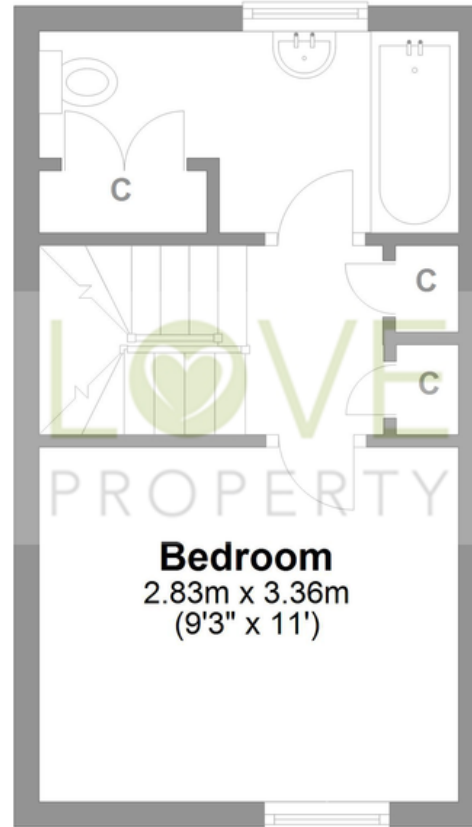

First Floor

Low Green Catterick Village

Total area: approx. 51.5 sq. metres (554.2 sq. feet)

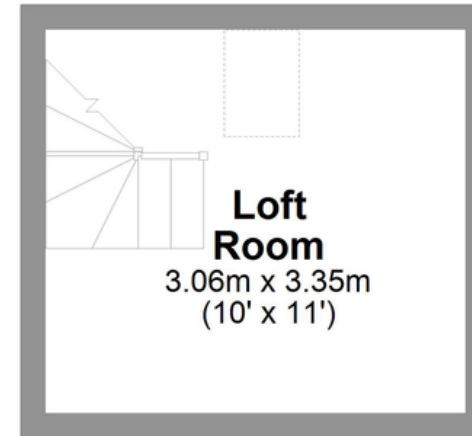

Second Floor

Whilst every attempt has been made to ensure the accuracy of the floorplans contained here, measurements of doors, windows, rooms and any other items are approximate and no responsibility is taken for any error, omission or mis-statement. This plan is not drawn to scale and is for illustrative purposes only & should be used as such by any prospective purchaser. Created especially for Love Property by Vue3sixty Ltd

01748 834 373 

hello@lovepropertyuk.co.uk 

find us on Facebook 

@lovingproperty 

Catterick Garrison

18 Richmond Road, Catterick

Love Property UK Ltd

Company Registration No. 6779915

www.lovepropertyuk.co.uk