





WHAT'S THE PROPERTY LIKE?

A lovely cottage in a popular village location. The living room has stone flooring, a cosy open fire and window seat to watch the world go by. There is a fitted kitchen with stone flooring and a built in oven and hob. There is a rear hallway/boot room which is a handy space for storage or an appliance. To the first floor there are two bedrooms and a bathroom. There is a low maintenance garden with a storage shed and woodstore. This delightful property is available immediately.

WHERE IS IT?

The picturesque Catterick Village, just a few miles from the historic market town of Richmond. A very popular and active village with a Co-op, garage, doctors, pharmacy, hairdressers, takeaways, pubs and a school. Also providing convenient links within 1/4 mile to the A1 north and south motorway junctions to Darlington, Newcastle, York and Leeds making this the ideal base for travelling throughout the region.

THINGS YOU NEED TO KNOW....

Postcode: DL10 7LP.

Council Tax Band: A - Richmondshire District Council.

Deposit: The deposit for this property is £721. This is payable prior to move in and will be refunded at the end of the tenancy subject to terms and conditions.

Pets: Pets will be considered on a case by case basis.

Appliances: Oven and hob.

Heating: Electric heating.

EPC Rating: E.

Available from: Immediately.



LOVE IT? HOW TO APPLY....

Things to be aware of before applying:

Affordability: As per our referencing companies requirements you will need a combined income of £18,750.

Holding Deposit: You will need to pay a holding deposit that is equivalent to 1 weeks rent (£144.00) and provide some personal and financial information (3 months payslips and 3 months bank statements) in order for us to commence with the referencing process. Your holding deposit will be deducted from your first months rent or refunded to you after 15 calendar days, whichever you are agreeable to.

Call now to register your interest on 01748 834373.





Low Green Catterick Village

Total area: approx. 57.1 sq. metres (614.7 sq. feet)

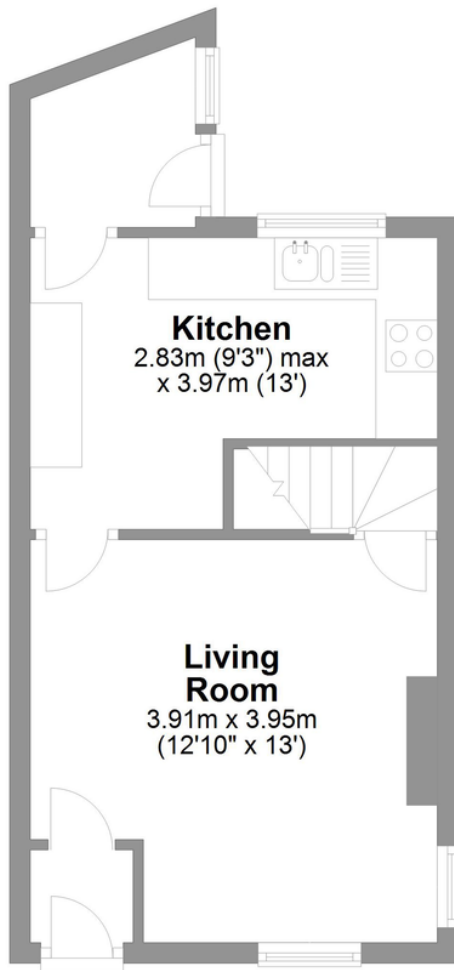

Ground Floor



First Floor

LOVE PROPERTY

Whilst every attempt has been made to ensure the accuracy of the floorplans contained here, measurements of doors, windows, rooms and any other items are approximate and no responsibility is taken for any error, omission or mis-statement. This plan is not drawn to scale and is for illustrative purposes only & should be used as such by any prospective purchaser. Created especially for Love Property by Vue3sixty Ltd

01748 834 373

hello@lovepropertyuk.co.uk

find us on Facebook

@lovingproperty

Catterick Garrison

18 Richmond Road, Catterick

Love Property UK Ltd

Company Registration No. 6779915

www.lovepropertyuk.co.uk