





HALLGARTH

A good sized first floor apartment benefiting from a spacious lounge and a modern style kitchen with plenty of cupboard and worktop space. Across the hallway is a double bedroom, there is also a bathroom and a handy walk in storage cupboard. This property would best suit either a single occupier or couple. The property also enjoys a small front garden.

LOCATION

Hipswell is a small village within Catterick Garrison, is conveniently located a short distance from the Princes Gate shopping centre which is home to various shops, bars/restaurants and the Empire Cinema. There is also a Tesco superstore, Aldi, Lidl and other food shops nearby. Catterick Leisure Centre has a gym and swimming pools. just a few miles south is the historic market town of Richmond. It is well placed for local amenities, schools, shops, bars, restaurants and a leisure centre. Also providing convenient links within 3 miles to the A1 north and south to Darlington, Newcastle, York and Leeds making this the ideal base for travelling throughout the region.



FINER DETAILS

Post code: DL9 4BL.

Style of property: First floor mainsonette.

Council Tax Band: A. Richmondshire District Council.

EPC: C.

Heating: Gas central heating.

Parking: There is on road parking available.

Appliances: Integrated oven and hob.

Pets: Unfortunately pets will not be considered at this property due to a lack of outside space.

Term: The Landlord is looking for a long term tenant with an initial 12 month fixed term.

What 3 words: guarding.oath.reshapeing

Available from: Mid May 2023.

LOVE IT? HOW TO APPLY....

Things to be aware of before applying:

Affordability: As per our referencing companies requirements you will need a combined income of £15,000.

Holding Deposit: You will need to pay a holding deposit that is equivalent to 1 weeks rent (£115.00) and provide some personal and financial information (3 months bank statements) in order for us to commence with the referencing process. Your holding deposit will be deducted from your first months rent or refunded to you after 15 calendar days, whichever you are agreeable to.

Deposit: The bond for this property is £576.00. This will be refunded at the end of the tenancy subject to terms and conditions. Call now to register your interest on 01748 834373.



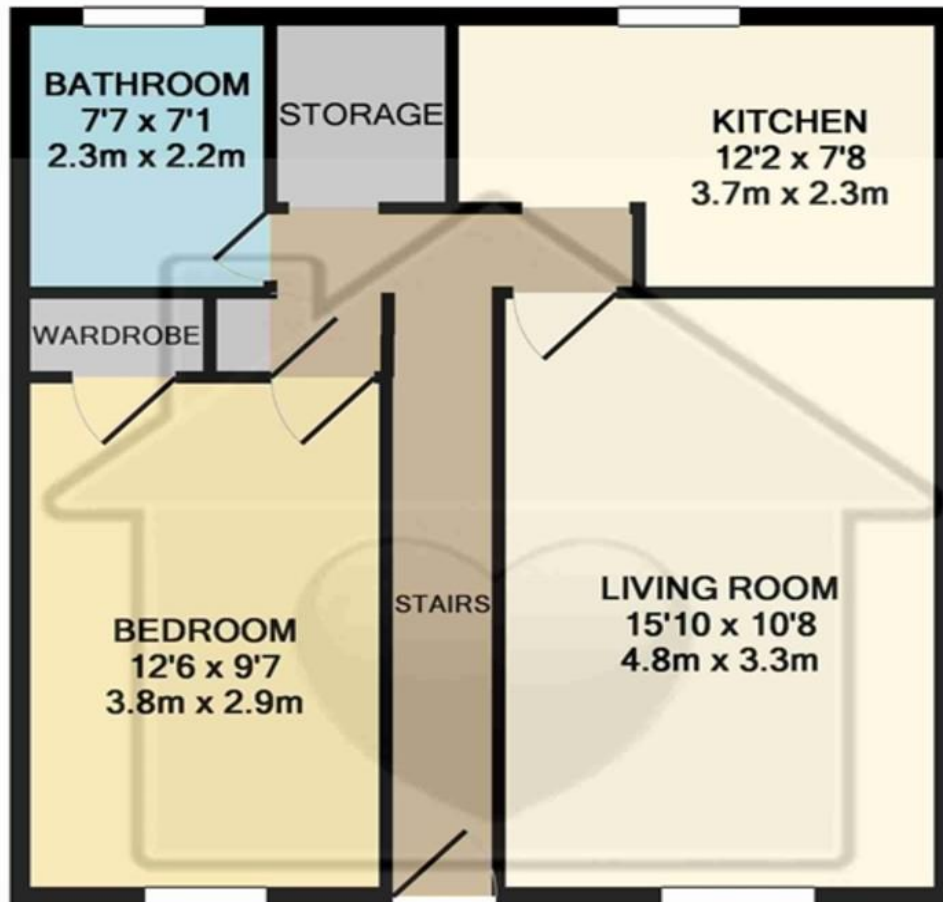

TOTAL APPROX. FLOOR AREA 511 SQ.FT. (47.5 SQ.M.)

Whilst every attempt has been made to ensure the accuracy of the floor plan contained here, measurements of doors, windows, rooms and any other items are approximate and no responsibility is taken for any error, omission, or mis-statement. This plan is for illustrative purposes only and should be used as such by any prospective purchaser. The services, systems and appliances shown have not been tested and no guarantee as to their operability or efficiency can be given

Made with Metropix ©2015

01748 834 373

hello@lovepropertyuk.co.uk

find us on Facebook

@lovingproperty

Catterick Garrison

18 Richmond Road, Catterick

Love Property UK Ltd

Company Registration No. 6779915

www.lovepropertyuk.co.uk