

CHESTNUT CRESCENT

CATTERICK GARRISON

LOVE PROPERTY. 

LOVE THE JOURNEY



Chestnut Crescent

If you are looking for your first family home with some privacy, then this is the house for you. Close by to local shops, schools and a short drive to the A1 for transport links it's the ideal home for a busy family and whilst you are based in the heart of the Garrison, you still feel quietly tucked away once inside.

Pull onto the large driveway, which can host multiple vehicles and takes you right up to the front door. A must for getting shopping out of the car and into the house with ease.

On arrival, you can slip off your coat and shoes and tidy them away in the large and useful storage cupboard in the hallway. It's probably been a long day, so it's time to head into the kitchen and make a nice cup of tea. You could also throw in a small table to make this a really sociable space.

Through to the living room and you can enjoy putting your feet up on an evening. Snuggle up on your large cosy sofa, grab the remote and treat yourself to an evening in front of your favourite series. A nice coffee table will make a great focal point here which can double up as an entertaining space, gather round, and share a takeaway and a bottle of wine!

For those more green fingered enjoy planting away in the sunshine in your back garden, then enjoy an ice cold drink in the warmth whilst sat out on your garden furniture. This is the perfect place to host a BBQ with friends in the summer months.





Time for bed...

Take the stairs from your living room to the upstairs of the house where you will find your bathroom suite. Run a bath, light a few candles and soak away the worries of the day. If you're in a rush, you can use the over-bath shower for a quick wake up in the morning.

There are two double bedrooms, so the choice is yours! The rear is the room with the garden outlook where the light will stream through on a summers morning. Put in your double bed, some nice contemporary furniture and this will be a lovely retreat to relax in.

Your front bedroom is the ideal second room for the youngest in the family, or guest room. With views to the front, you can watch the world go by over a cup of coffee before the day ahead.



Chestnut Crescent Catterick Garrison

Total area: approx. 60.1 sq. metres (647.0 sq. feet)

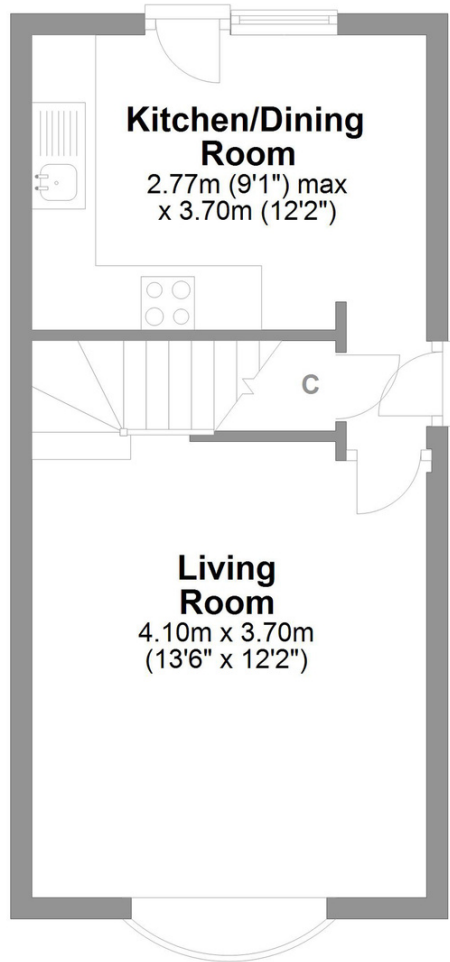

Ground Floor
Approx. 30.2 sq. metres (325.5 sq. feet)



First Floor
Approx. 29.9 sq. metres (321.5 sq. feet)

LOVE PROPERTY.

Whilst every attempt has been made to ensure the accuracy of the floorplans contained here, measurements of doors, windows, rooms and any other items are approximate and no responsibility is taken for any error, omission or mis-statement. This plan is not drawn to scale and is for illustrative purposes only & should be used as such by any prospective purchaser. Created especially for Love Property by Vue3sixty Ltd