

# FERNLEA MEWS

RICHMOND

LOVE PROPERTY. 

LOVE THE JOURNEY



# FERNLEA MEWS, RICHMOND

The charm of this home extends beyond its walls, allowing you to fully immerse yourself in the vibrant life of the historic town that surrounds you. Found in the picturesque Georgian town of Richmond, a stones throw from the cobbled center where you'll find pubs, eateries and shops in abundance. You also have beautiful scenic walks around the castle, river and Friary gardens which you can enjoy in the sunshine and take yourself off to the Georgian Theatre to relish in the local entertainment. Local busses run regularly from the town and you're just a short, 5 minute drive from the A1 and A66 if you need to head further afield.





## Welcome home...

As you step inside, you'll immediately sense the love and care that has been poured into every detail. Gleaming hardwood floors beckon you to explore further, guiding you through to the kitchen area first.

The kitchen is a culinary haven, adorned with top-of-the-range integral appliances and elegant worktops. Imagine whipping up delicious meals while your loved ones gather around, sharing stories and laughter in this heartwarming space.





# Living space

Head upstairs as you gather in the living room, surrounded by warmth and creativity, you can't help but admire the seamless integration of cutting-edge heating technology with captivating artwork. Soft, gentle waves of infrared heat will envelop you like a warm embrace, providing a cosy environment in the most stylish manner possible.

These heating canvases are not mere decorations; they are thoughtfully crafted to complement the interior design of the home. With a myriad of artistic options to choose from, you can select the perfect pieces that resonate with your personality and aesthetic preferences. Whether it's breathtaking landscapes, abstract masterpieces, or inspiring quotes, these infrared heating canvases will become conversation starters and cherished elements of your home.

When its time to relax the two cosy and inviting bedrooms await you at the end of each day, offering a peaceful sanctuary to rest and rejuvenate. Soft, plush carpets cradle your feet as you step into these havens of tranquility. And with two bathrooms, you'll never have to worry about mornings being rushed; one for you and another for guests or family members.

Imagine the joy of experiencing the changing seasons in this picturesque town, each one bringing its own unique charm to your doorstep. From festive decorations during the holidays to the blossoming of spring flowers, every moment will be filled with wonder and delight.







## Finer details

Postcode: DL10 4JA

Flying Freehold

EPC Rating: E (previous to new heating install)

Council Tax Band: Exempt (was B)

Infrared Heating system (on a nest)

There is no garage with this property

# Fernlea Mews Richmond

Total area: approx. 81.9 sq. metres (882.0 sq. feet)

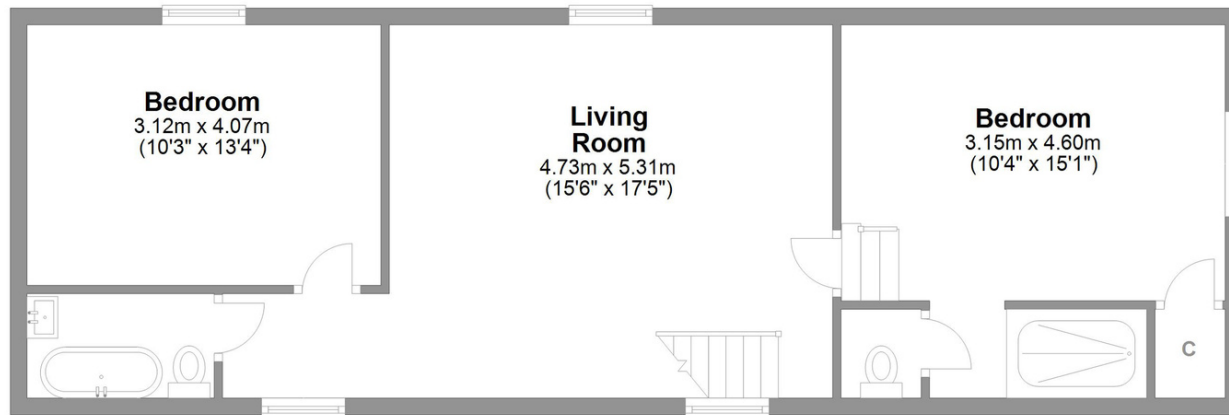

## First Floor

Approx. 64.8 sq. metres (697.3 sq. feet)

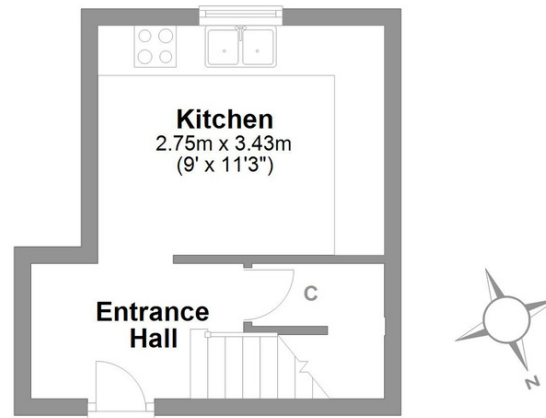

## Ground Floor

Approx. 17.2 sq. metres (184.7 sq. feet)

# LOVE PROPERTY.♥

Whilst every attempt has been made to ensure the accuracy of the floorplans contained here, measurements of doors, windows, rooms and any other items are approximate and no responsibility is taken for any error, omission or mis-statement. This plan is not drawn to scale and is for illustrative purposes only & should be used as such by any prospective purchaser. Created especially for Love Property by Vue3sixty Ltd