

Grove Cottage

COTHERSTONE

LOVE PROPERTY.

LOVE THE JOURNEY



GROVE COTTAGE

Grove Cottage is a rare gem nestled in the tranquil embrace of a sleepy village, where time stands still, and nature's beauty abounds. Welcome to your enchanting escape: a 3 bedroom, 2 reception room character property that will steal your heart from the moment you set eyes on it.

Embrace the Charm as you stroll along the front garden path, approaching your breathtaking new abode, a warm welcome awaits from the timeless charm of your classic, bold red front door and surrounded by two original bay sash windows.





£1.00 WEDNESDAY 11th JULY 2013

Hero scouts help rescue injured biker

By [Name]

When they were out on their bikes, the four men off to help the biker were looking for a way to help the injured biker. The four men, including a former professional footballer, used their skills to help the biker. The biker was injured and the four men used their skills to help him. The biker was injured and the four men used their skills to help him.

George's Football

Football match

George's Football match. The match was held at [Location]. The match was held at [Location]. The match was held at [Location].



Picture perfect

More and more people are taking up photography. More and more people are taking up photography. More and more people are taking up photography.

Colin Watson

Specialist in [Service]

Call [Phone Number]

British Touring Car Championship

www.britishtouringcar.com

Supporting [Sponsor]

Warm Welcome

As you step into your new home, the staircase leading to the 1st floor beckons you forward. However, before ascending, cast your gaze to the right, where you'll discover the inviting living room, adorned with an open fireplace, emanating a sense of warmth and familial comfort. Envision cherished family gatherings in this cozy space or tranquil evenings spent savouring your favourite beverage, creating lasting memories in the heart of your new home. Time to put your feet up and relax...you're home.





Dining Delights

Now, let's make our way to the dining room, just a short hop away. Similar to the lounge, the dining room boasts a charming bay window, providing the perfect vantage point to observe the ebb and flow of village life while you await the delicious dinner preparations. Gather your beloved family and friends around the table, engaging in heartfelt conversations about the week gone by, or conjure exciting plans together in this delightful setting.



To the kitchen...

Let's make our way to the kitchen now, where endless possibilities await. Embrace the charm of this country-style kitchen and unleash your inner chef or baker. A bank of base units awaits to accommodate all your essential kitchen items, complemented by an electric oven and hob for your culinary adventures. To the right of the kitchen, you'll find the most impressive walk-in pantry, a true hallmark of this character property, providing ample space to store all your culinary essentials, from delightful ingredients to cherished pots and pans. Unleash your imagination and turn this kitchen into the embodiment of your dream culinary haven. With plenty of room for creativity and customisation, you have the opportunity to craft the kitchen you've always envisioned. Moreover, conveniently located in this space, you'll find the door leading to your charming garden and yard.



Time for bed

Let's now venture to the tranquil sleeping quarters of the house, where you'll discover three charming bedrooms - two doubles and a spacious single, along with a family bathroom. The largest of the three bedrooms boasts a stunning original fireplace and offers picturesque views of the village green, adding a touch of timeless elegance to your cozy sanctuary.

Equally relaxing is the second double bedroom, offering serene views of the garden and village green. Throw open the sash, let the air softly flow in and relax. Just like the main bedroom, this delightful space also features an original fireplace, enhancing the ambiance with its classic charm.

Bedroom three is nestled at the rear of the property, providing a peaceful outlook over the charming fields of the small local school. This room presents itself as an ideal nursery or a comfortable space for children, easily accommodating a single bed, perhaps even bunk beds, and offering ample room for a wardrobe to complete the cozy setting.

The family bathroom is also thoughtfully located at the rear of the property, providing a haven of relaxation after a long day. Treat yourself to a luxurious bubble bath, and as you unwind, indulge in a glass of wine to soothe your senses. For a quick and refreshing start to your mornings, the bathroom offers the convenience of a refreshing shower before you head out to embrace the day ahead.





Finer details

Postcode: DL12 9QB
Council tax: D
EPC rating: F
Gas central Heating
Freehold





Grove Cottage Cotherstone

Total area: approx. 109.7 sq. metres (1181.1 sq. feet)

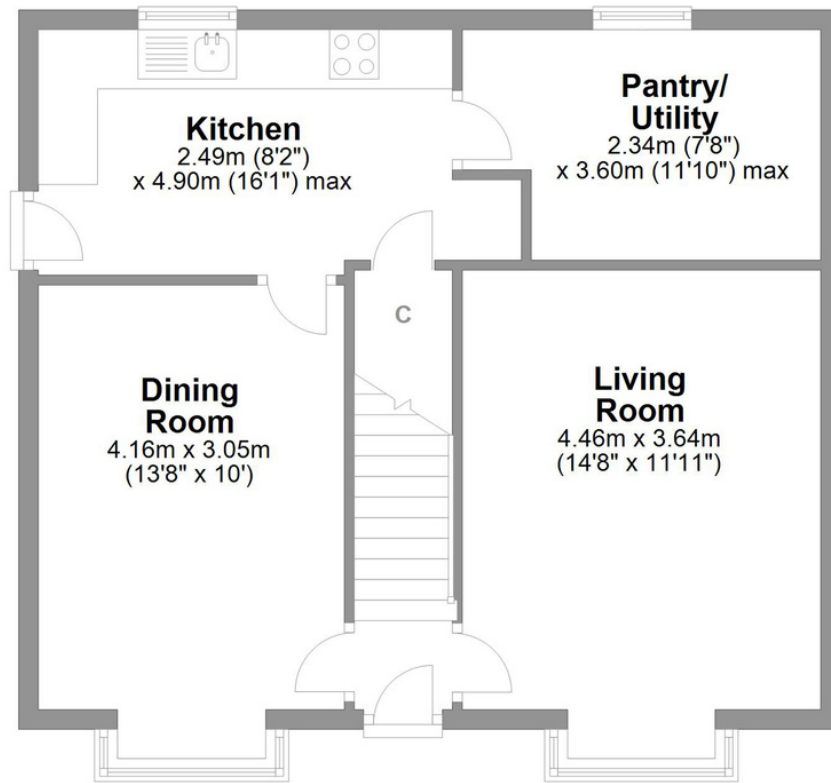

Ground Floor

Approx. 54.7 sq. metres (589.3 sq. feet)

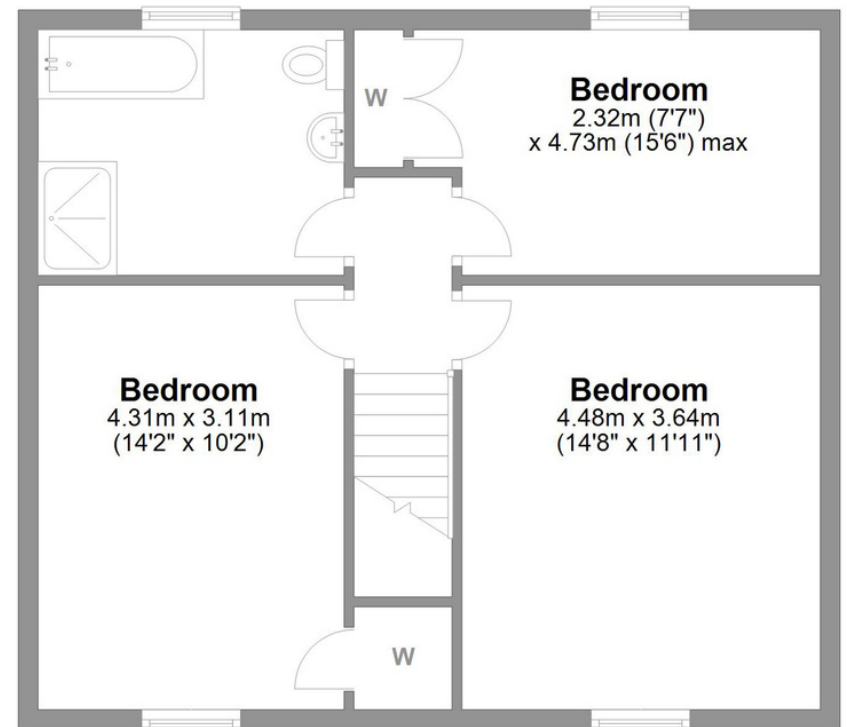

First Floor

Approx. 55.0 sq. metres (591.8 sq. feet)

LOVE PROPERTY.

Whilst every attempt has been made to ensure the accuracy of the floorplans contained here, measurements of doors, windows, rooms and any other items are approximate and no responsibility is taken for any error, omission or mis-statement. This plan is not drawn to scale and is for illustrative purposes only & should be used as such by any prospective purchaser. Created especially for Love Property by Vue3sixty Ltd