

CLEVELAND ROAD

CATTERICK GARRISON

LOVE PROPERTY

LOVE THE JOURNEY





Welcome Home

This home is a two bedroom, brick built, semi-detached property with driveway parking. It's located on Cleveland Road, a great location for first time buyers or families, as you're close by to local shops, schools and only a short drive from the A1.

Park up before heading inside- your hallway comes with storage for tucking shoes away before turning left into your dual aspect living room, which is great for family evenings in.

To the right of the hall is your kitchen/diner, again dual aspect with access to the back garden from here.

Upstairs find two bedrooms with built in wardrobes. Both bedrooms are also dual aspect, the larger a double room with ample space for your bed, side tables and a dresser. The smaller of the two easily fits a three quarter bed, side tables and a dresser.

The family bathroom is found just off the staircase and comes with a bath and overhead electric shower.

Your back garden is a great spot for gardening and enjoying the sunshine, there's ample space here for a greenhouse, shed and outside seating area.







Cleveland Road Catterick Garrison

Total area: approx. 69.8 sq. metres (751.3 sq. feet)

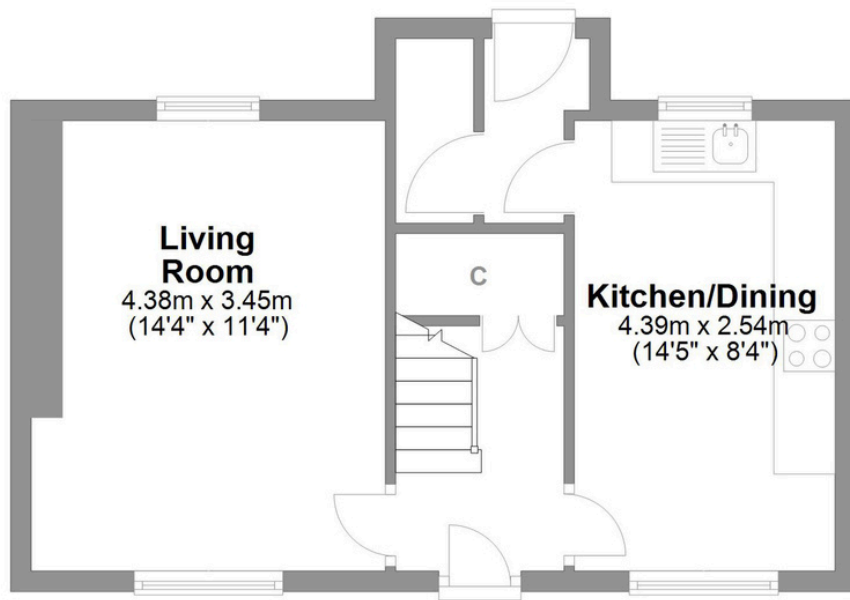

Ground Floor

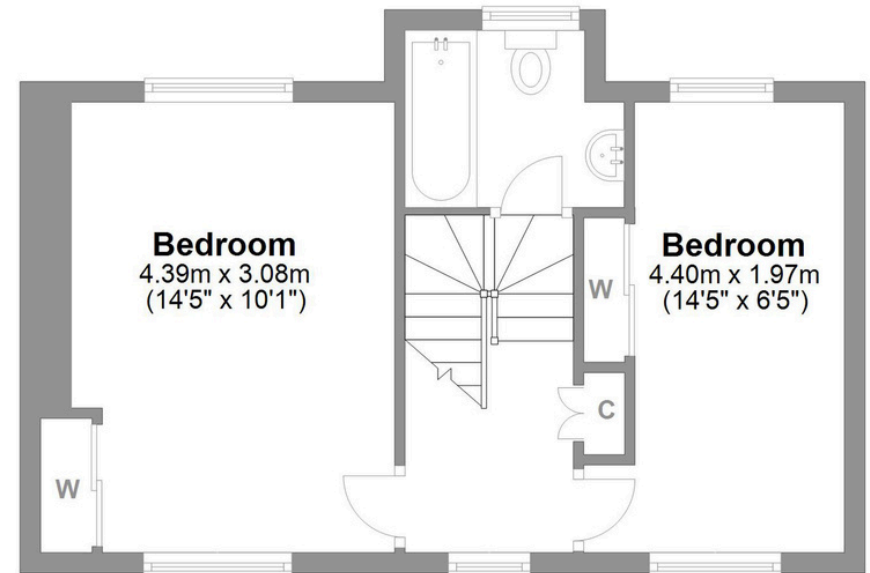

First Floor

LOVE PROPERTY.

Whilst every attempt has been made to ensure the accuracy of the floorplans contained here, measurements of doors, windows, rooms and any other items are approximate and no responsibility is taken for any error, omission or mis-statement. This plan is not drawn to scale and is for illustrative purposes only & should be used as such by any prospective purchaser. Created especially for Love Property by Vue3sixty Ltd