



Hurst Court, Horsham RH12 2EN



LOCATION Centrally located in Horsham Town Centre with the Mainline Train Station, Town Centre and Horsham Park all within a stones throw. Horsham, a thriving historic market town with an excellent selection of national and independent retailers including a large John Lewis and Waitrose store. There are twice weekly award winning local markets in the Carfax in the centre of Horsham for you to stock up on local produce. East Street, or 'Eat Street' as it is known locally, has a wide choice of restaurants. You are spoilt for choice for leisure activities as there is a leisure centre with swimming pool close to Horsham Park, nearby you have two cinemas The Capitol theatre and The Everyman. There are some beautiful walks and cycle rides in the immediate countryside. Further afield, the stunning South Downs and coast are within easy reach. For those needing to commute, Horsham Station has a direct line to Gatwick (17 minutes) and London Victoria (56 minutes) and there is easy access to the M23 leading to the M25

THE PROPERTY A spacious, two bedroom top floor flat, situated in a highly sought after location close to the mainline railway station, Horsham park and town centre . The property benefits from having a good sized entrance hall, two double bedrooms, modern fitted kitchen with integrated appliances, large and bright lounge, and stylish bathroom suite with storage cupboard and washing machine. Other benefits to the property include gas central and double glazing. The property is available early October and offered on an unfurnished basis.

OUTSIDE There is ample communal parking and communal grounds for residents to enjoy.

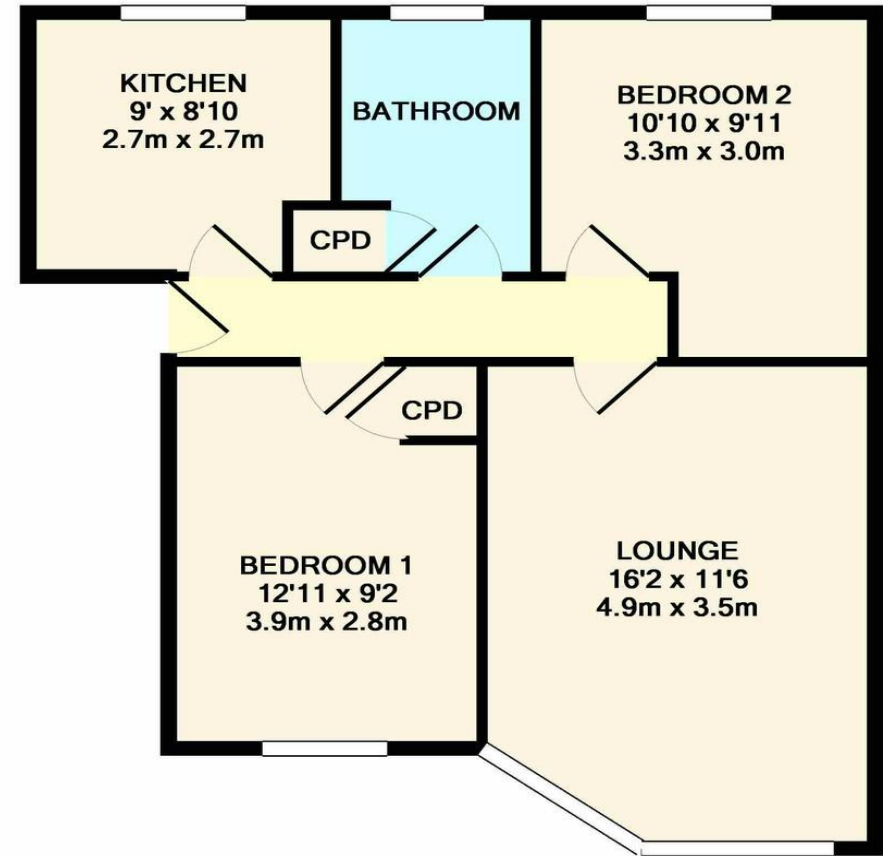

Map Location



EPC Rating

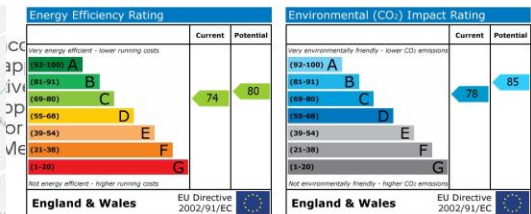

Viewing arrangements by appointment through :

Brock Taylor
01403 272002
horshamlettings@brocktaylor.co.uk

Brock Taylor Disclaimer: we would like to inform prospective purchasers that these sales particulars have been prepared as a general guide only. A detailed survey has not been carried out, nor the services, appliances and fittings tested. Room sizes should not be relied upon for furnishing purposes and are approximate. If floor plans are included they are for guidance only and illustration purposes only and may not be to scale. If there are any important matters likely to affect your decision to buy, please contact us before viewing this property.

**Residential sales, lettings,
land and new homes.**

01403 272002
brocktaylor.co.uk

2-6 East Street, Horsham, West Sussex, RH12 1HL