



Irons Way, Romford, RM5 3RJ

£1,850 Per Calendar Month



****THREE BEDROOM BUNGALOW WITH A LARGE GARDEN, CONSERVATORY & DRIVEWAY – STONES THROW FROM LAWNS PARK, COLLIER ROW****

OC Homes is pleased to offer this three-bedroom semi-detached bungalow, ideally located on the doorstep of Lawns Park and within easy reach of local shops, schools, and public transport links.

This property offers a cosy lounge, fitted kitchen, three bedrooms, three-piece bathroom suite and a conservatory.

Externally, the home benefits from a private driveway for one vehicle, side access, and a large rear garden. (Please note: The garage is not included in the tenancy.)

Available NOW

- SEMI-DETACHED BUNGALOW
- DRIVEWAY
- CONSERVATORY
- LARGE GARDEN
- FITTED KITCHEN
- SIDE ACCESS
- AVAILABLE NOW

Viewing

Please contact our OC Homes Gidea Park Office on 01708989888 if you wish to arrange a viewing appointment for this property or require further information.

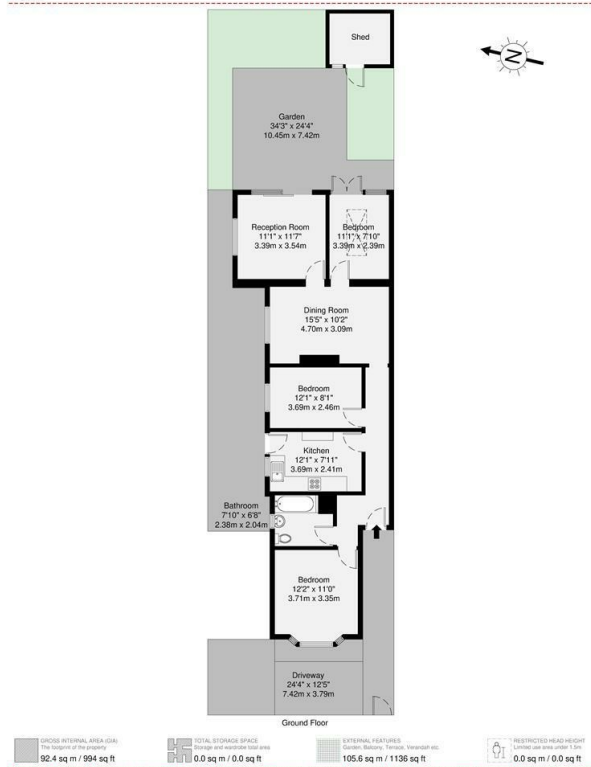

Energy Efficiency Rating		
	Current	Potential
Very energy efficient - lower running costs		
(92 plus) A		
(81-91) B		
(69-80) C		
(55-68) D		
(38-54) E		
(21-38) F		
(1-20) G		
Not energy efficient - higher running costs		
England & Wales	EU Directive 2002/91/EC	

Environmental Impact (CO ₂) Rating		
	Current	Potential
Very environmentally friendly - lower CO ₂ emissions		
(92 plus) A		
(81-91) B		
(69-80) C		
(55-68) D		
(38-54) E		
(21-38) F		
(1-20) G		
Not environmentally friendly - higher CO ₂ emissions		
England & Wales	EU Directive 2002/91/EC	



These particulars, whilst believed to be accurate are set out as a general outline only for guidance and do not constitute any part of an offer or contract. Intending purchasers should not rely on them as statements of representation of fact, but must satisfy themselves by inspection or otherwise as to their accuracy. No person in this firm's employment has the authority to make or give any representation or warranty in respect of the property.