



Mount Bartholomew  
Bonnybridge FK4 1LW

21 Ferniesyde Court, Kinniard Village, Larbert, FK2

Tel: 01324 811235

info@alexander-taylor.co.uk

<https://www.alexander-taylor.co.uk>



Alexander Taylor is delighted to bring to the open market this outstanding three bedroom end terraced Bungalow to the open market. The subjects are set within a quite residential estate which is set close to the popular village of Bonnybridge. The subjects were fully renovated seven years ago and offer, elevated ceiling heights, stunning shower room, with a Rain shower, huge family dining kitchen and spacious lounge, with French Doors<sup>2</sup> off to the rear gardens. There are also three double bedrooms, extensive mature gardens, and parking to accommodate several cars and if you have one, your pride and joy, Motor Home. EPR:E



## NEAREST STATIONS

Larbert Station 2.7 miles

Camelon Station 2.8 miles

Falkirk High Station 3.9 miles

## NEAREST SCHOOLS

Bonnybridge Primary School State

School Rating: N/A 0.2 miles

Antonine Primary School State

School Rating: N/A 0.5 miles

St Joseph's RC Primary School State

School Rating: N/A 0.6 miles

Head Of Muir Primary School State

School Rating: N/A 0.9 miles

Alexander Taylor is delighted to bring to the open market this outstanding three bedroom end terraced Bungalow to the open market. The subjects are set within a quite residential estate which is set close to the popular village of Bonnybridge. The subjects were fully renovated seven years ago and offer, elevated ceiling heights, stunning shower room, with a Rain shower, huge family dining kitchen and spacious lounge, with French Doors2 off to the rear gardens. There are also three double bedrooms, extensive mature gardens, and parking to accommodate several cars and if you have one, your pride and joy, Motor Home.

**Lounge**  
12'3" x 14'0"

**Dining Kitchen**  
11'2" x 11'11"

**Master Bedroom**  
10'9" x 13'11"

- Outstanding condition throughout
- Modern decor through out
- Fully upgraded in 2015
- New boiler installed 2015
- New windows
- Inclusion of French Doors to Lounge
- Wooden shutters throughout
- Stunning cream High Gloss Kitchen
- All Appliances are included within the sale
- Fitted robes to all bedrooms

**Bedroom Two**  
8'8" x 13'10"

**Bedroom Three**  
8'5" x 13'11"

**Shower Room**

GROUND FLOOR  
991 sq.ft. (92.0 sq.m.) approx.

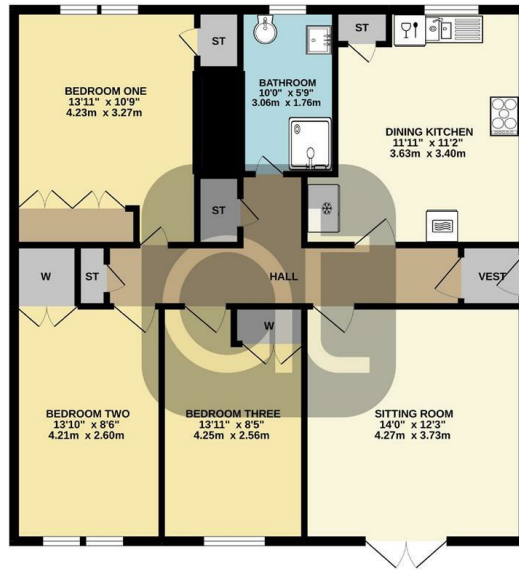

TOTAL FLOOR AREA: 991 sq.ft. (92.0 sq.m.) approx.  
 Whilst every attempt has been made to ensure the accuracy of the floorplan contained here, measurements of each bedroom, room and any other areas are approximate and no responsibility is taken for any error, omission or misstatement. This plan is for illustrative purposes only and should be used in conjunction with any comprehensive measurements. The accuracy, completeness and reliability of the information is not guaranteed. All dimensions are approximate and should be used as a guide only.  
 Made with Metaplex 12/22



**Disclaimer**  
 These property details are set as a general outline only and do not constitute any part of an offer or contract. Any services, equipment, fittings or central heating systems have not been tested and no warranty is given or implied that these are in working order. Buyers are advised to obtain verification from their solicitor or surveyor. Fixtures, fittings and other items are not included unless specifically described. All measurements, distances and areas are approximate and are for guidance only. Room measurements are taken to the nearest 10cm and prospective buyers are advised to check these for any particular purpose, e.g. fitted carpets and furniture. This material is protected by the laws of copyright. The owner of the copyright is Alexander Taylor Estate Agents Ltd.

Viewing strictly by appointment with the Agent.



21 Ferniesyde Court, Kinniard Village, Larbert, FK2  
**Tel: 01324 811233**  
 info@alexander-taylor.co.uk  
<https://www.alexander-taylor.co.uk>