

31 Stonechat Road, Billericay – CM11 2NZ

£585,000 Freehold

Spacious 5-bed detached house in Billericay with NO ONWARD CHAIN! Features 3 reception areas, 2 bathrooms, sunny south facing garden, ample parking and close to schools & transport links.

Council Tax band: F ~ EPC Energy Efficiency Rating: C



tyler estates

01277 626181

www.tylerestates.co.uk



Entrance Porch

Lounge: 11' 10" x 19' 4" (3.61m x 5.89m)

Inner Hallway: 5' 9" x 11' 3" (1.75m x 3.43m)

Dining Room: 12' 10" x 8' 10" (3.91m x 2.69m)

Family Room: 8' 9" x 13' 10" (2.67m x 4.22m)

Kitchen: 10' 4" x 10' 2" (3.15m x 3.10m)

WC

Bedroom One: 12' 6" x 12' 2" (3.81m x 3.71m)

Bedroom Two: 12' 2" x 9' 7" (3.71m x 2.92m)

Bedroom Three: 12' 2" x 9' 6" (3.71m x 2.90m)

Bedroom Four: 13' 0" x 6' 11" (3.96m x 2.11m)

Bedroom Five: 8' 10" x 13' 10" (2.69m x 4.22m)

En-Suite

Bathroom: 6' 2" x 6' 1" (1.88m x 1.85m)

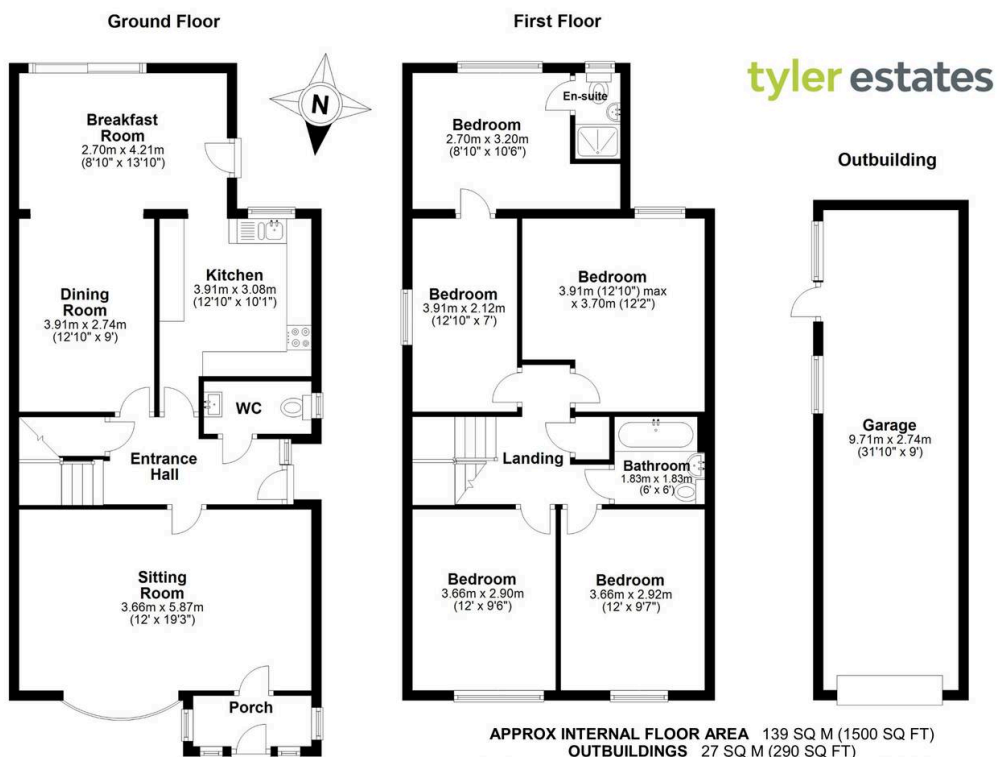

APPROX INTERNAL FLOOR AREA 139 SQ M (1500 SQ FT)
OUTBUILDINGS 27 SQ M (290 SQ FT)
This floorplan is for illustrative purposes only and is **NOT TO SCALE**
All measurements are approximate **NOT** to be used for valuation purposes
Copyright Tyler Estates 2025