

Aqua Drive, Hampton Water, PE7 8QN



Three Bedrooms



72 sqm / 775 sqft



Family Bathroom and
Downstairs WC



Step inside this family home at Hampton Water, Peterborough.

Upon entrance is a hall with access to the downstairs cloakroom and leading into the lounge. The lounge is of a good size for family socialising and is well lit by a window to the front of which is framed by stylish shutters, a storage cupboard sits below the stairs. To the rear of the property is the kitchen and dining room, featuring integrated fridge/freezer, washing machine and dishwasher, and french doors leading onto the garden. Downstairs has been fitted with Amtico durable luxury vinyl tile flooring throughout.

Upstairs is home to three bedrooms two of which are great sized double bedrooms, with bedroom two being fitted with a built in double wardrobe. Bedroom three is a good sized single room and offers views onto the rear garden. The family bathroom sits at the front of the property and has been finished with modern sanitaryware including a shower over bath and stylish tiling, and houses a large storage cupboard.

Externally the home boasts a good sized rear garden mostly laid to lawn with contemporary patio and a further decked area providing outside social space. The rear garden can be accessed via a side gate to the front of the home or a gate to the rear of the garden leading onto the parking area. To the side of the property is allocated parking for two vehicles plus a access to two visitor parking spaces.

Measurements:

Entrance Hall - 2.05m x 0.94m / 6'9" x 3'1"

WC - 1.93 x 0.83m / 6'4" x 2'9"

Lounge - 4.26m x 3.55m / 13'12" x 11'8"

Kitchen - 4.43m x 2.59m / 14'6" x 8'6"

Bedroom One - 3.59m x 2.34m / 11'9" x 7'8"

Bedroom Two - 3.27m x 2.35m / 10'9" x 7'9"

Bedroom Three - 2.58m x 1.89m / 8'6" x 6'2"

Bathroom - 3.29m x 1.88m / 10'10" x 6'2"

- Three Bedrooms
- Semi-detached Home
- Less than 3 years old
- Downstairs WC
- Off Road Parking for Two

Ground Floor

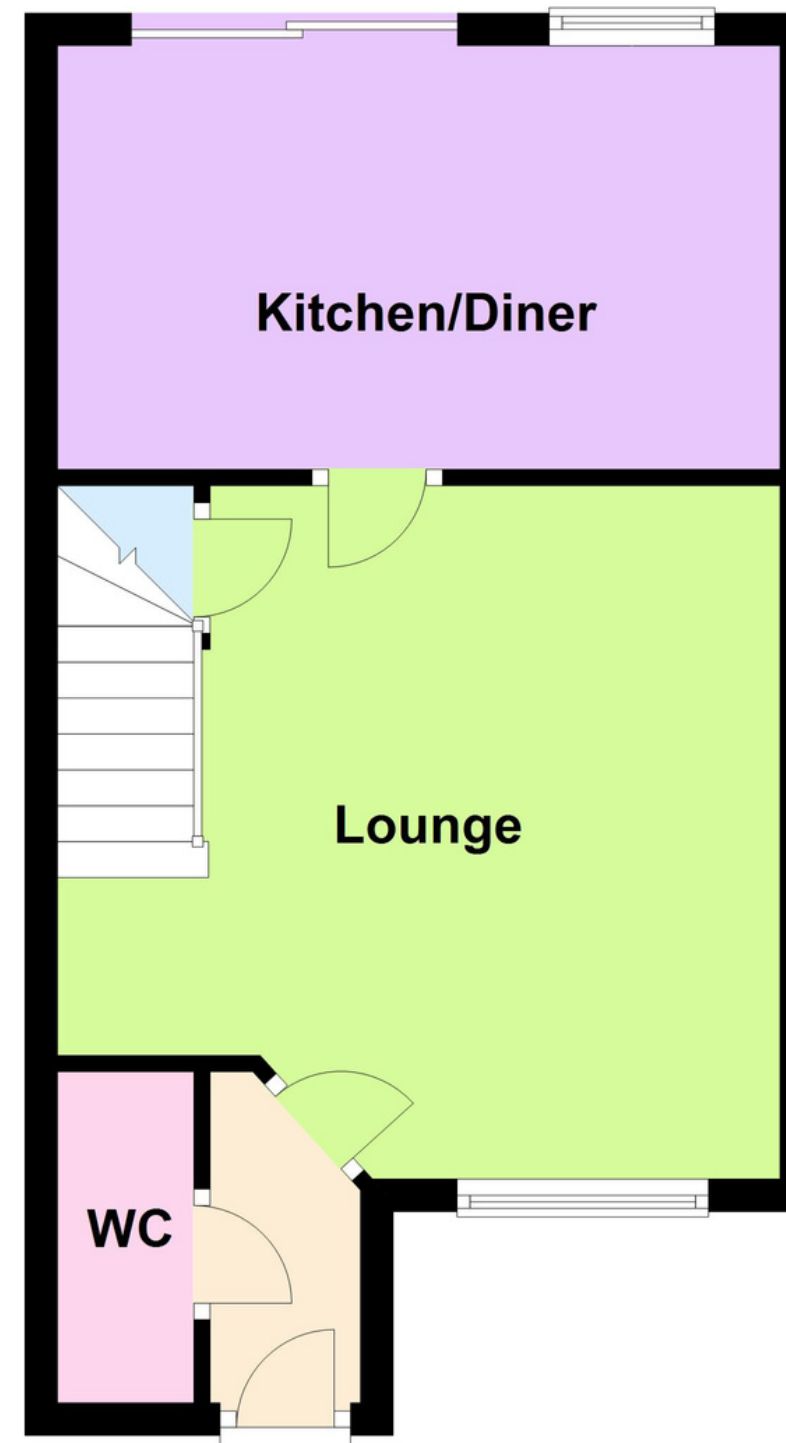

First Floor

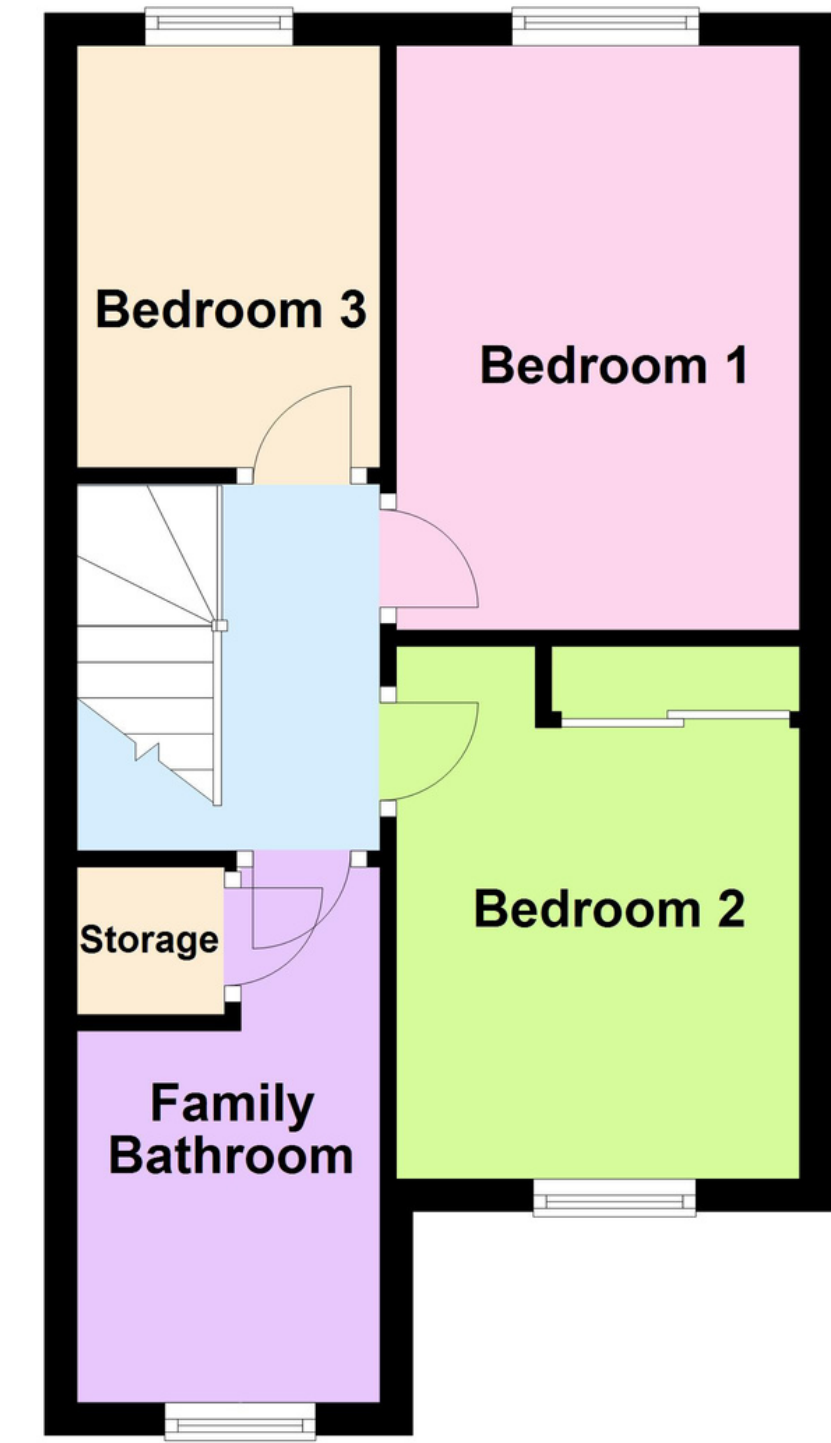

Score	Energy rating	Current	Potential
92+	A		97 A
81-91	B	84 B	
69-80	C		
55-68	D		
39-54	E		
21-38	F		
1-20	G		

To hear more about Aqua Drive
Please call 01733 893 520