

Farm Close, Borehamwood WD6 4TX

Offers In Excess Of £400,000

STUNNING TWO BEDROOM HOME - PARKING - UNDERFLOOR HEATING

This stunning two bedroom mid terrace house located in Farm Close, Borehamwood is move in ready. Perfect for first time buyers or investors looking to move straight in, then look no further.

Offering a modern home lovingly refurbished by the current owners to a very high standard with superb finishing touches throughout.

Features include oak flooring throughout and modern oak and glass staircase, fully integrated kitchen, inset spotlights throughout, underfloor heating, fully tiled family bathroom, off street parking and low maintenance rear garden.

To arrange an early recommended viewing please contact Benjamin Stevens.

Farm Close, Borehamwood WD6 4TX

Farm Close

Exterior

Reception room

Reception room alternate view

Kitchen

Garden

Alternate view garden

Rear patio

Master bedroom

Bedroom two

Bathroom

Parking

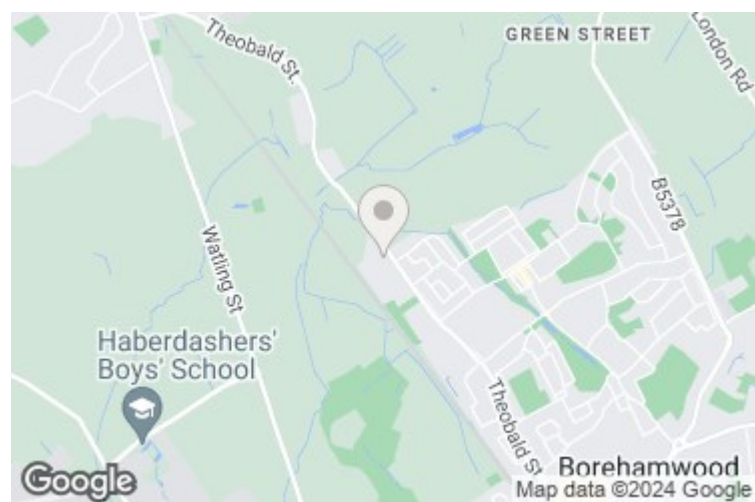

GROUND FLOOR
306 sq.ft. (28.4 sq.m.) approx.

1ST FLOOR
286 sq.ft. (26.6 sq.m.) approx.

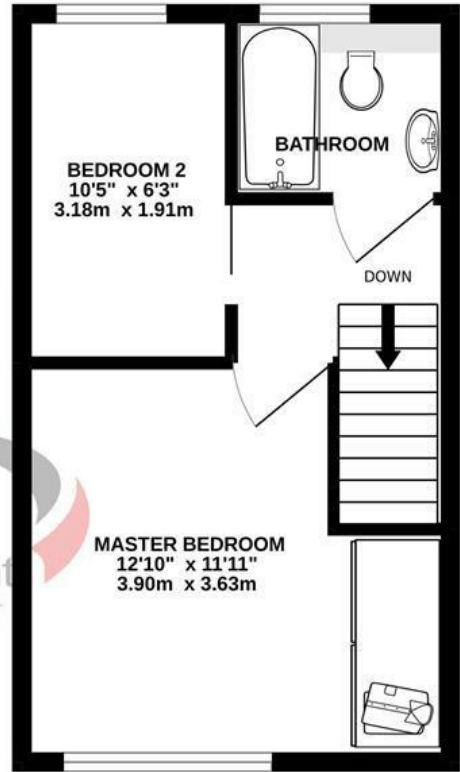
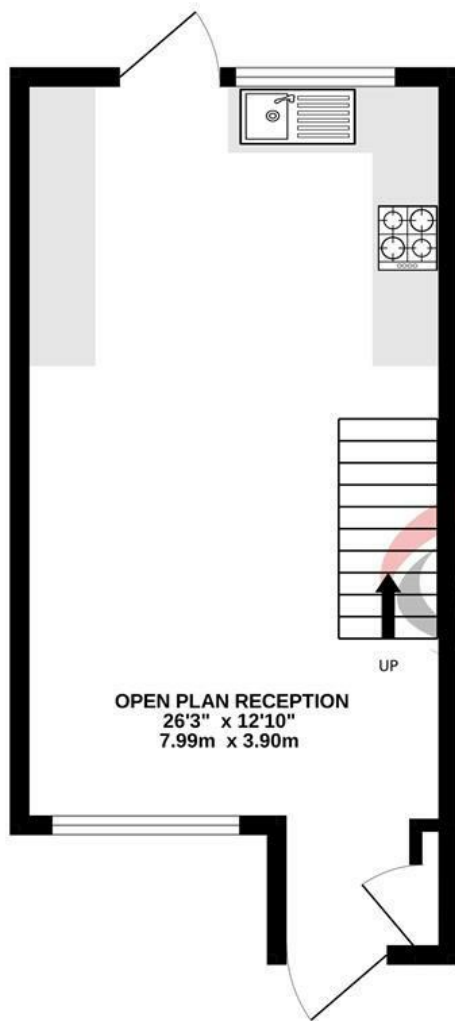

TWO BEDROOM MID TERRACE HOUSE

TOTAL FLOOR AREA : 592 sq.ft. (55.0 sq.m.) approx.

Whilst every attempt has been made to ensure the accuracy of the floorplan contained here, measurements of doors, windows, rooms and any other items are approximate and no responsibility is taken for any error, omission or mis-statement. This plan is for illustrative purposes only and should be used as such by any prospective purchaser. The services, systems and appliances shown have not been tested and no guarantee as to their operability or efficiency can be given.
Made with Metropix ©2022

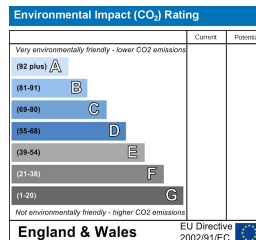
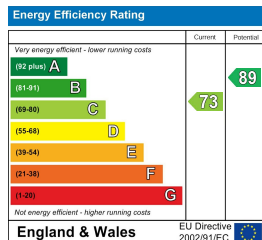

Edgware Office- 194 Station Road, Edgware, HA8 7AT. Tel: 020 8958 1118
 Bushey Heath Office- 59 High Road, Bushey, WD23 1EE. Tel: 020 8950 7777
www.benjaminstevens.co.uk