



## 24 Glengall Road, Edgware, HA8 8ST

### **Offers In Excess Of £749,950**

**\*\*Chain Free\*\***

An extended Three Bedroom, Two Bathroom Detached Bungalow situated on this corner plot.

Accommodation comprises spacious through-lounge reception room, 2nd reception room, large separate kitchen, three bedrooms, two bathrooms (one en-suite).

Features include a large boarded loft, en-suite to bedroom one, carriage driveway with ample off street parking, and south-west facing private garden.

An early viewing is highly recommended via vendor's agents Benjamin Stevens - call now to view!



## Porch

**Large Through-Lounge Reception 22'2 x 16'8  
(6.76m x 5.08m)**



## Kitchen (alternate view)



**Reception Two 20'2 x 9'10 (6.15m x 3.00m)**

## Reception (alternate view)



Underfloor heating, patio doors to garden, skylights, double glazed rear aspect windows, door to boiler cupboard,

**Kitchen 15'4 x 9'1 (4.67m x 2.77m)**



Under floor heating, range of wall and base units, granite worktops, five ring Range-Master double oven, double sink unit with drainer, side aspect window, door to 2nd reception room.

**Bedroom One 17'5 (max) x 13'1 (max) (5.31m  
(max) x 3.99m (max))**



Walk in wardrobe.



**Bedroom Two 14'7 (into bay) x 11'2 (4.45m (into bay) x 3.40m)**



Underfloor heating.

**Bedroom Three / Study 10'10 (max) x 7'6 (max) (3.30m (max) x 2.29m (max))**



**Family bathroom**



Panelled bath with mixer tap and shower attachment, wash hand basin, low level WC and frosted side aspect window.

**En-suite shower room**



Shower, low level WC, wash hand basin, heated towel rail.

**Garden**



South-West facing, mainly laid to lawn, with a large decked area.

**Rear aspect**



# Floor Plan

GROUND FLOOR  
1184 sq.ft. (110.0 sq.m.) approx.

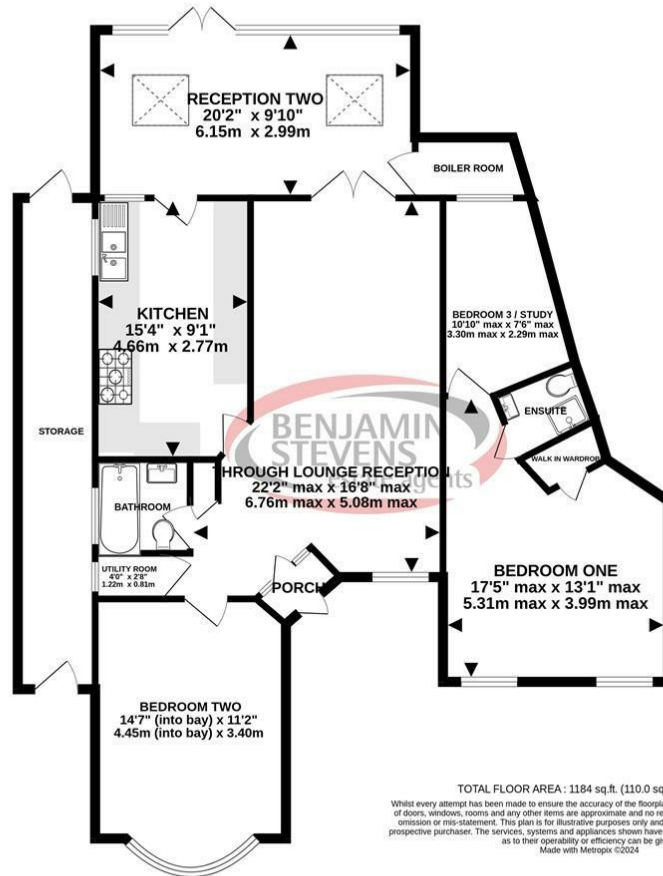

# Area Map



# Energy Efficiency Graph

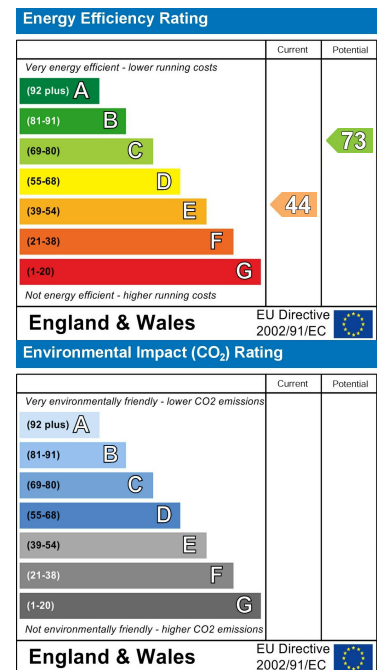

These particulars, whilst believed to be accurate are set out as a general outline only for guidance and do not constitute any part of an offer or contract. Intending purchasers should not rely on them as statements of representation of fact, but must satisfy themselves by inspection or otherwise as to their accuracy. No person in this firm's employment has the authority to make or give any representation or warranty in respect of the property.



Edgware Office- 194 Station Road, Edgware, HA8 7AT. Tel: 020 8958 1118  
 Bushey Heath Office- 59 High Road, Bushey, WD23 1EE. Tel: 020 8950 7777  
[www.benjaminstevens.co.uk](http://www.benjaminstevens.co.uk)