



533 Whippendell Road, Watford WD18 7QF

Asking Price £299,950

A TWO BEDROOM SECOND FLOOR APARTMENT forming part of this sought after purpose built block conveniently located and within walking distance to all local shopping and transport facilities. The property is being offered in good decorative order and benefits from: Security Entryphone System, Double Glazed Windows, Gas Fired Heating To Radiators, Reception Room With Open Plan Modern Kitchen, Two Bedrooms, Bathroom, Communal Grounds, Allocated Parking.

SHARE OF FREEHOLD
NO UPPER CHAIN

533 Whippendell Road, Watford WD18 7QF

Exterior:



Kitchen:



Reception Room:



Bedroom One:



Reception Room:



Bedroom Two:



Bathroom:



Tenure:

This is a Share Of Freehold property and the seller advises us that, to the best of their knowledge, there are approximately 990 years remaining on the lease and there is a service charge of approximately £2,000 Per Annum
Council Tax Band C £1897 per annum.
As always buyers are advised to gain verification from their surveyor/solicitor during the conveyancing process.

Disclaimer:

While every care and effort has been made to ensure these details are correct their accuracy cannot be guaranteed and so should not form part of any contract.

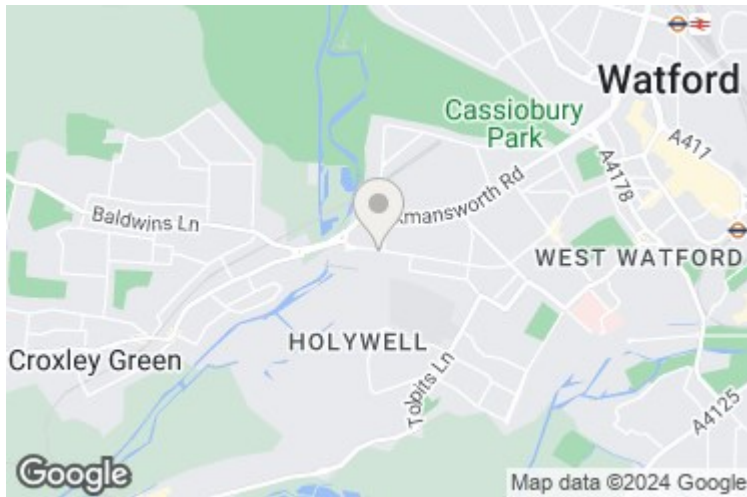

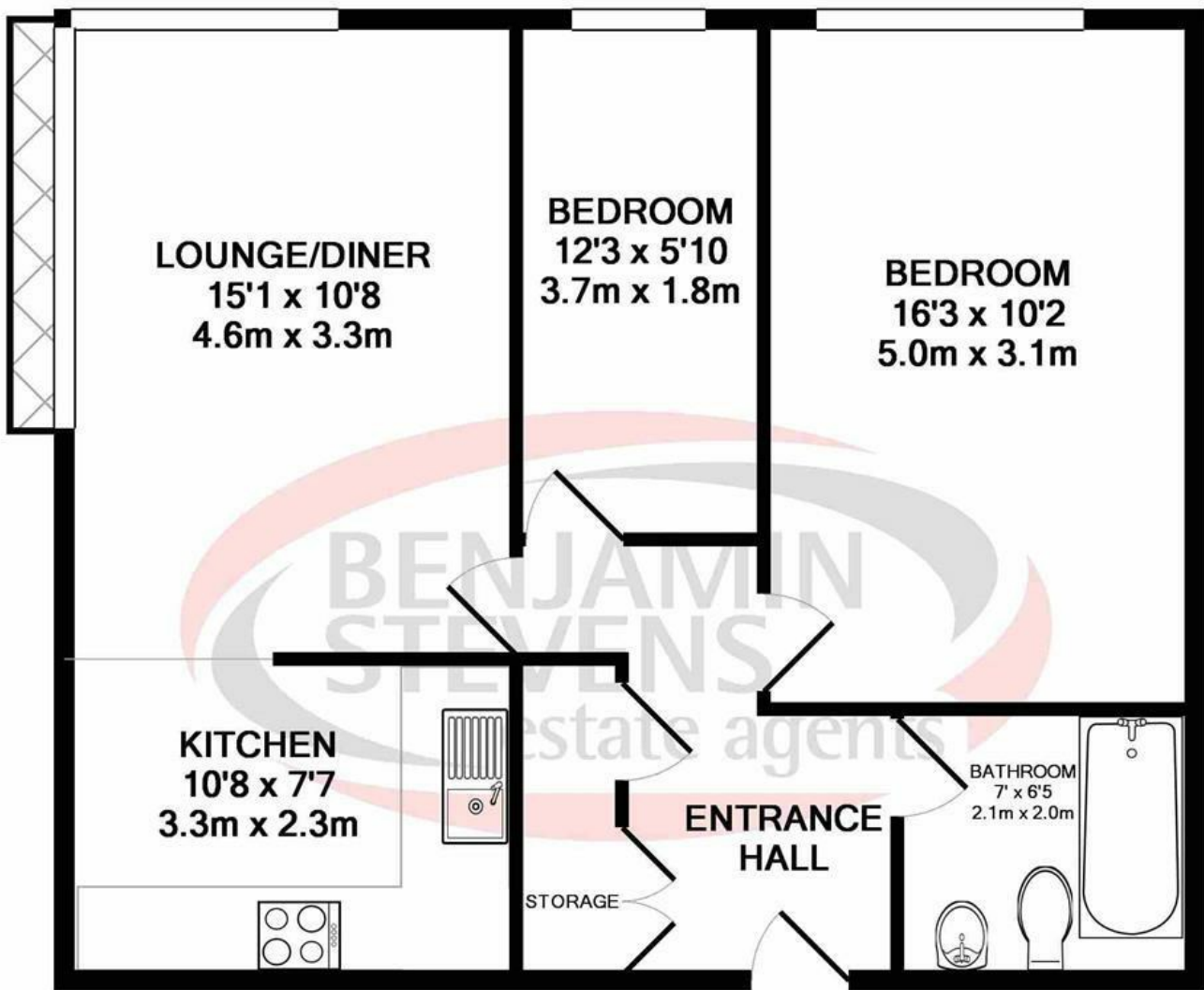

TOTAL APPROX. FLOOR AREA 605 SQ.FT. (56.2 SQ.M.)

Whilst every attempt has been made to ensure the accuracy of the floor plan contained here, measurements of doors, windows, rooms and any other items are approximate and no responsibility is taken for any error, omission, or mis-statement. This plan is for illustrative purposes only and should be used as such by any prospective purchaser. The services, systems and appliances shown have not been tested and no guarantee as to their operability or efficiency can be given

Made with Metropix ©2019

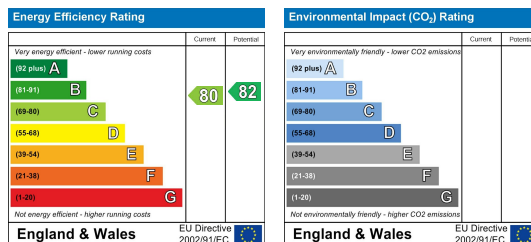

Edgware Office- 194 Station Road, Edgware, HA8 7AT. Tel: 020 8958 1118
 Bushey Heath Office- 59 High Road, Bushey, WD23 1EE. Tel: 020 8950 7777
www.benjaminstevens.co.uk