



43 Holly Street, Luton, LU1 3DD

£1,100 PCM

Benjamin Stevens are please to offer a two bedroom flat located in the sought after area of New Town. The property comprises a open plan reception/kitchen, family bathroom, two double bedrooms, en-suite and balcony. Other features include a snug, double glazed windows and a fitted kitchen.

The property is ideally located just a stones throw away from the Luton town centre, which hosts a range of amenities such as local shops, restaurants and pubs.

Transport links include local bus routes, the Luton train station and great links to the M1.

This fantastic home can be offered furnished or unfurnished and will be available from February 2022.

External



Kitchen



Reception Room



Doors leading to balcony, laid to carpet, double glazed windows to the front aspect.

Snug



Laid to carpet, double glazed windows to front and side access.

Range of wall and base units, electric cooker with extractor fan, stainless steel sink with mixer tap and drainer board, washing machine, dishwasher, fridge freezer and tiled throughout.

Bedroom One



Door leading to en-suite, laid to carpet and double glazed window to the front aspect.

En-suite



Walk in shower, wall attached pedestal sink with mixer taps, low level w/c, tiled throughout.

Bedroom Two



Laid to carpet and double glazed window to the front aspect.

Family Bathroom



Panelled bath with mixer taps and shower attachment, low level W/C, wall attached pedestal sink, vanity mirror and tiled throughout.

Floor Plan

FIRST FLOOR
725 sq.ft. (67.4 sq.m.) approx.

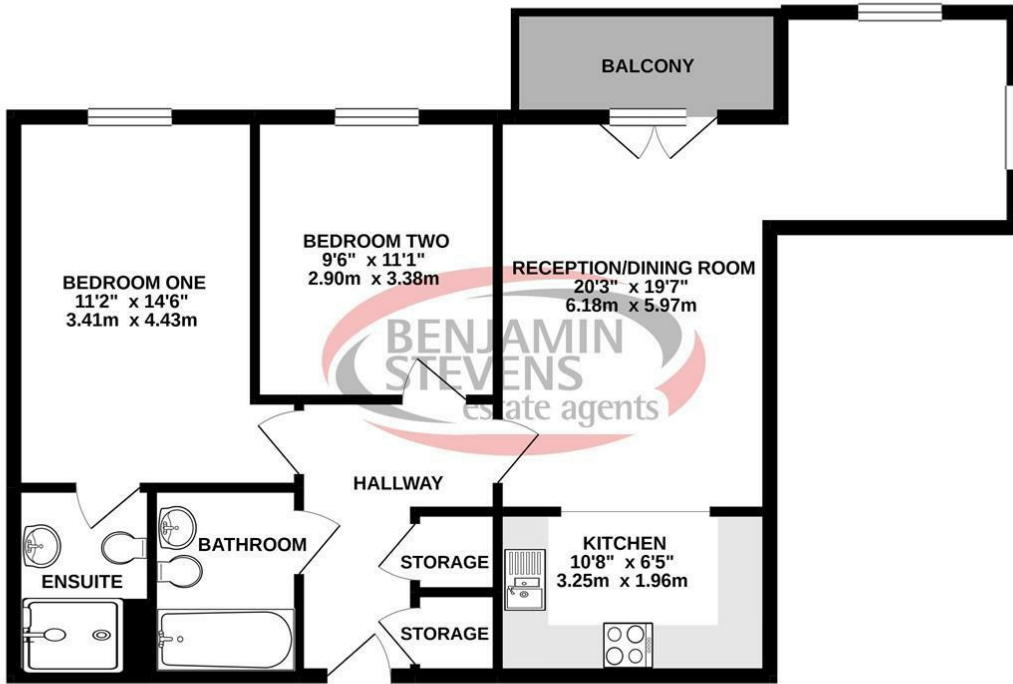

TOTAL FLOOR AREA : 725 sq.ft. (67.4 sq.m.) approx.

Whilst every attempt has been made to ensure the accuracy of the floorplan contained here, measurements of doors, windows, rooms and any other items are approximate and no responsibility is taken for any error, omission or mis-statement. This plan is for illustrative purposes only and should be used as such by any prospective purchaser. The services, systems and appliances shown have not been tested and no guarantee as to their operability or efficiency can be given.
Made with Metropix ©2021

Area Map



Energy Efficiency Graph

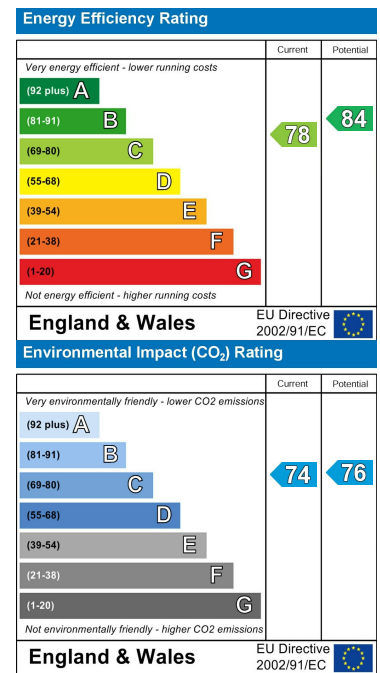

These particulars, whilst believed to be accurate are set out as a general outline only for guidance and do not constitute any part of an offer or contract. Intending purchasers should not rely on them as statements of representation of fact, but must satisfy themselves by inspection or otherwise as to their accuracy. No person in this firm's employment has the authority to make or give any representation or warranty in respect of the property.



Edgware Office- 194 Station Road, Edgware, HA8 7AT. Tel: 020 8958 1118
 Bushey Heath Office- 59 High Road, Bushey, WD23 1EE. Tel: 020 8950 7777
www.benjaminstevens.co.uk