



6 Hardwick Road
Redhill

Offers Over **£450,000**



6 Hardwick Road

Meadvale

Introducing this charming three bedroom semi-detached house situated in a desirable location. This Victorian property is presented in good order throughout and offers a warm and inviting ambience.

The accommodation features three bedrooms, including two generously sized doubles and a third bedroom accessed via bedroom two, offering versatility for various living arrangements. The property boasts two reception rooms, providing ample space for relaxation and entertainment, and a convenient ground floor bathroom. With the added appeal of no onward chain, this home is ready for new occupants to make their mark and create lasting memories.

Step outside and discover the expansive outdoor space that complements this beautiful home. The large rear garden provides a tranquil retreat, perfect for enjoying al fresco dining, entertaining guests, or simply unwinding amidst nature's beauty. The well-maintained garden presents an opportunity for gardening enthusiasts to further enhance the outdoor oasis, creating a space that reflects their personal style and preferences. Whether you envision summer BBQs with loved ones or peaceful mornings sipping coffee in the fresh air, this property offers endless possibilities for embracing outdoor living at its best. Embrace a lifestyle of comfort and convenience in this delightful semi-detached house, where indoor charm meets outdoor serenity, promising a harmonious living experience for the discerning homeowner.

Council Tax band: C

Tenure: Freehold





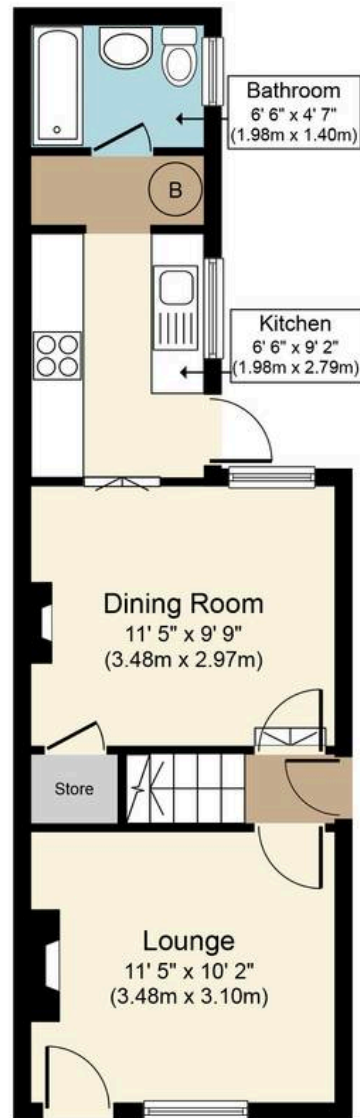

Ground Floor
Approximate Floor Area
377 sq. ft.
(35.0 sq. m.)

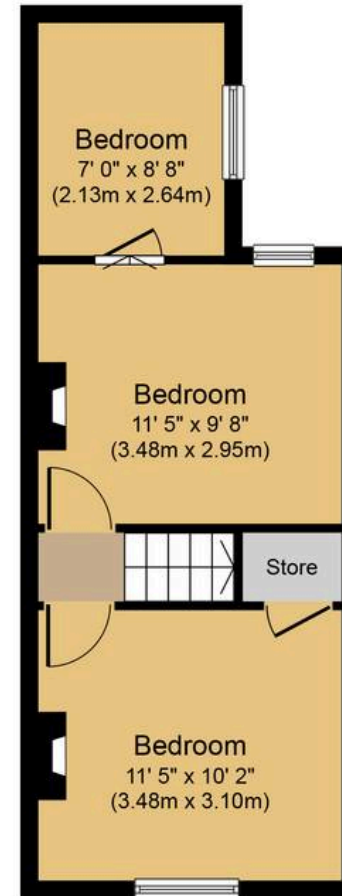

First Floor
Approximate Floor Area
328 sq. ft.
(30.5 sq. m.)

Hardwick Road, RH1

Approx. Gross Internal Floor Area 705 sq. ft. (65.5 sq. m.)



Whilst every attempt has been made to ensure the accuracy of the floor plan contained here, measurements of doors, windows, rooms and any other items are approximate and no responsibility is taken for any error, omission, or mis-statement. The measurements should not be relied upon for valuation, transaction and/or funding purposes. This plan is for illustrative purposes only and should be used as such by any prospective purchaser or tenant. The services, systems and appliances shown have not been tested and no guarantee as to their operability or efficiency can be given.

Copyright Property Portraits | www.propertyportraits.co.uk