



CHARLES KNIGHT  
ESTATE AGENTS



## 6 Yew Tree Close

, London, SE13 7DS

£2,500 Per month

Charles Knight are proud to present this three bedroom property located in Lewisham. The property consists of a spacious reception room, three good size bedrooms, a three piece bathroom suite, separate w/c downstairs, a fully fitted kitchen with rear garden. Located near Lewisham Station and DLR which makes it conveniently placed for commuting into the London and the City. With great local amenities close by as well as schools and Lewisham Hospital within easy reach.

EPC Rating: B

Council Tax - Lewisham Borough

Band: C

### Viewing

Please contact our Lewisham Office on 02088 524441 if you wish to arrange a viewing appointment for this property or require further information.



3



1



1

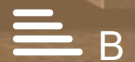

B

## Floor Plan

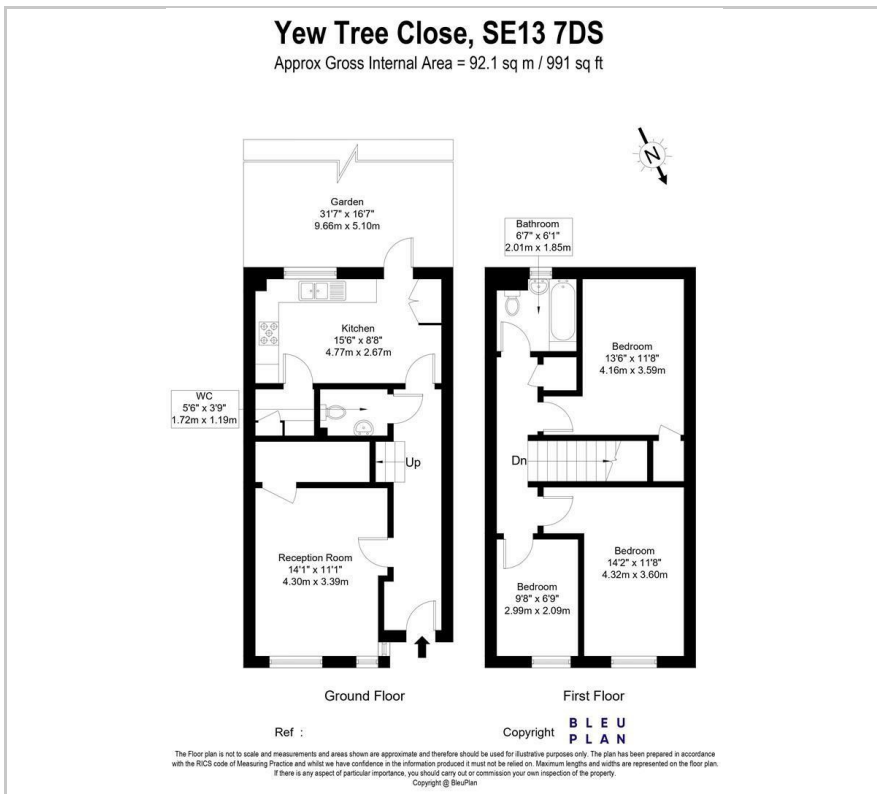

## Area Map

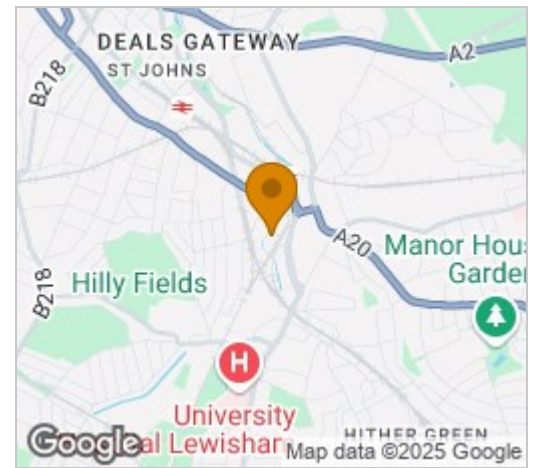

## Energy Efficiency Graph

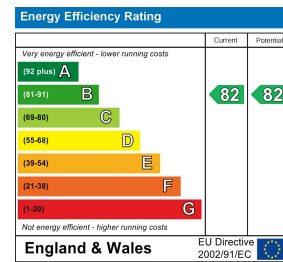

These particulars, whilst believed to be accurate are set out as a general outline only for guidance and do not constitute any part of an offer or contract. Intending purchasers should not rely on them as statements of representation of fact, but must satisfy themselves by inspection or otherwise as to their accuracy. No person in this firm's employment has the authority to make or give any representation or warranty in respect of the property.