



CHARLES KNIGHT
ESTATE AGENTS



34 Conningham Court Dowding Drive , London, SE9 6AY Asking price £450,000

Modern Three-Bedroom Apartment in the Heart of Kidbrooke Village

Discover contemporary living at its finest with this stylish and spacious three-bedroom apartment, perfectly situated in the vibrant Kidbrooke Village.

Boasting sleek, modern interiors and an open-plan living and dining area, this beautifully presented home offers both comfort and functionality. Generous built-in storage and access to meticulously maintained communal gardens add to its appeal, along with the convenience of allocated parking.

An exceptional bonus: the first five years of service charges are included in the purchase price.

Ideally located just moments from Kidbrooke Station, with excellent transport links, local shops, and highly regarded schools nearby—this property is a fantastic opportunity for families and professionals seeking a well-connected, move-in-ready home.

Lease: (985 Years)
London Borough of Greenwich
EPC Rating: B

Viewing

Please contact our Lewisham Office on 02088 524441 if you wish to arrange a viewing appointment for this property or require further information.



3



2



1

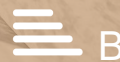

B

Floor Plan

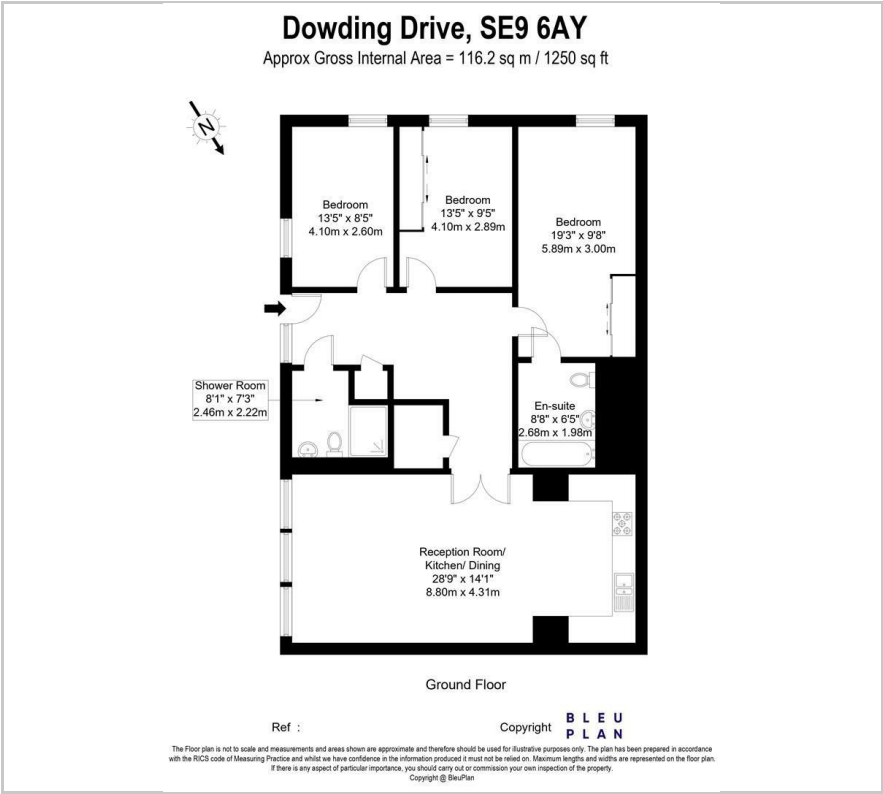

Area Map



Energy Efficiency Graph

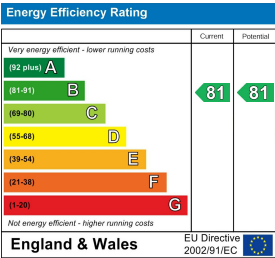

These particulars, whilst believed to be accurate are set out as a general outline only for guidance and do not constitute any part of an offer or contract. Intending purchasers should not rely on them as statements of representation of fact, but must satisfy themselves by inspection or otherwise as to their accuracy. No person in this firms employment has the authority to make or give any representation or warranty in respect of the property.