



CHARLES KNIGHT  
ESTATE AGENTS



43 Meadowside  
, London, SE9 6BS  
£475,000



2



2



1



c



# 43 Meadowside



## Description

**GUIDE PRICE: £475,000 - £500,000** Located in the heart of the award-winning Kidbrooke Village development, this modern and spacious apartment spans approximately 880 sq ft and showcases a sleek, contemporary design throughout.

The development is exceptionally well-maintained, offering residents beautifully landscaped communal gardens and direct access to Sutcliffe Park and the nearby Cator Park — a designated local nature reserve and proud holder of a Green Flag award.

Perfect for commuters, Kidbrooke Station is just half a mile away, providing fast and frequent links to key London stations including London Bridge (15 minutes), Victoria, Charing Cross, Waterloo East and Cannon Street.

The property features two generous double bedrooms, including a master with en-suite, a stylish family bathroom, and a large open-plan kitchen/living area that opens out to a private 20-foot balcony — ideal







Floor Plan

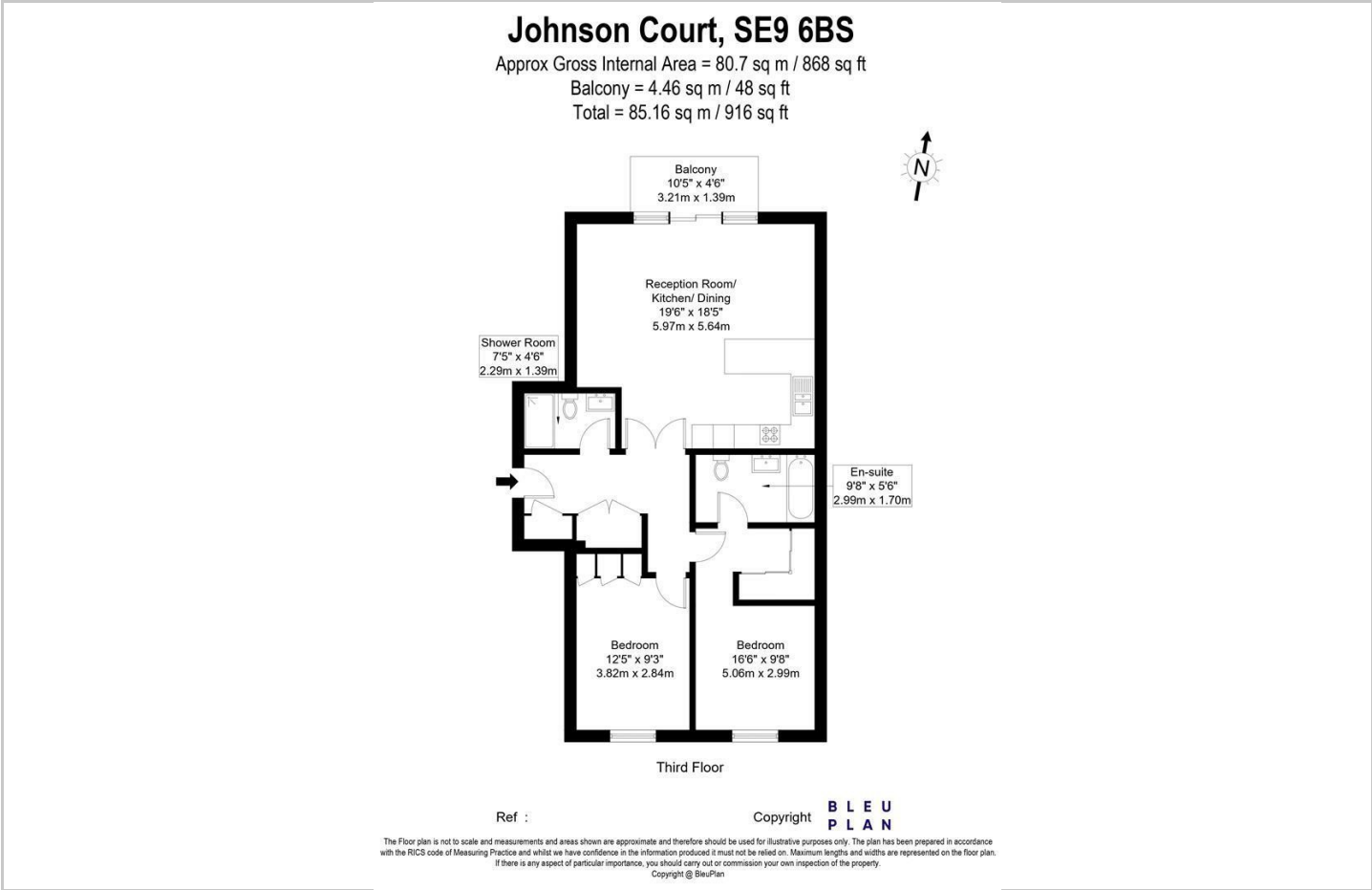

Area Map

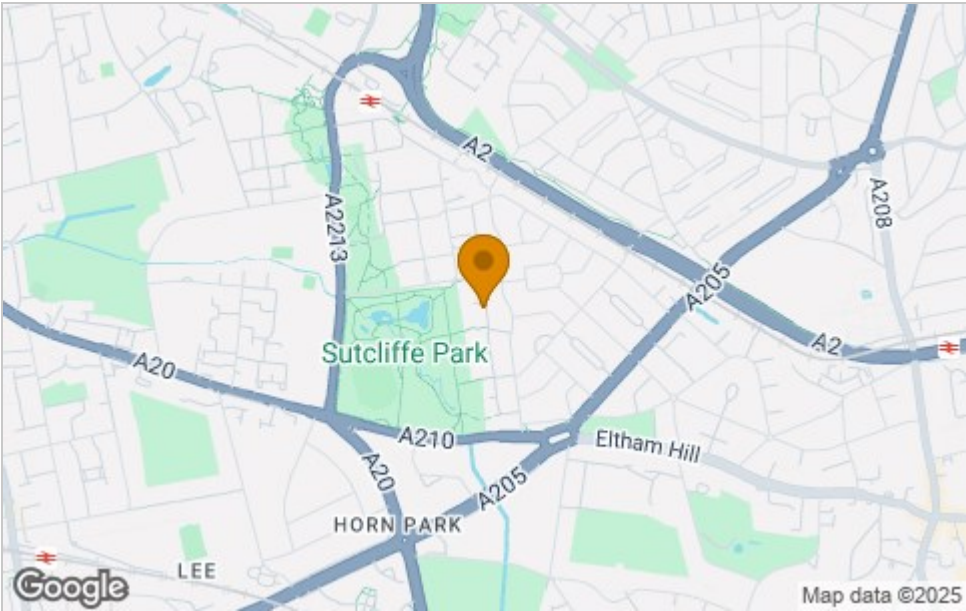

Energy Efficiency Graph

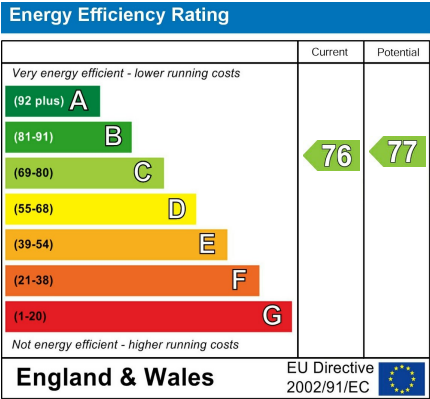

Viewing

Please contact our Lewisham Office on 02088 524441 if you wish to arrange a viewing appointment for this property or require further information.

These particulars, whilst believed to be accurate are set out as a general outline only for guidance and do not constitute any part of an offer or contract. Intending purchasers should not rely on them as statements of representation of fact, but must satisfy themselves by inspection or otherwise as to their accuracy. No person in this firms employment has the authority to make or give any representation or warranty in respect of the property.