



19 Leaside Court

The Larches, Hillingdon, Middlesex, UB10 0DD

Guide Price £135,000

RETIREMENT FLAT FOR OVER 55's. Andrews Residential are pleased to offer for sale this two-bedroom, GROUND FLOOR retirement apartment situated in a popular over 55's development. The property is located just off Long Lane and offers easy access to local shops and bus routes. Benefits include on site warden, emergency pull cords, communal morning room and residential parking. Circa 65-year lease.



Leaside Court UB10

Approximate Gross Internal Floor Area = 49.3 sq m / 532 sq ft

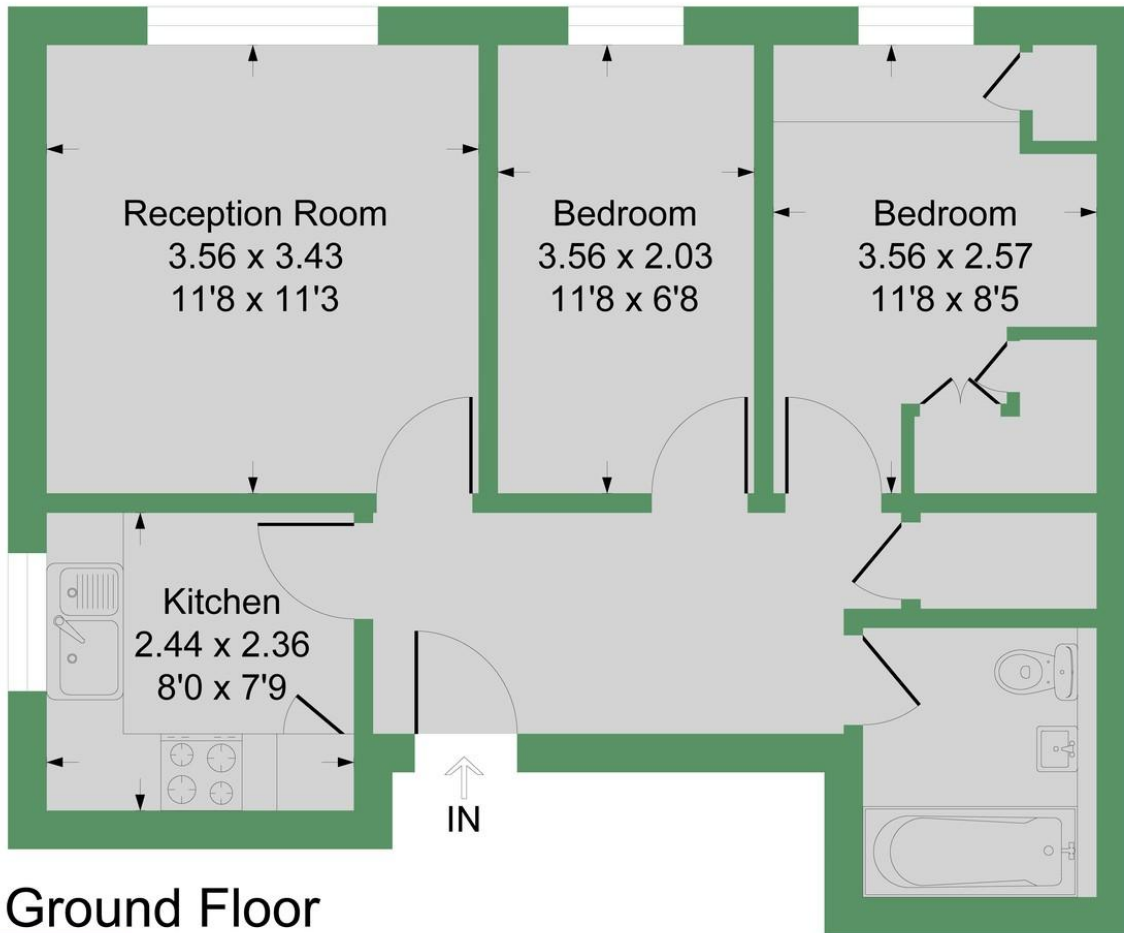

Ground Floor



Illustration for identification purposes only, measurements are approximate, not to scale.



Hillingdon office
11 Crescent Parade
Hillingdon
UB10 OLG

Uxbridge office
41 Belmont Road
Uxbridge
UB8 1QT

Hillingdon office 01895 231311
Uxbridge office 01895 707777
info@andrewsresidential.co.uk
www.andrewsresidential.co.uk

Agents Note: Whilst every care has been taken to prepare these sales particulars, they are for guidance purposes only. All measurements are approximate and for general guidance purposes only and whilst every care has been taken to ensure their accuracy, they should not be relied upon and potential buyers are advised to recheck the measurements. Andrews Residential is a trading name of Halcladix Limited, a limited company incorporated in England and Wales under registration number 10898495