



3 Railway Cottages Penstone, Colebrooke, EX17 5JW

Offers in Region of £175,000

HELMORES
SINCE 1699

3 Railway Cottages Penstone

Colebrooke, Crediton

- Period End Terrace Cottage
- Pretty Mid-Devon hamlet location
- Two bedrooms & two en-suites
- Lounge diner with fireplace
- Kitchen & lean-to
- Modern digital electric radiators
- Small courtyard with two brick-built stores
- No onward chain

Welcome to Westend Cottage, a delightful period end terrace cottage nestled in the picturesque Mid-Devon hamlet of Penstone, just 1 mile from the villages of Coleford (with its historic foody Inn) & Colebrooke. This charming home offers an ideal retreat in the heart of rural Devon.

Some rooms would benefit from some updating, giving scope to create a home in your own style. There are two bedrooms, both with storage and their own en-suite shower rooms.

The lounge diner is a focal point of the cottage, featuring a fireplace with wood-burning stove that creates a cosy ambiance.



HELMORES
SINCE 1699



The kitchen provides a functional space for preparing meals, while the lean-to offers additional storage and scope for a utility or breakfast area. Four modern digital electric radiators throughout the cottage provide efficient heating, plus the lounge, both bedrooms & en-suite 2 have uPVC double glazed windows.

Outside, a small enclosed courtyard awaits (approximately 2.7m x 2.7m), offering a private space with two brick-built stores provide valuable storage.

Westend Cottage is being also sold with benefit of no onward chain.

Please see the floorplan for room sizes.

Current Council Tax: B (£1,772pa)

Utilities: Mains electric, water, telephone & broadband

Broadband within this postcode: Superfast Enabled

Drainage: Mains drainage

Heating: Modern digital electric radiators

Listed: No

Tenure: Freehold



Penstone is a hamlet of just 21 houses in Devon, just 1 mile (2 km) from the villages of Colebrooke and Coleford with the historic New Inn. The nearest train stations are Yeoford and Copplestone. Penstone residents maintain the Penstone Glade, a community space for the hamlet adjacent to the River Yeo, and organise a variety of events there. Penstone is built on the south-facing slopes of the hills to the north of the river, with views to Colebrooke and Dartmoor in the distance.

DIRECTIONS: For Sat-Nav use EX17 5JW, as you pass under the railway bridge, park in the free parking area on your right & the cottage is along on your left.

What3Words: ///nitrogen.generated.muted



Ground Floor

Approx. 29.8 sq. metres (320.2 sq. feet)

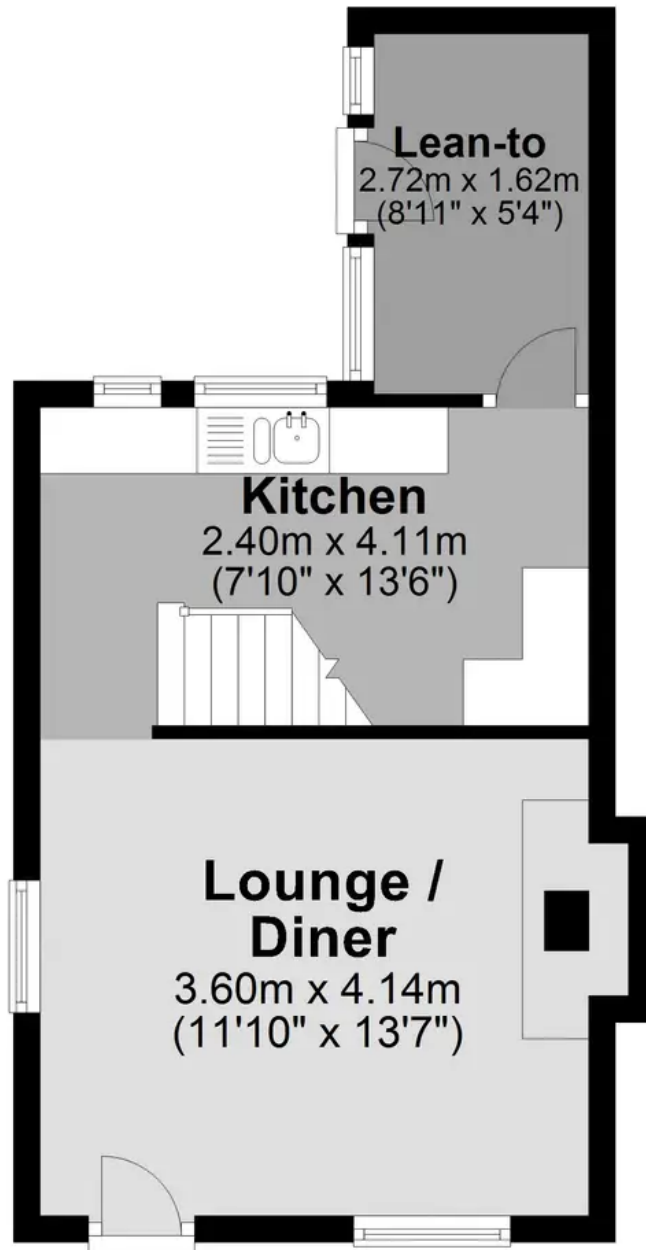

First Floor

Approx. 32.3 sq. metres (347.4 sq. feet)

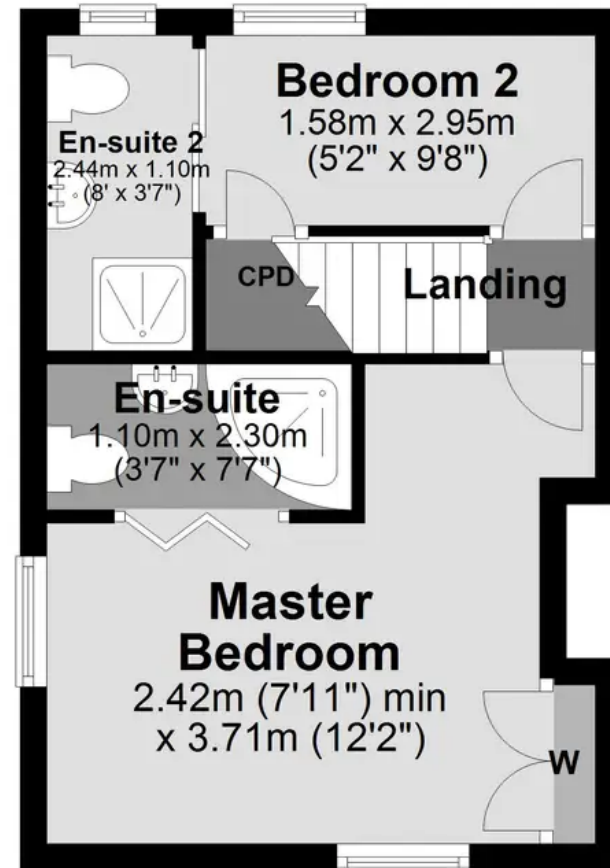

Total area: approx. 62.0 sq. metres (667.6 sq. feet)



Helmores

Helmores, 111-112 High Street - EX17 3LF

01363 777 999

property@helmores.com

helmores.com/

HELMORES
SINCE 1699

These particulars are intended to give a fair and reliable description of the property but no responsibility for any inaccuracy or error can be accepted and do not constitute an offer or contract. We have not tested any services or appliances (including central heating if fitted) referred to in these particulars and the purchasers are advised to satisfy themselves as to the working order and condition. If a property is unoccupied at any time there may be reconnection charges for any switched off/disconnected or drained services or appliances - All measurements are approximate.