











## 25 Stanley Road

### Knutsford

A beautiful period home in Knutsford's heart, with 2 bedrooms, 2 reception rooms, and upgraded kitchen. Charming features, modern conveniences, enclosed front garden, and rear courtyard. Close to town centre, shops, and transport. Ideal for stylish living.

Council Tax band: D

Tenure: Freehold

EPC Energy Efficiency Rating: C

EPC Environmental Impact Rating: D

- A beautifully presented period home in the town centre
- Recently upgraded kitchen and bathroom finished to a superb standard
- Two reception rooms with character and charm, plus a log burning stove
- Fully rewired in 2024
- Enclosed front garden plus a lovely rear courtyard garden, ideal for afternoon/evening sunshine
- Moments walk from the amenities of the town centre and The Heath
- No onward chain



GROUND FLOOR  
411 sq.ft. (38.2 sq.m.) approx.

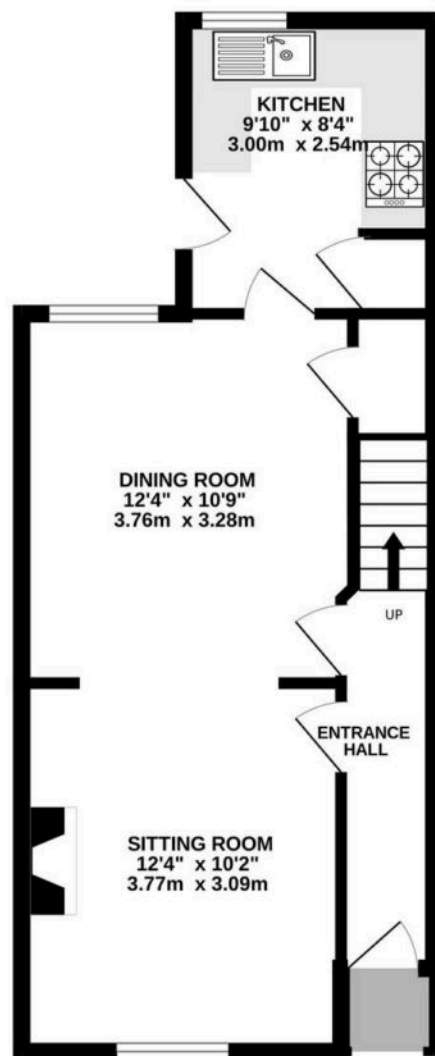

1ST FLOOR  
420 sq.ft. (39.1 sq.m.) approx.

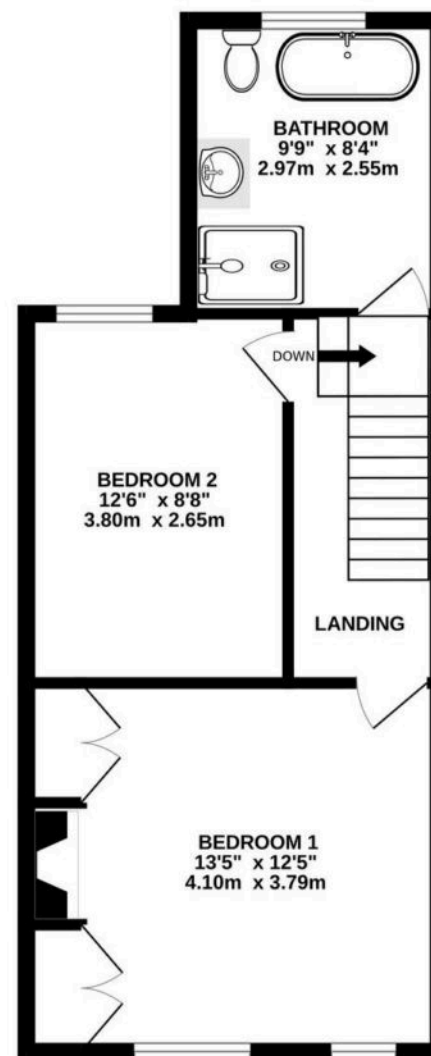

TOTAL FLOOR AREA : 832 sq.ft. (77.3 sq.m.) approx.

Whilst every attempt has been made to ensure the accuracy of the floorplan contained here, measurements of doors, windows, rooms and any other items are approximate and no responsibility is taken for any error, omission or mis-statement. This plan is for illustrative purposes only and should be used as such by any prospective purchaser. The services, systems and appliances shown have not been tested and no guarantee as to their operability or efficiency can be given.  
Made with Metropix ©2025





## Stuart Rushton & Company

Stuart Rushton & Co, 35 King Street – WA16 6DW

01565 757000

[enquiries@srushton.co.uk](mailto:enquiries@srushton.co.uk)

[www.srushton.co.uk](http://www.srushton.co.uk)



We are not authorised to make or give any representations or warranties in relation to the property either here or elsewhere. We assume no responsibility for any statement that may be made in these particulars, and they do not form part of any offer or contract and must not be relied upon as statements or representation of fact. Any areas, measurements or distances are approximate. The text, photographs and plans are for guidance only. Importantly, it should not be assumed that the property has all necessary planning, building regulations or other consents and we have not tested any services, equipment or facilities. Purchasers must satisfy themselves by inspection or otherwise.