

H. M. LAND REGISTRY

CHESHIRE SHEET XXVII 10 SECTION D

Scale 1/1250  
Enlarged from 1/2500

KNUTSFORD PARISH

THE BOUNDARIES SHOWN BY DOTTED  
LINES HAVE BEEN PLOTTED FROM THE  
PLANS ON THE LISTS AND ARE  
SUBJECT TO REVISION ON SURVEY.

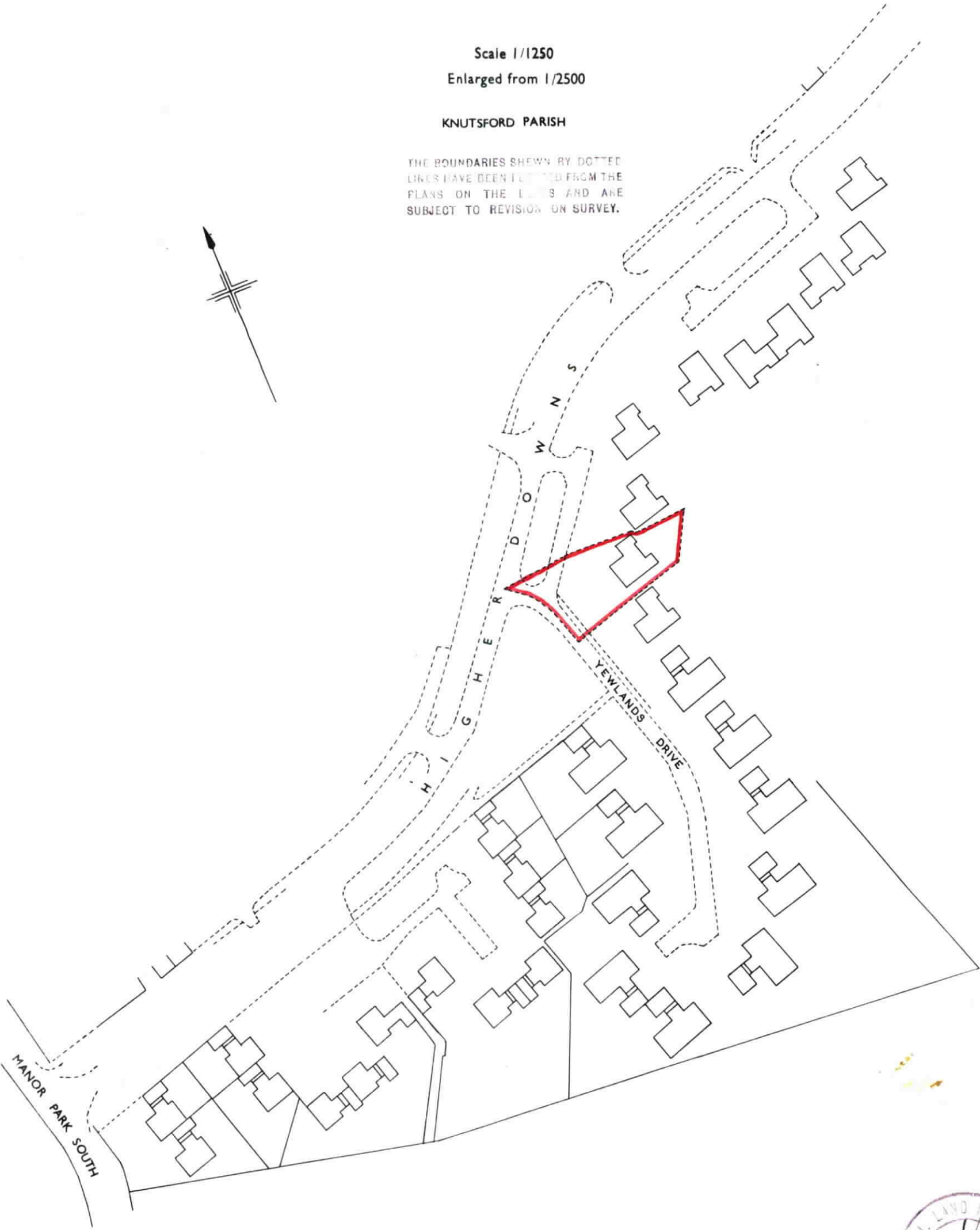

Made and printed by the Director  
General of the Ordnance Survey,  
Chessington, Surrey. 1967 for HMLR  
© Crown Copyright 1967



Filed Plan of Title No. **CH27128**

This is a print of the view of the title plan obtained from HM Land Registry showing the state of the title plan on 02 July 2024 at 15:48:44. This title plan shows the general position, not the exact line, of the boundaries. It may be subject to distortions in scale. Measurements scaled from this plan may not match measurements between the same points on the ground.

This title is dealt with by HM Land Registry, Birkenhead Office.

© Crown Copyright. Produced by HM Land Registry. Reproduction in whole or in part is prohibited without the prior written permission of Ordnance Survey. Licence Number 100026316.