



Bexton Lodge, Toft Road

Knutsford

An immaculate and handsome 5000 square foot detached period house of wonderful proportions, sitting within beautiful 0.6 acre South west facing landscaped gardens in the Legh Road conservation area, extended and beautifully refurbished throughout, within easy walking distance of the town centre.

Council Tax band: H

Tenure: Long Leasehold

EPC Energy Efficiency Rating: E

- A superb Victorian house with stunning contemporary extensions, in all over 5000 square feet
- Walking distance to the town centre, immaculate South westerly landscaped gardens of two thirds of an acre
- Five bedrooms, three bathrooms, six reception rooms
- Wonderful position within the Legh Road conservation area











BASEMENT
351 sq.ft. (32.6 sq.m.) approx.

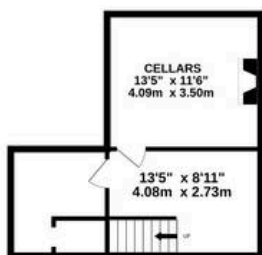

GROUND FLOOR
2702 sq.ft. (251.0 sq.m.) approx.

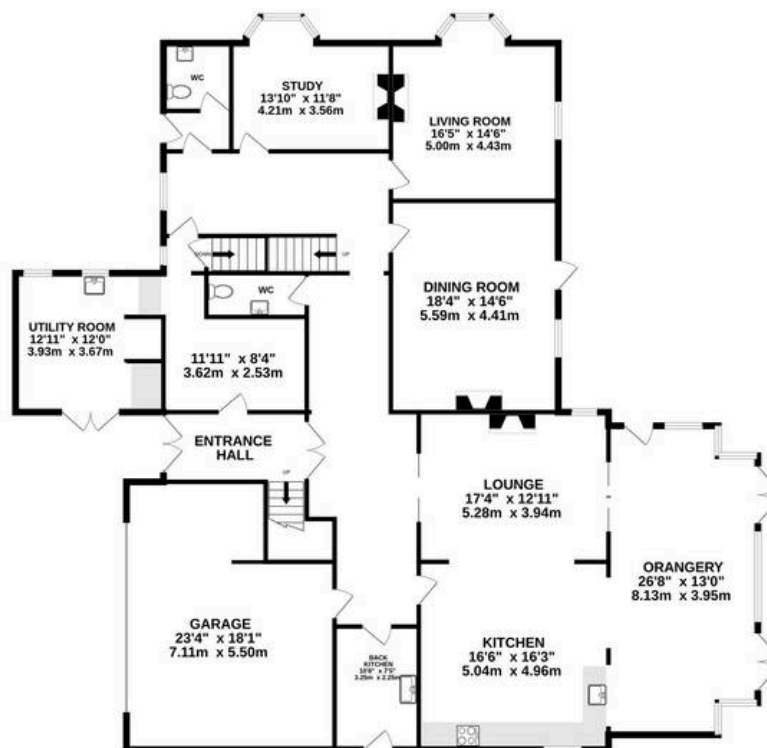

1ST FLOOR
2207 sq.ft. (205.0 sq.m.) approx.

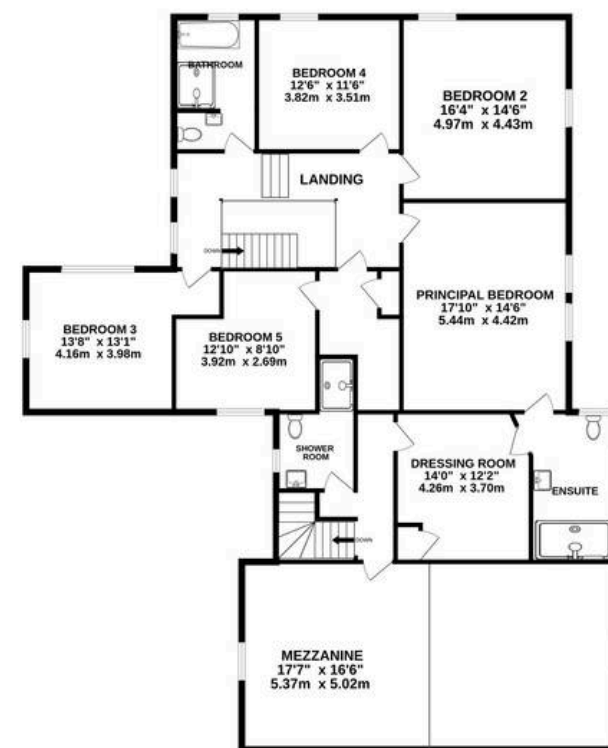

TOTAL FLOOR AREA : 5259 sq.ft. (488.6 sq.m.) approx.

Whilst every attempt has been made to ensure the accuracy of the floorplan contained here, measurements of doors, windows, rooms and any other items are approximate and no responsibility is taken for any error, omission or mis-statement. This plan is for illustrative purposes only and should be used as such by any prospective purchaser. The services, systems and appliances shown have not been tested and no guarantee as to their operability or efficiency can be given.

Made with Metropix ©2025



Stuart Rushton & Company

Stuart Rushton & Co, 35 King Street – WA16 6DW

01565 757000

enquiries@srushton.co.uk

www.srushton.co.uk



We are not authorised to make or give any representations or warranties in relation to the property either here or elsewhere. We assume no responsibility for any statement that may be made in these particulars, and they do not form part of any offer or contract and must not be relied upon as statements or representation of fact. Any areas, measurements or distances are approximate. The text, photographs and plans are for guidance only. Importantly, it should not be assumed that the property has all necessary planning, building regulations or other consents and we have not tested any services, equipment or facilities. Purchasers must satisfy themselves by inspection or otherwise.