



# 10 Victoria Street

Knutsford

An immaculate 3-bed townhouse in town centre with upgraded kitchen, spacious lounge/diner, 3 baths. Study, utility, garage, garden. Tranquil cul-de-sac near shops, park. Ideal modern living space in prime location.

Council Tax band: F

Tenure: Leasehold

EPC Energy Efficiency Rating: C

- A beautifully presented modern home in the heart of the town centre
- Three good bedrooms and three bathrooms
- Recently upgraded dining kitchen complimented by a lovely lounge
- Utility room and study/additional bedroom
- Driveway parking, integral garage and a pleasant rear garden
- Quiet cul-de-sac, just moments from Knutsford Heath and a few minutes from Tatton Park



GROUND FLOOR  
473 sq.ft. (44.0 sq.m.) approx.

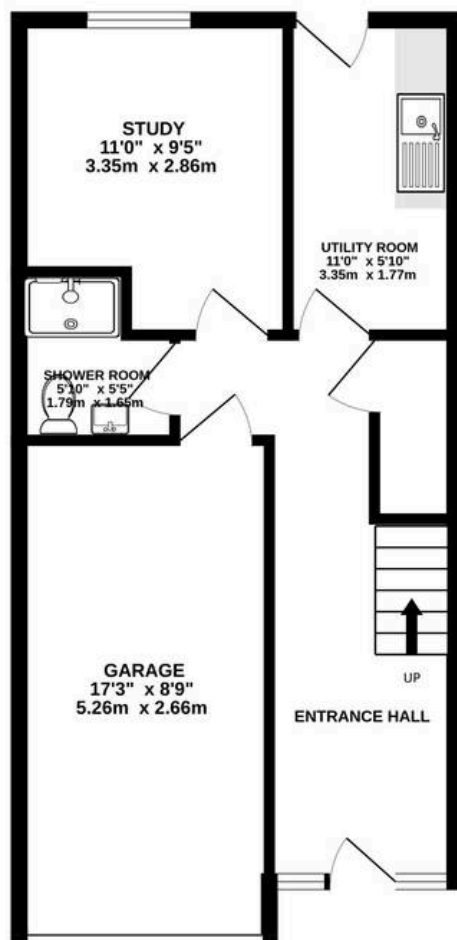

1ST FLOOR  
466 sq.ft. (43.3 sq.m.) approx.

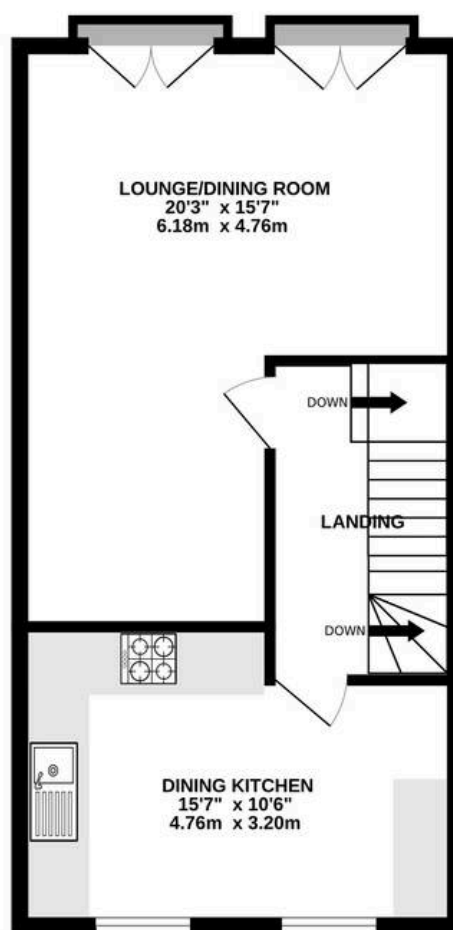

2ND FLOOR  
466 sq.ft. (43.3 sq.m.) approx.

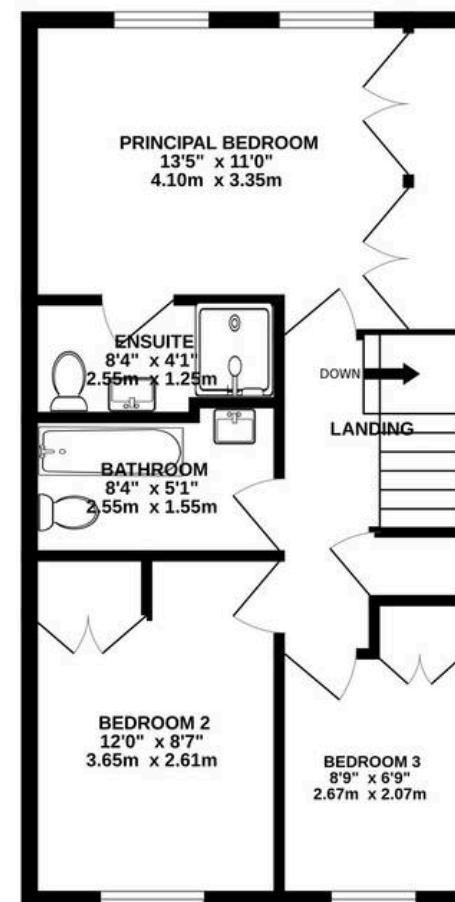

TOTAL FLOOR AREA : 1406 sq.ft. (130.6 sq.m.) approx.

Whilst every attempt has been made to ensure the accuracy of the floorplan contained here, measurements of doors, windows, rooms and any other items are approximate and no responsibility is taken for any error, omission or mis-statement. This plan is for illustrative purposes only and should be used as such by any prospective purchaser. The services, systems and appliances shown have not been tested and no guarantee as to their operability or efficiency can be given.

Made with Metropix ©2024





## Stuart Rushton & Company

Stuart Rushton & Co, 35 King Street – WA16 6DW

01565 757000

[enquiries@srushton.co.uk](mailto:enquiries@srushton.co.uk)

[www.srushton.co.uk](http://www.srushton.co.uk)



We are not authorised to make or give any representations or warranties in relation to the property either here or elsewhere. We assume no responsibility for any statement that may be made in these particulars, and they do not form part of any offer or contract and must not be relied upon as statements or representation of fact. Any areas, measurements or distances are approximate. The text, photographs and plans are for guidance only. Importantly, it should not be assumed that the property has all necessary planning, building regulations or other consents and we have not tested any services, equipment or facilities. Purchasers must satisfy themselves by inspection or otherwise.