



3 Oak Mews

Back Lane, Lower Peover, Knutsford

A beautifully presented 3-bed home in exclusive gated development. High-quality finishes, ensuite bathrooms, open-plan living space, landscaped garden with countryside views. Parking for 4 vehicles, near school, pubs, and motorway network. Don't miss this low-maintenance gem in sought-after village! No onward chain.

Council Tax band: F

Tenure: Freehold

EPC Energy Efficiency Rating: D

EPC Environmental Impact Rating: C

- Recently built to a superb standard with high-quality components and finishes
- Three spacious bedrooms and three stunning ensuite bathrooms
- Additional WC and utility room for convenient daily living
- A light and spacious living kitchen/diner with Neff appliances and bi-folding doors into the rear garden
- Gated development of just 4 properties within a wonderful Peover setting
- Driveway parking for upto 4 vehicles
- Far reaching views beyond the landscaped rear garden
- Lovely semi-rural setting just minutes from Lower Peover primary school, a selection of popular pubs and other amenities including the motorway network



1389 sq.ft. (129.0 sq.m.) approx.

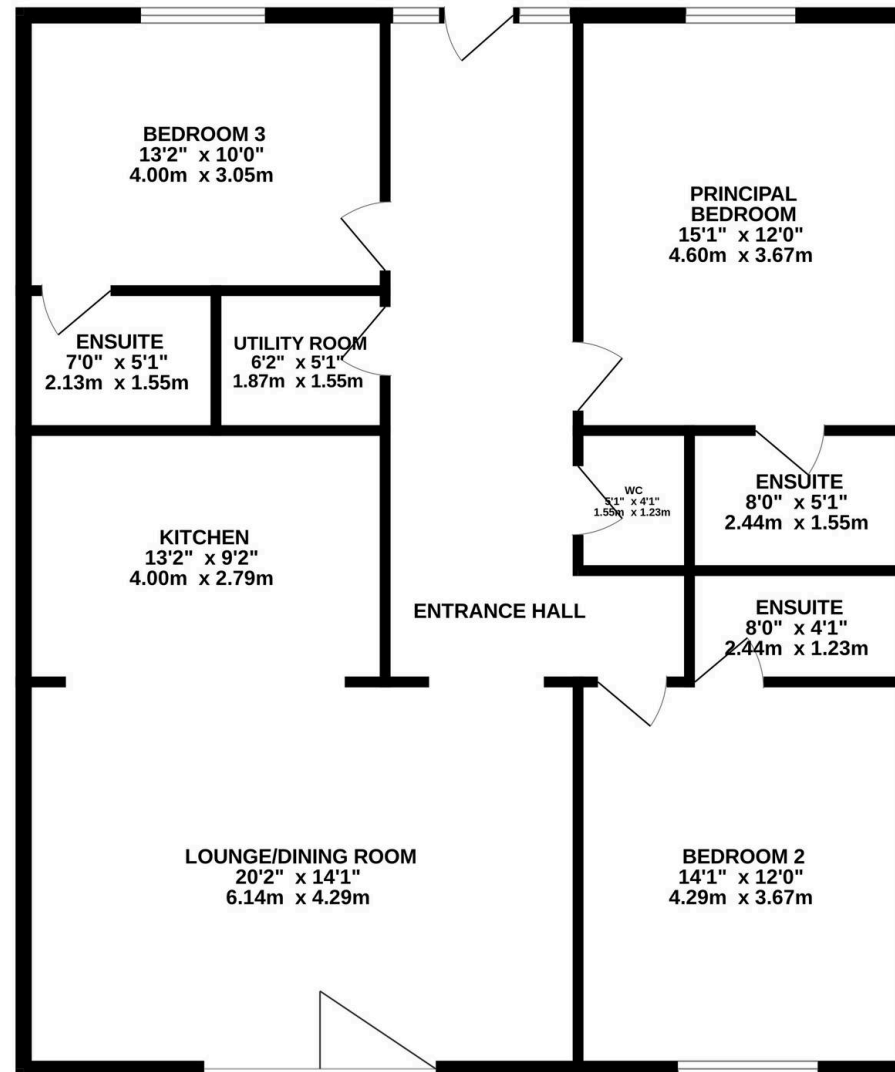

TOTAL FLOOR AREA: 1389 sq.ft. (129.0 sq.m.) approx.

Whilst every attempt has been made to ensure the accuracy of the floorplan contained here, measurements of doors, windows, rooms and any other items are approximate and no responsibility is taken for any error, omission or mis-statement. This plan is for illustrative purposes only and should be used as such by any prospective purchaser. The services, systems and appliances shown have not been tested and no guarantee as to their operability or efficiency can be given.
Made with Metropix ©2025



Stuart Rushton & Company

Stuart Rushton & Co, 35 King Street – WA16 6DW

01565 757000

enquiries@srushton.co.uk

www.srushton.co.uk



We are not authorised to make or give any representations or warranties in relation to the property either here or elsewhere. We assume no responsibility for any statement that may be made in these particulars, and they do not form part of any offer or contract and must not be relied upon as statements or representation of fact. Any areas, measurements or distances are approximate. The text, photographs and plans are for guidance only. Importantly, it should not be assumed that the property has all necessary planning, building regulations or other consents and we have not tested any services, equipment or facilities. Purchasers must satisfy themselves by inspection or otherwise.