



## Waterside Gate St. Peters Street, Maidstone

Guide Price £375,000 – £400,000





 Knight  
Edmonds



 Knight  
Edmonds



 Knight  
Edmonds



 Knight  
Edmonds



# Waterside Gate St. Peters Street

Maidstone

Stunning townhouse on the River Medway, close to Maidstone town centre. Private balcony, spacious kitchen/diner, utility area, and cloakroom on ground floor. Living room with river views, upgraded wood flooring. Three bedrooms with en-suite bathrooms. Cosy outside space overlooking river, private mooring, and garden. Two allocated parking spaces. Close to amenities. A truly special home in the heart of Maidstone. Arrange a viewing today!

Council Tax band: E

Tenure: Freehold

EPC Energy Efficiency Rating: C

EPC Environmental Impact Rating: C

- Three Double Bedrooms with Ensuites
- Lounge with Balcony
- Fitness Centre, Rowing Club & Maidstone United Football Club Next to Waterside Gate
- River Front Property
- Sought After Location





GROUND FLOOR  
429 sq.ft. (39.8 sq.m.) approx.

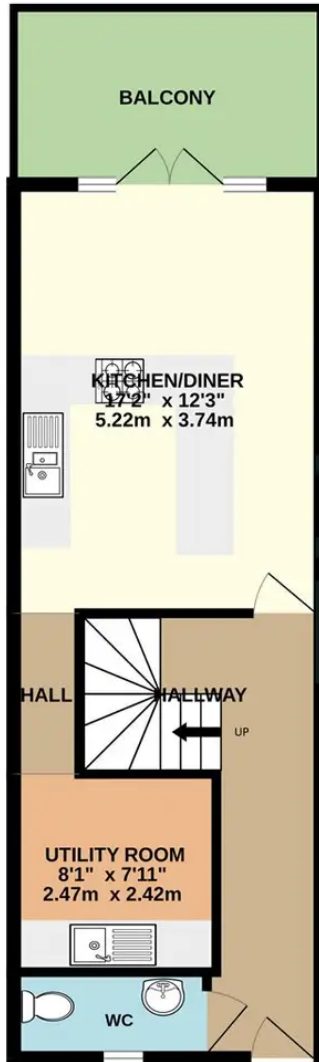

1ST FLOOR  
428 sq.ft. (39.8 sq.m.) approx.

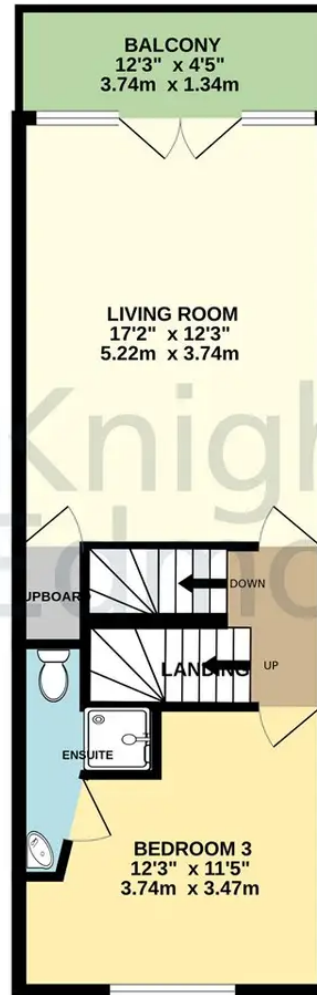

2ND FLOOR  
429 sq.ft. (39.8 sq.m.) approx.



Scan to  
view  
online!



Scan to  
book a  
viewing!



TOTAL FLOOR AREA: 1286 sq.ft. (119.4 sq.m.) approx.

Whilst every attempt has been made to ensure the accuracy of the floorplan contained here, measurements of doors, windows, rooms and any other items are approximate and no responsibility is taken for any error, omission or mis-statement. This plan is for illustrative purposes only and should be used as such by any prospective purchaser. The services, systems and appliances shown have not been tested and no guarantee as to their operability or efficiency can be given.

Made with Metropix ©2023

