



**Pacey
Wingent
Dickson.**

INDEPENDENT PROPERTY AGENTS

*Helping the perfect property find you...
...time is precious. Let's not waste it!*

York Road, Guildford, GU1

£1,375PCM (Deposit: £1,586)

🛏 1 🪑 1 🚗 1

- Ground floor one bedroom masionette
- Private entrance
- Communal outside space
- Close to Guildford town centre, shops and restaurants
- Period conversion
- Seperate Kitchen
- Moments from London Road train station
- Easy access to A3, A31, M25



Tax Band: C Furnished: Furnished

A fantastic ground floor maisonette moments from Guildford High Street and London Road Train Station. Set within a charming period conversion, the property offers a well-proportioned layout with a separate bedroom, living room, and kitchen. Residents can also enjoy a communal outdoor area, while the prime location places you within easy reach of local shops, restaurants, and excellent transport connections.



York Road, Guildford, GU1 4DG
 Approximate Gross Internal Area = 38.7 sq m / 416 sq ft

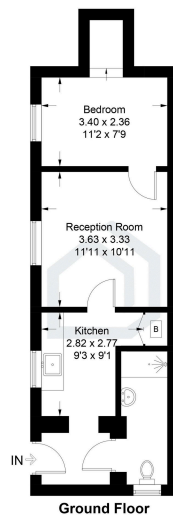
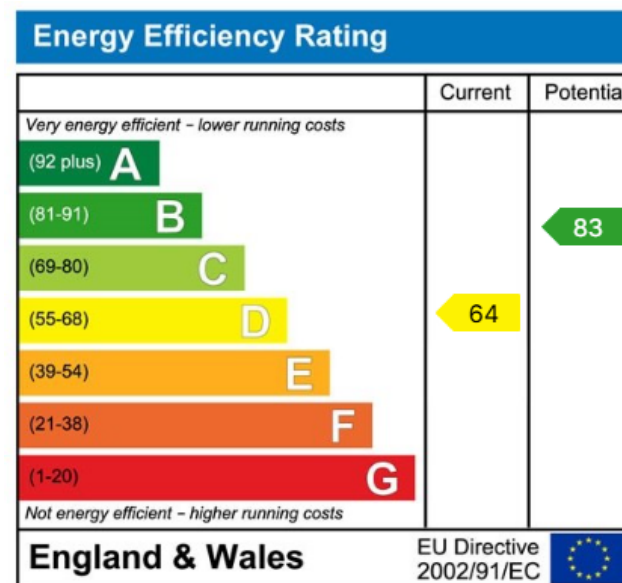

Illustration for identification purposes only, measurements are approximate, not to scale. Floorplan © (D1187859)



If your property is on the market with another agent, please check your terms of business to avoid paying two commissions. PACEY WINGENT DICKSON PROPERTY PARTNERSHIP LTD. Registered Office, Station House, Station Approach, East Horsley, KT24 6QX. Registration No. 15446136 (England).



*Helping the perfect property find you...
 ...time is precious. Let's not waste it!*