



**Pacey
Wingent
Dickson.**

INDEPENDENT PROPERTY AGENTS

*Helping the perfect property find you...
...time is precious. Let's not waste it!*

Ladymead, Guildford, Surrey, GU1 1FP

£1,600PCM (Deposit: £1,846)

 1  1  1

- Large One Bedroom Apartment
- Access to Cycle Storage Shelter
- Allocated Gated Parking
- Dual-aspect Reception Room Flooded with Natural Light
- Easy access to A3,A31,M25
- Furnished
- High Ceilings
- Secure entrance
- Smart Bathroom with Heated Towel Rail
- Open-plan Kitchen with Quartz Carrara Stone Worktops and Smeg Appliances



Tax Band: Furnished: Furnished

Located in the striking Liongate House development, this modern one-bedroom apartment offers stylish living with high ceilings, chic interiors, and quality finishes throughout. Just minutes from Guildford Town Centre, it provides excellent access to the A3, train station, University of Surrey, and local amenities.

The apartment features a spacious open-plan kitchen and living area with integrated Smeg appliances, a generously sized bedroom, and a sleek, modern bathroom. Additional benefits include gated undercroft parking, secure cycle storage, and a video entry system.

With Stoke Park, Guildford Spectrum, and the town's shops and cafes nearby, plus Heathrow and Gatwick within easy reach, this well-presented apartment is ideal for professionals, commuters, or students seeking comfort and convenience.

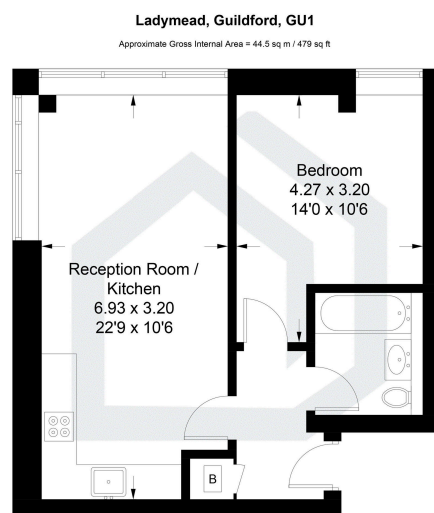

Raised Ground Floor

Illustration for identification purposes only, measurements are approximate, not to scale. Fourtala.co © (017209472)

